

RECEIVED  
JUL 20 1953  
STATE ENGINEER  
SALEM, OREGON

Registration No. GR - 1489

Certificate No. GR - 1437

# Registration Statement

OF CLAIMANT OF RIGHT TO APPROPRIATE GROUND WATER

TO THE STATE ENGINEER OF OREGON:

I, P. R. and Caroline Miller  
of 2635 Tualatin Valley Hwy County of Washington  
(Mailing address)  
State of Oregon, do hereby make application for a certificate of registration as evidence of a right to appropriate ground water.

1. Source from which water is withdrawn is Pump Well  
(Flowing well, pump well, infiltration trench, or tunnel)

2. Location is: one mile west of Red Hill  
(Approximate distance and direction from nearest city or town)

and is more particularly described as follows: 200 feet west & 150 feet north from center of Section 10

(a) E 1/4 of S 1/4 of T 1 S 10 R 1 E  
(Give distance and bearing to corner of section or other legal subdivision)

being within SE 1/4 of NW 1/4 of Sec. 10 Twp. 1 S Rge. 2 East 11  
(Smallest legal subdivision) (N. or S.) (E. or W.)

or (b) within limits of recorded platted property, town or city:

in Lot \_\_\_\_\_, Block \_\_\_\_\_ of \_\_\_\_\_  
(Name of plat or addition)

County of \_\_\_\_\_  
(If within city or town, give name)

3. Construction Work was begun on June 2, 1952; was completed on July 6, 1952  
(Date) (Date)

and the ground water claimed was first used for the purposes set out below on July 6, 1952  
(Date)

since which time the water has been used Continuously  
(Continuously or intermittently)

from June to Sept. 1952  
(Date) (Date)

4. Quantity of water claimed and used is 20 g.p.m. gallons per minute; 50 acre feet per year.

5. Purpose or Purposes for which water is used Irrigation

(Domestic, irrigation, municipal, manufacturing, industrial, etc.)

6. Description of Well: Depth \_\_\_\_\_ feet. Type 18 in  
(Dug or drilled)

diameter 3 1/2 inches. Elevation of ground at well site 200 feet, mean sea level.  
(As near as known)

Depth to water table 29 feet.

7. Capacity of Well: 16 g.p.m. with 13 feet drawdown.

24 g.p.m. with 20 feet drawdown.

Date of test July 1953

If Flowing Well: Measured discharge \_\_\_\_\_ g.p.m. on \_\_\_\_\_  
(Date)

Shut-in pressure at ground surface \_\_\_\_\_ lbs. per sq. in. on \_\_\_\_\_  
(Date)

Water is controlled by \_\_\_\_\_  
(Cap, valve, etc.)

8. Casing: (Give diameter, commercial specifications and depth below ground surface of each casing size.)

36 inch diameter from 0 to 30 feet  
 inch diameter from to feet  
 inch diameter from to feet  
 inch diameter from to feet

Describe and show depth of shoe, plug, adapter, liner or other details: *None*

9. Perforated Casings or Screens:

(Number per foot and size of perforations, or describe screen) from to  
 from to  
 from to  
 from to

10. Log of Well: (Describe each stratum or formation clearly, indicate if water bearing, and give thickness and depth as indicated.)

MATERIAL	Thickness (Feet)	Depth to Bottom (Feet)

If log of well is not available, give name and address of driller. A. J. Leopold

26226 N W Bayview Hillsboro, Oregon

11. Infiltration Trench: Covered or open None

Dimensions: Length ..... ft. Minimum depth ..... ft. Maximum depth ..... ft.

Bottom width ..... ft. Discharge ..... g.p.m. Date of test .....

12. Tunnel: Type of lining None

Dimensions: .....  
(Length, course, and cross sectional size)

Position of water bearing stratum with reference to portal of tunnel .....

Log of tunnel: (Preceding table for log of well may be used, if desired. Give footage from portal and character of materials, as pertinent.)

13. Pumping Equipment:

(a) Pump Down and Jet 2HP 2 in Capacity 60 g.p.m.  
(Make, type and size)

(b) Motor Electric 2HP  
(Type and horsepower)

14. Location of area irrigated or to be irrigated, or place of use if for purposes other than irrigation.

Township North or South	Range E. or W. of Willamette Meridian	Section	Forty-acre Tract	Number Acres To Be Irrigated	Date of Reclamation
1 N	2 W	10	SE 1/4 NW 1/4	10	July 1952

15. If the ground water supply is supplemental to an existing water supply, identification of any application for a permit, permit, certificate or adjudicated right to appropriate water made or held by the registrant.

SECTION 10

Township 15 Range 2 W, W.M.  
North

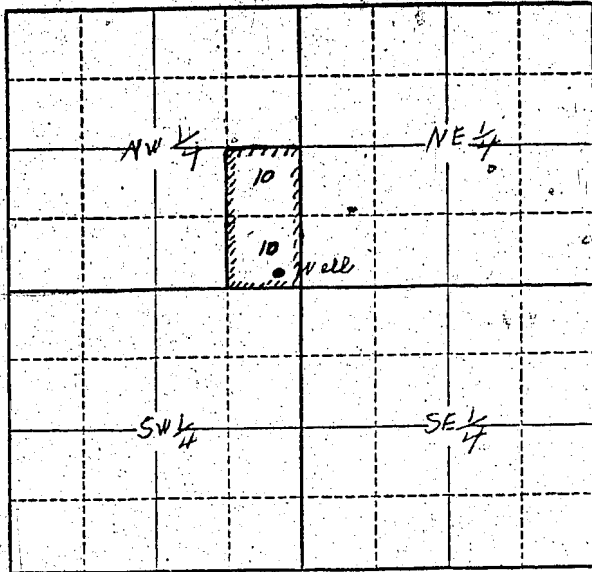

Locate well and acreage of irrigated land on plat.

Scale: 1" = 1 Mile  
1/4" = 1 Mile

STATE OF OREGON

County of Washington } ss.

I, Coraline Winkle, being first duly sworn, do hereby certify that I have read the foregoing Registration Statement and that all of the items therein contained are true to the best of my knowledge and belief.

(Signature of Registrant)

Subscribed and sworn to before me this 21st day of April, 1958

My commission expires 4-10-61

(Notary Public)

(SEAL)

CERTIFICATE OF REGISTRATION

STATE OF OREGON } ss.  
County of Marion

This is to certify that the foregoing Registration Statement was received in the office of the State Engineer on the 23rd day of April, 1958, at 9:00 o'clock A.M. and has been duly recorded in said office in Book No. 7 of Registration Statements on page GR-1437

Witness my hand this 1st day of December, 1958

Laura A. Stanley  
(State Engineer)

By \_\_\_\_\_ (Deputy)

GR - 1437