

# Registration Statement

GR-1496

GR-1446

## OF CLAIMANT OF RIGHT TO APPROPRIATE GROUND WATER

(Under Chapter 708, Oregon Laws 1955.)

### TO THE STATE ENGINEER OF OREGON:

I, loyd L. Lind  
of Salem, Oregon Rt. 1, Berge County of Yamhill  
State of Oregon, do hereby make application for a certificate of registration as evidence of a right to appropriate ground water.

1. Source from which water is withdrawn is pump well # 2  
(Flowing well, pump well, infiltration trench, or tunnel)

2. Location is: 10 mi. N. of West Salem, Oregon  
(Approximate distance and direction from nearest city or town)

and is more particularly described as follows: From SW corner Wm. Miller D.F.C. 59, well is N89°25'E-25.68 ch.

(a) thence N19°E-2600' chains thence East 55835 ch.  
(Give distance and bearing to corner of section or other legal subdivision)

being within NE 1/4 NE 1/4 Section 5 of Sec. 5, Twp. 6S, Rge. 3W  
(Smallest legal subdivision) (N. or S.) (E. or W.)

or (b) within limits of recorded platted property, town or city:

in Lot \_\_\_\_\_, Block \_\_\_\_\_ of \_\_\_\_\_  
(Name of plat or addition)

County of \_\_\_\_\_  
(If within city or town, give name)

Well No. 2 3. Construction Work was begun on April 1954; was completed on June 1954  
(Date) (Date)

and the ground water claimed was first used for the purposes set out below on June 1954  
(Date)

since which time the water has been used continuously  
(Continuously or intermittently)

from May 1 to Sept. 30  
(Date) (Date)

4. Quantity of water claimed and used is 360 gallons per minute; 38 acre feet per year.

5. Purpose or Purposes for which water is used Semesterly Irrigation

(Domestic, irrigation, municipal, manufacturing, industrial, etc.)

6. Description of Well: Depth 104 feet. Type Drilled  
(Dug or drilled)

diameter 10 inches. Elevation of ground at well site 170 feet, mean sea level.  
(As near as known)

Depth to water table 12 feet.

7. Capacity of Well: 360 g.p.m. with 27 feet drawdown.

\_\_\_\_\_ g.p.m. with \_\_\_\_\_ feet drawdown.

Date of test June 1954

If Flowing Well: Measured discharge \_\_\_\_\_ g.p.m. on \_\_\_\_\_  
(Date)

Shut-in pressure at ground surface \_\_\_\_\_ lbs. per sq. in. on \_\_\_\_\_  
(Date)

Water is controlled by \_\_\_\_\_  
(Cap, valve, etc.)





R. 3 W.

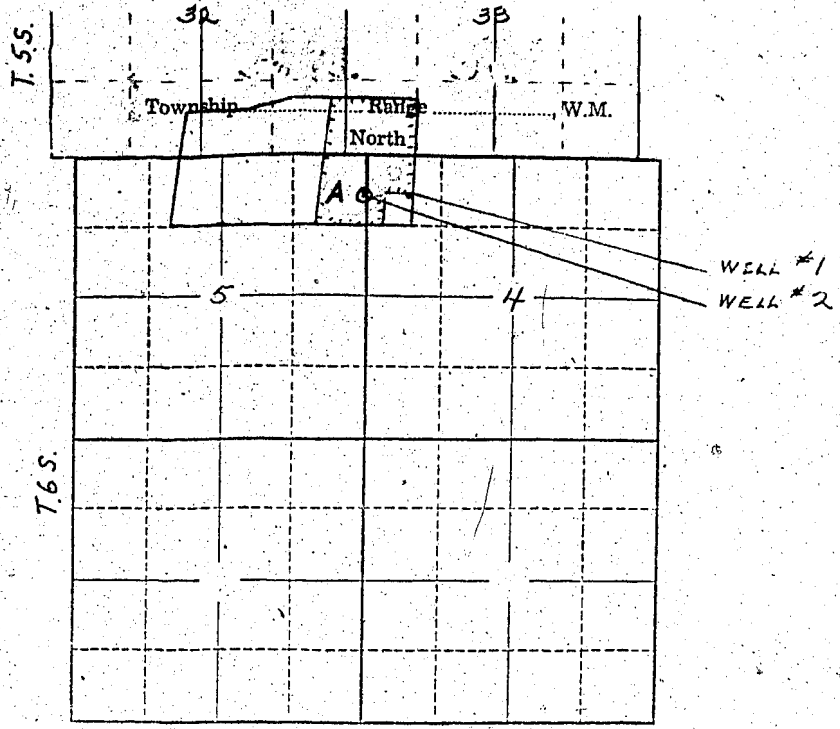

Locate well and acreage of irrigated land on plat.

Scale: 2" = 1 Mile

STATE OF OREGON

County of \_\_\_\_\_ } ss.

I, \_\_\_\_\_, being first duly sworn, do hereby certify that I have read the foregoing Registration Statement and that all of the items therein contained are true to the best of my knowledge and belief.

*Lloyd L. Lind*  
(Signature of Registrant)

Subscribed and ~~sworn~~ <sup>affirmed</sup> to before me this 24 day of April, 1958.

My commission expires September 8, 1960.  
*Max E. Rogers*  
(Notary Public)

(SEAL)

CERTIFICATE OF REGISTRATION

STATE OF OREGON

County of Marion } ss.

This is to certify that the foregoing Registration Statement was received in the office of the State Engineer on the 24th day of April, 1958, at 8:00 o'clock A. M. and has been duly recorded in said office in Book No. 7 of Registration Statements on page GR-1446

~~Construction shall be completed by \_\_\_\_\_ and the water completely applied to beneficial use by \_\_\_\_\_~~

Witness my hand this \_\_\_\_\_ 1st day of \_\_\_\_\_ December, 1958.

*Stuart A. Stanley*  
(State Engineer)

By \_\_\_\_\_  
(Deputy)

GR-1446