

RECEIVED  
APR 24 1958  
STATE ENGINEER  
SALEM, OREGON

Registration No. GR - 1498

Certificate No. GR - 1448

# Registration Statement

## OF CLAIMANT OF RIGHT TO APPROPRIATE GROUND WATER

TO THE STATE ENGINEER OF OREGON:

I, ALVIN V. EDWARDS  
of MILTON-FREEWATER County of UMA  
(Mailing address)

State of OREGON, do hereby make application for a certificate of registration as evidence of a right to appropriate ground water.

- Source from which water is withdrawn is PUMP WELL  
(Flowing well, pump well, infiltration trench, or tunnel)
- Location is: 5 MILES N-W MILTON-FREEWATER  
(Approximate distance and direction from nearest city or town)

and is more particularly described as follows:

(a) 675 feet west + 1284 South of  
N-E CORNER OF SECTION 29  
(Give distance and bearing to corner of section or other legal subdivision)  
being within NE 4 of NE 4 of Sec. 29, Twp. 6 N, Rge. 35 E  
(Smallest legal subdivision) (N. or S.) (E. or W.)

or (b) within limits of recorded platted property, town or city:

in Lot \_\_\_\_\_, Block \_\_\_\_\_ of \_\_\_\_\_  
(Name of plat or addition)

County of \_\_\_\_\_  
(If within city or town, give name)

- Construction Work was begun on 1921; was completed on 1921  
(Date) (Date)

and the ground water claimed was first used for the purposes set out below on \_\_\_\_\_  
(Date)

since which time the water has been used CONTINUOUSLY  
(Continuously or intermittently)

from APRIL 1921 to 1958 to SEPT. 1921 to 1958  
(Date) (Date)

- Quantity of water claimed and used is 150 gallons per minute; 20 acre feet per year.

- Purpose or Purposes for which water is used \_\_\_\_\_

IRRIGATION

(Domestic, irrigation, municipal, manufacturing, industrial, etc.)

- Description of Well: Depth 30 feet. Type DUG  
(Dug or drilled)

diameter 6.6 inches. Elevation of ground at well site 700 feet, mean sea level.  
(As near as known)

Depth to water table 18 feet.  
(No record)

- Capacity of Well: \_\_\_\_\_ g.p.m. with \_\_\_\_\_ feet drawdown.

\_\_\_\_\_ g.p.m. with \_\_\_\_\_ feet drawdown.

Date of test \_\_\_\_\_

If Flowing Well: Measured discharge \_\_\_\_\_ g.p.m. on \_\_\_\_\_  
(Date)

Shut-in pressure at ground surface \_\_\_\_\_ lbs. per sq. in. on \_\_\_\_\_  
(Date)

Water is controlled by \_\_\_\_\_  
(Cap, valve, etc.)





Township 6 N Range 35 E W.M.  
North

N-E CORNER  
OF SECTION 29

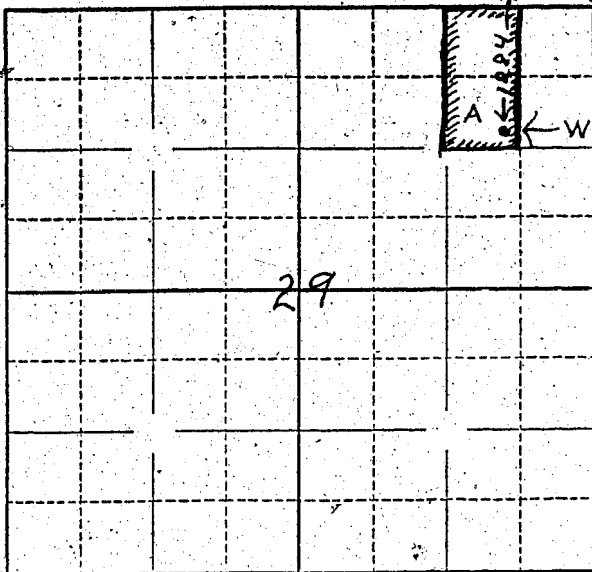

Locate well and acreage of irrigated land on plat.

Scale: 2" = 1 Mile  
4" = 1 MILES

STATE OF OREGON

County of U. MATILLA } ss.

I, Alvin Edwards, being first duly sworn, do hereby certify that I have read the foregoing Registration Statement and that all of the items therein contained are true to the best of my knowledge and belief.

Alvin Edwards  
(Signature of Registrant)

Subscribed and sworn to before me this 17 day of April, 1958.

My commission expires Aug. 19, 1959

[Signature]  
(Notary Public)

(SEAL)

### CERTIFICATE OF REGISTRATION

STATE OF OREGON } ss.  
County of Marion

This is to certify that the foregoing Registration Statement was received in office of the State Engineer on the 27th day of April, 1958, at 1:00 o'clock P.M. and has been duly recorded in said office in Book No. 7 of Registration Statements on page GR-1448

Witness my hand this 1st day of December, 1958

[Signature]  
(State Engineer)

By \_\_\_\_\_  
(Deputy)

GR - 1448