

RECEIVED
APR 27 1958
STATE ENGINEER
SALES, OREGON

Registration No. GR-1499

Certificate No. GR-1449

Registration Statement

OF CLAIMANT OF RIGHT TO APPROPRIATE GROUND WATER

TO THE STATE ENGINEER OF OREGON:

I, Carl Hasler

of Route 2, Box 204, Central Point, County of Jackson
(Mailing address)

State of Oregon, do hereby make application for a certificate of registration as evidence of a right to appropriate ground water.

1. Source from which water is withdrawn is pump well (see remarks under item 11)
(Flowing well, pump well, infiltration trench, or tunnel)

2. Location is: 6 miles North of Medford, Oregon
(Approximate distance and direction from nearest city or town)

and is more particularly described as follows:

(a) 2110 feet south and 281 feet west from N¹ corner Section 25
(Give distance and bearing to corner of section or other legal subdivision)
being within SE¹ SE¹ NW¹ of Sec. 25, Twp. 36 S., Rge. 2 W.
(Smallest legal subdivision) (N. or S.) (E. or W.)

or (b) within limits of recorded platted property, town or city:

in Lot _____, Block _____ of _____
(Name of plat or addition)
County of _____
(If within city or town, give name)

3. Construction Work was begun on 1953; was completed on 1954
(Date) (Date)

and the ground water claimed was first used for the purposes set out below on 1953
(Date)

since which time the water has been used continuously
(Continuously or Intermittently)

from 1953 to October 1957
(Date) (Date)

4. Quantity of water claimed and used is 70 gallons per minute; 32 acre feet per year.

5. Purpose or Purposes for which water is used irrigation

(Domestic, irrigation, municipal, manufacturing, industrial, etc.)

6. Description of Well: Depth 180 feet. Type drilled
(Dug or drilled)

diameter 8.0 inches. Elevation of ground at well site 1255 feet, mean sea level.
(As near as known)

Depth to water table 10 feet.

7. Capacity of Well: 100 g.p.m. with 50 feet drawdown.

_____ g.p.m. with _____ feet drawdown.

Date of test none - noted from use.

If Flowing Well: Measured discharge _____ g.p.m. on _____
(Date)

Shut-in pressure at ground surface _____ lbs. per sq. in. on _____
(Date)

Water is controlled by _____
(Cap, valve, etc.)

8. Casing: (Give diameter, commercial specifications and depth below ground surface of each casing size.)

8.0 inch diameter steel casing from 0 to 40 feet
 8.0 inch diameter none from 40 to 100 feet
 6.0 inch diameter none from 100 to 180 feet
 inch diameter from to feet

Describe and show depth of shoe, plug, adapter, liner or other details:

.....

.....

9. Perforated Casings or Screens:

2 perforations per foot being $\frac{1}{4}$ " x $2\frac{1}{2}$ " slots from 20 to 40
(Number per foot and size of perforations, or describe screen)
 from to
 from to
 from to

10. Log of Well: (Describe each stratum or formation clearly, indicate if water bearing, and give thickness and depth as indicated.)

MATERIAL	Thickness (Feet)	Depth to Bottom (Feet)
black clay	4	176
cement gravel	6	170
yellow clay	8	162
dark gray clay (water bearing at 30 & 75 feet)	162	0

If log of well is not available, give name and address of driller. Crater Well Drilling -
3061 Crater Lake Avenue, Medford, Oregon.

11. Infiltration Trench: Covered or open
 Dimensions: Length ft. Minimum depth ft. Maximum depth ft.

Bottom width ft. Discharge g.p.m. Date of test

12. Tunnel: Type of lining

Dimensions:
(Length, course, and cross sectional size)

Position of water bearing stratum with reference to portal of tunnel

Log of tunnel: (Preceding table for log of well may be used, if desired. Give footage from portal and character of materials, as pertinent.)

13. Pumping Equipment:

(a) Pump 2.0 inch turbine pump (Fairbanks) Capacity 100 g.p.m.
(Make, type and size)

(b) Motor 5.0 H.P. electric motor
(Type and horsepower)

14. Location of area irrigated or to be irrigated, or place of use if for purposes other than irrigation.

Township North or South	Range E. or W. of Willamette Meridian	Section	Forty-acre Tract	Number Acres To Be Irrigated	Date of Reclamation
36 S.	2 W.	25	N $\frac{1}{2}$ S $\frac{1}{2}$ SE $\frac{1}{4}$ NW $\frac{1}{4}$	7.0 acres	1953
Remarks	I have constructed a storage sump 40 feet long on top - 20 feet wide and 16 feet deep to store water from the pump well when not in use.				

15. If the ground water supply is supplemental to an existing water supply, identification of any application for a permit, permit, certificate or adjudicated right to appropriate water made or held by the registrant.
 none

Township 36 S. Range 2 W., W.M.
North

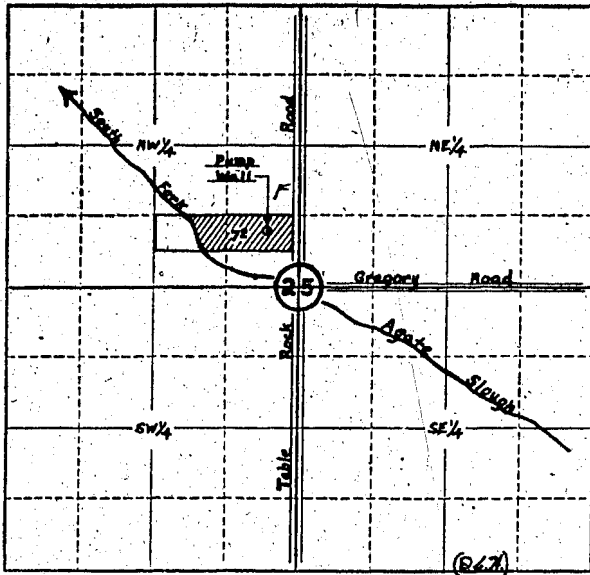

Locate well and acreage of irrigated land on plat.
Scale: 4" = 1 Mile

STATE OF OREGON

County of Jackson } ss.

I, Carl Hasler, being first duly sworn, do hereby certify that I have read the foregoing Registration Statement and that all of the items therein contained are true to the best of my knowledge and belief.

Carl Hasler
(Signature of Registrant)

Subscribed and sworn to before me this 23rd day of April, 19 58

My commission expires August 25, 1958

[Signature]
(Notary Public)

(SEAL)

CERTIFICATE OF REGISTRATION

STATE OF OREGON } ss.
County of Marion

This is to certify that the foregoing Registration Statement was received in the office of the State Engineer on the 23rd day of April, 1958, at 1:00 o'clock P. M. and has been duly recorded in said office in Book No. 7 of Registration Statements on page GR-1449

Witness my hand this 1st day of December, 1958

Lewis A. Starnes
(State Engineer)

By _____
(Deputy)