

Registration Statement

OF CLAIMANT OF RIGHT TO APPROPRIATE GROUND WATER

#1

TO THE STATE ENGINEER OF OREGON:

I, E. Clemens Horst Co.

of R.R. #1, Independence, Oregon County of Polk

State of Oregon, do hereby make application for a certificate of registration as evidence of a right to appropriate ground water.

1. Source from which water is withdrawn is Pump Well
(Flowing well, pump well, infiltration trench, or tunnel)

2. Location is: 1 Miles, N.E., Independence, Oregon
(Approximate distance and direction from nearest city or town)

and is more particularly described as follows:

(a) S 19° E - 4170 ft. From N.W. Corner Sec. 11
(Give distance and bearing to corner of section or other legal subdivision)

being within NE 1/4 of SW 1/4 of Sec. 11, Twp. 25, Rge. 4 W
(Smallest legal subdivision) (N. or S.) (E. or W.)

or (b) within limits of recorded platted property, town or city:

in Lot _____ Block _____ of _____
(Name of plat or addition)

County of _____
(If within city or town, give name)

3. Construction Work was begun on July 15, 1943, was completed on July 18, 1943
(Date) (Date)

and the ground water claimed was first used for the purposes set out below on July 20, 1943
(Date)

since which time the water has been used Continuously intermittently
(Continuously or intermittently)

from June 1943 to Sept. 1957
(Date) (Date)

4. Quantity of water claimed and used is 400 gallons per minute; 125.3 acre feet per year.

5. Purpose or Purposes for which water is used Irrigation

(Domestic, irrigation, municipal, manufacturing, industrial, etc.)

6. Description of Well: Depth 40 feet. Type Drilled
(Dug or drilled)

diameter 10 inches. Elevation of ground at well site _____ feet, mean sea level.
(As near as known)

Depth to water table 20 feet.

7. Capacity of Well: 400 g.p.m. with 8' feet drawdown

_____ g.p.m. with _____ feet drawdown.

Date of test None

If Flowing Well: Measured discharge _____ g.p.m. on _____
(Date)

Shut-in pressure at ground surface _____ lbs. per sq. in. on _____
(Date)

Water is controlled by _____
(Cap, valve, etc.)

8. Casing: (Give diameter, commercial specifications and depth below ground surface of each casing size.)

10 inch diameter Pitted Well from 1 to 30 feet
 inch diameter from to feet
 inch diameter from to feet
 inch diameter from to feet

Describe and show depth of shoe, plug, adapter, liner or other details:

9. Perforated Casings or Screens:

..... Cut with torch from 30 to 40
 (Number per foot and size of perforations, or describe screen)
 from to
 from to
 from to

10. Log of Well: (Describe each stratum or formation clearly, indicate if water bearing, and give thickness and depth as indicated.)

| MATERIAL | Thickness (Feet) | Depth to Bottom (Feet) |
|-----------|------------------|------------------------|
| Silt Loam | 15 | 15 |
| Clay Loam | 10 | 25 |
| Gravel | 15 | 40 |
| | | |
| | | |
| | | |
| | | |
| | | |
| | | |
| | | |
| | | |
| | | |
| | | |
| | | |
| | | |
| | | |
| | | |

If log of well is not available, give name and address of driller.

11. Infiltration Trench: Covered or open

Dimensions: Length ft. Minimum depth ft. Maximum depth ft.

Bottom width ft. Discharge g.p.m. Date of test

12. Tunnel: Type of lining

Dimensions:
(Length, course, and cross sectional size)

Position of water bearing stratum with reference to portal of tunnel

Log of tunnel: (Preceding table for log of well may be used, if desired. Give footage from portal and character of materials, as pertinent.)

13. Pumping Equipment:

(a) Pump centrifugal 3" x 4" Capacity 100 g.p.m.
(Make, type and size)

(b) Motor 15 H.P. electric
(Type and horsepower)

14. Location of area irrigated or to be irrigated, or place of use if for purposes other than irrigation.

| Township North or South | Range E. or W. of Willamette Meridian | Section | Forty-acre Tract | Number Acres To Be Irrigated | Date of Reclamation |
|-------------------------|---------------------------------------|---------|------------------|------------------------------|---------------------|
| 85 | 2W | 11 | NE 1/4 of SW 1/4 | 14.0 | July 1943 |
| 85 | 4W | 11 | NW 1/4 of SW 1/4 | 25.9 | " 1 |
| 85 | 4W | 10 | NE 1/4 of SE 1/4 | 14.2 | " |
| | | | | 54.1 | |
| | | | | | |
| | | | | | |
| | | | | | |
| | | | | | |
| | | | | | |
| | | | | | |
| | | | | | |
| | | | | | |
| | | | | | |
| | | | | | |
| | | | | | |
| | | | | | |
| | | | | | |
| | | | | | |
| | | | | | |
| | | | | | |
| | | | | | |
| | | | | | |
| | | | | | |
| | | | | | |

15. If the ground water supply is supplemental to an existing water supply, identification of any application for a permit, permit, certificate or adjudicated right to appropriate water made or held by the registrant.

Township 85 Range 24 W.M.
North

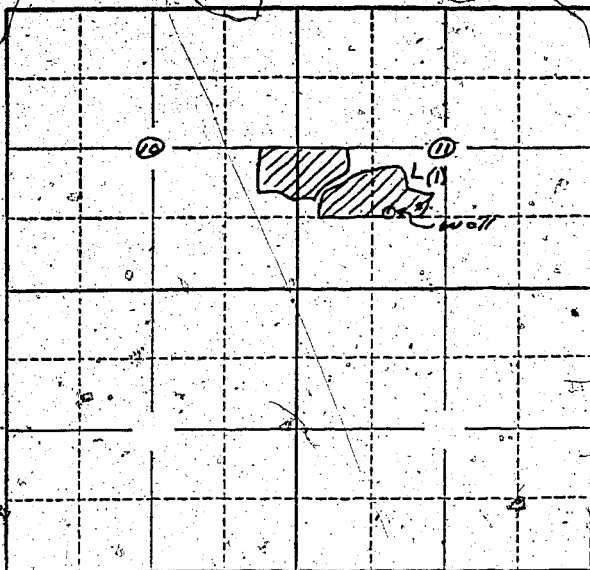

Locate well and acreage of irrigated land on plat.

Scale: 2" = 1 Mile

STATE OF OREGON

Marion

County of Park

ss.

I, E. CHEMERS HART (being first duly sworn, do hereby certify that I have read the foregoing Registration Statement and that all of the items therein contained are true to the best of my knowledge and belief

E. Chemers Hart
(State Notary Public)

Subscribed and sworn to before me this 25th day of March, 19 58

My commission expires 12th June 1961

Wm. S. Bartholomew
(Notary Public)

(SEAL)

CERTIFICATE OF REGISTRATION

STATE OF OREGON

ss.

County of Marion

This is to certify that the foregoing Registration Statement was received in the office of the State Engineer on the 25th day of April, 19 58, at 9:30 o'clock A. M. and has been duly recorded in said office in Book No. 7 of Registration Statements on page GR-1458

Witness my hand this 1st day of December, 19 58

Lewis A. Stanley
(State Engineer)

By _____ (Deputy)