

Registration Statement

OF CLAIMANT OF RIGHT TO APPROPRIATE GROUND WATER

TO THE STATE ENGINEER OF OREGON:

I, Mathie
of R.F.D. 2 Box 338 County of Marion
(Mailing address)

State of Oregon, do hereby make application for a certificate of registration as evidence of a right to appropriate ground water.

1. Source from which water is withdrawn is overflow and Runoff well
(Flowing well, pump well, infiltration trench, or tunnel)

2. Location is: approximately 6 1/2 miles from town
(Approximate distance and direction from nearest city or town)

and is more particularly described as follows:

(a) 2450 feet south & 300 feet west from NE corner Section 30
(Give distance and bearing to corner of section or other legal subdivision)

being within SE 1/4 of NE 1/4 of Sec. 30, Twp. 6 S, Rge. 2 W
(Smallest legal subdivision) (N. or S.) (E. or W.)

or (b) within limits of recorded platted property, town or city:

in Lot _____ Block _____ of _____
(Name of plat or addition)

County of _____
(If within city or town, give name)

3. Construction Work was begun on approx. May 1947; was completed on May 12, 1947
(Date) (Date)

and the ground water claimed was first used for the purposes set out below on June 1947
(Date)

since which time the water has been used irrigation, domestic purposes
(Continuously or intermittently)

from April to October, according to the records
(Date) (Date)

4. Quantity of water claimed and used is 50 gallons per minute; _____ acre feet per year.

5. Purpose or Purposes for which water is used irrigation

(Domestic, irrigation, municipal, manufacturing, industrial, etc.)

6. Description of Well: Depth 74 feet. Type drilled
(Dug or drilled)

diameter 8 in inches. Elevation of ground at well site _____ feet, mean sea level.
(As near as known)

Depth to water table _____ feet.

7. Capacity of Well: 145 g.p.m. with 6.1 feet drawdown. 325 - 41.00

223 g.p.m. with 24 feet drawdown.

Date of test 3/11/53 by Shirley Co.

If Flowing Well: Measured discharge _____ g.p.m. on _____
(Date)

Shut-in pressure at ground surface _____ lbs. per sq. in. on _____
(Date)

Water is controlled by _____
(Cap, valve, etc.)

If log of well is not available, give name and address of driller. Wymore

11. Infiltration Trench: Covered or open

Dimensions: Length ft. Minimum depth ft. Maximum depth ft.
Bottom width ft. Discharge g.p.m. Date of test

12. Tunnel: Type of lining

Dimensions:
(Length, course, and cross sectional size)
Position of water bearing stratum with reference to portal of tunnel

Log of tunnel: (Preceding table for log of well may be used, if desired. Give footage from portal and character of materials, as pertinent.)

13. Pumping Equipment:

(a) Pump Centrifugal Capacity 300 g.p.m.
(Make, type and size)
(b) Motor Cummins 24 horsepower
(Type and horsepower)

14. Location of area irrigated or to be irrigated, or place of use if for purposes other than irrigation.

Township North or South	Range E. or W. of Williamsite Meridian	Section	Forty-acre Tract	Number Acres To Be Irrigated	Date of Reclamation
<u>T6S</u>	<u>R2W</u>	<u>30</u>	<u>SE 1/4 of NE 1/4</u>	<u>7⁰</u>	<u>June 1947</u>
<u>"</u>	<u>"</u>	<u>30</u>	<u>NE 1/4 of SE 1/4</u>	<u>6⁰</u>	<u>" "</u>
<u>"</u>	<u>"</u>	<u>29</u>	<u>SW 1/4 of NW 1/4</u>	<u>7⁰</u>	<u>" "</u>
<u>"</u>	<u>"</u>	<u>29</u>	<u>NW 1/4 of SW 1/4</u>	<u>10⁰</u>	<u>" "</u>
				<u>30⁰</u>	

15. If the ground water supply is supplemental to an existing water supply, identification of any application for a permit, permit, certificate or adjudicated right to appropriate water made or held by the registrant.

Township 6S Range 2W, W.M.
North

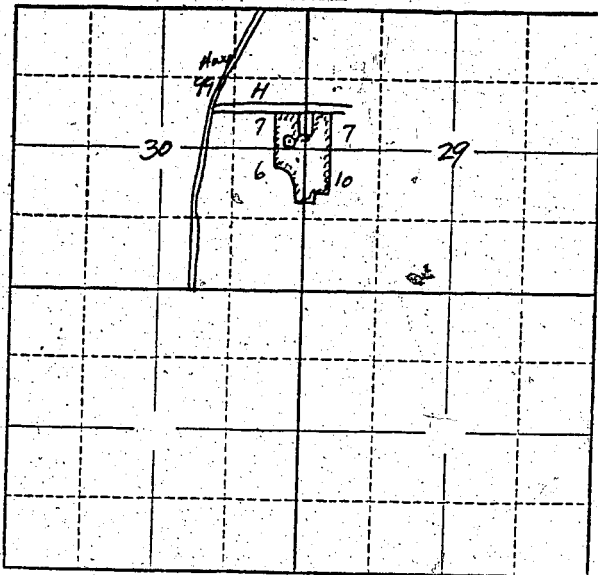

Locate well and acreage of irrigated land on plat.
Scale: 2" = 1 Mile

STATE OF OREGON

County of Marion } ss.

I, _____, being first duly sworn, do hereby certify that I have read the foregoing Registration Statement and that all of the items therein contained are true to the best of my knowledge and belief.

Lattie Mathis
(Signature of Registrant)

Subscribed and sworn to before me this 6th day of May, 1958

My commission expires 12th June 1961

Wm. S. Bartholomew
(Notary Public)

(SEAL)

CERTIFICATE OF REGISTRATION

STATE OF OREGON

County of Marion } ss.

This is to certify that the foregoing Registration Statement was received in the office of the State Engineer on the 6th day of May, 1958, at 11:30 o'clock A. M. and has been duly recorded in said office in Book No. 7 of Registration Statements on page GR 1494

Witness my hand this 1st day of December, 1958

Henry A. [Signature]
(State Engineer)

By _____ (Deputy)

GR - 1494