

Registration No. GR - 1556

Certificate No. GR - 1500

# Registration Statement

## OF CLAIMANT OF RIGHT TO APPROPRIATE GROUND WATER

TO THE STATE ENGINEER OF OREGON:

I, Leonard E. Nelson  
of 7590 Wheatland Road County of Marion  
(Mailing address)

State of Oregon, do hereby make application for a certificate of registration as evidence of a right to appropriate ground water.

1. Source from which water is withdrawn is PUMP Well  
(Flowing well, pump well, infiltration trench, or tunnel)

2. Location is: 6 Miles North of Salem  
(Approximate distance and direction from nearest city or town)

and is more particularly described as follows:

(a) 672 Ft. South and 787 Ft. West from 1/4 section bet sec 7  
(Give distance and bearing to corner of section or other legal subdivision) Section 13-26  
being within N.E. 1/4 of NW 1/4 of Sec. 26, Twp. 6S, Rge. 3W  
(Smallest legal subdivision) (N. or S.) (E. or W.)

or (b) within limits of recorded platted property, town or city:

in Lot \_\_\_\_\_ Block \_\_\_\_\_ of \_\_\_\_\_  
(Name of plat or addition)

County of \_\_\_\_\_  
(If within city or town, give name)

3. Construction Work was begun on April 1, 1952; was completed on April 15, 1952  
(Date) (Date)

and the ground water claimed was first used for the purposes set out below on May 25, 1952  
(Date)

since which time the water has been used Intermittently  
(Continuously or intermittently)

from May to October  
(Date) (Date)

4. Quantity of water claimed and used is 90 gallons per minute; 25 acre feet per year.

5. Purpose or Purposes for which water is used Irrigation  
(Domestic, irrigation, municipal, manufacturing, industrial, etc.)

6. Description of Well: Depth 116 feet. Type Drilled  
(Dug or drilled)

diameter 8 inches. Elevation of ground at well site 180 feet, mean sea level.  
(As near as known)

Depth to water table 65 feet.

7. Capacity of Well: 125 g.p.m. with 9 feet drawdown.

300 g.p.m. with 25 feet drawdown.

Date of test 4/19/52

If Flowing Well: Measured discharge \_\_\_\_\_ g.p.m. on \_\_\_\_\_  
(Date)

Shut-in pressure at ground surface \_\_\_\_\_ lbs. per sq. in. on \_\_\_\_\_  
(Date)

Water is controlled by \_\_\_\_\_  
(Cap, valve, etc.)





Township 6 S Range 3 W, W.M.  
North

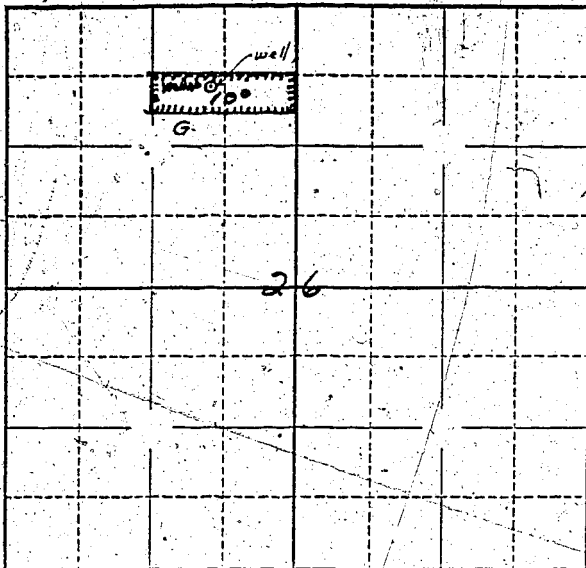

Locate well and acreage of irrigated land on plat.

Scale:  $\frac{1}{4}$  - 1 Mile

STATE OF OREGON

County of Marion } ss.

I, Leonard E. Nelson, being first duly sworn, do hereby certify that I have read the foregoing Registration Statement and that all of the items therein contained are true to the best of my knowledge and belief.

Leonard E. Nelson  
(Signature of Registrant)

Subscribed and sworn to before me this 8th day of May, 1958.

My commission expires 12th June 1961

Wm. S. Bartholomew  
(Notary Public)

(SEAL)

**CERTIFICATE OF REGISTRATION**

STATE OF OREGON

County of Marion } ss.

This is to certify that the foregoing Registration Statement was received in the office of the State Engineer on the 8th day of May, 1958, at 4:00 o'clock P. M. and has been duly recorded in said office in Book No. 7 of Registration Statements on page GR-1500

Witness my hand this 1st day of December, 1958.

Lawrence A. Atkinson  
(State Engineer)

By \_\_\_\_\_

(Deputy)

\$15.00