

Registration Statement

OF CLAIMANT OF RIGHT TO APPROPRIATE GROUND WATER

TO THE STATE ENGINEER OF OREGON:

I, H. B. & W. B. AKER

of RT1, Box 228, Brooks County of MARION
(Mailing address)

State of OREGON, do hereby make application for a certificate of registration as evidence of a right to appropriate ground water.

1. Source from which water is withdrawn is PUMP WELL
(Flowing well, pump well, infiltration trench, or tunnel)

2. Location is: 2 MILES EAST OF Brooks, O.F.E.
(Approximate distance and direction from nearest city or town)

and is more particularly described as follows:

(a) 1700 feet east and 1900 feet South from NW corner Section 22
(Give distance and bearing to corner of section or other legal subdivision)

being within SE 1/4 NW 1/4 of Sec. 22, Twp. 6S, Rge. 2W
(Smallest legal subdivision) (N. or S.) (E. or W.)

or (b) within limits of recorded platted property, town or city:

in Lot _____, Block _____ of _____
(Name of plat or addition)

County of _____
(If within city or town, give name)

3. Construction Work was begun on MARCH 1, 1942; was completed on MARCH 28, 1942
(Date) (Date)

and the ground water claimed was first used for the purposes set out below on APRIL 30, 1942
(Date)

since which time the water has been used INTERMITTENTLY
(Continuously or intermittently)

from 1942 to 1958
(Date) (Date)

4. Quantity of water claimed and used is 144 gallons per minute; _____ acre feet per year.

5. Purpose or Purposes for which water is used IRRIGATION

(Domestic, irrigation, municipal, manufacturing, industrial, etc.)

6. Description of Well: Depth 65 feet. Type PHILLED
(Dug or drilled)

diameter 8 inches. Elevation of ground at well site 125 feet, mean sea level.
(As near as known)

Depth to water table 1/2 feet. flows during wet winters

7. Capacity of Well: 144 g.p.m. with 4 feet drawdown.

_____ g.p.m. with _____ feet drawdown.

Date of test during pumping

If Flowing Well: Measured discharge _____ g.p.m. on _____
(Date)

Shut-in pressure at ground surface _____ lbs. per sq. in. on _____
(Date)

Water is controlled by _____
(Cap, valve, etc.)

Township 6 S Range 2 W, W.M. 00 22
North

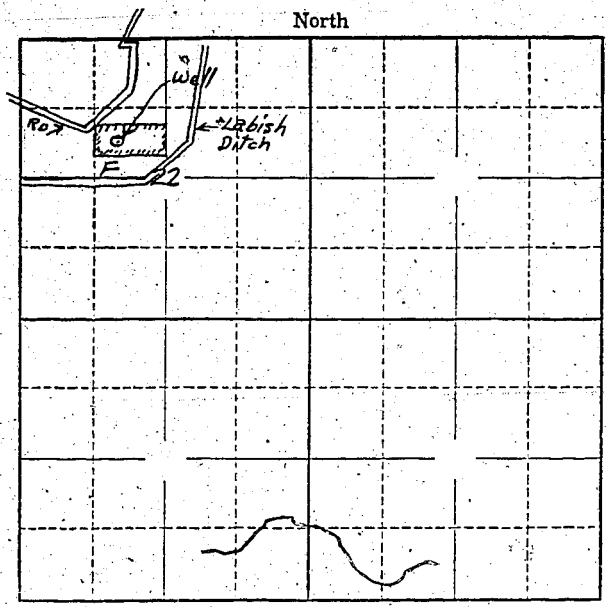

Locate well and acreage of irrigated land on plat.
Scale: 2" = 1 Mile

STATE OF OREGON

County of _____ } ss.

I, W.B. Aker - H.B. Aker, being first duly sworn, do hereby certify that I have read the foregoing Registration Statement and that all of the items therein contained are true to the best of my knowledge and belief.

W.B. Aker - H.B. Aker
(Signature of Registrant)

Subscribed and sworn to before me this 13th day of May, 1958

My commission expires 12th June 1961 Wm. J. Bartholomew
(Notary Public)

(SEAL)

CERTIFICATE OF REGISTRATION

STATE OF OREGON

County of Marion } ss.

This is to certify that the foregoing Registration Statement was received in the office of the State Engineer on the 13th day of May, 1958, at 9:30 o'clock A.M. and has been duly recorded in said office in Book No. 7 of Registration Statements on page GR-1506

Witness my hand this 1st day of December, 1958

[Signature]
(State Engineer)

By _____ (Deputy)

\$15.00