

Registration Statement

OF CLAIMANT OF RIGHT TO APPROPRIATE GROUND WATER

(Under Chapter 708, Oregon Laws 1955.)

TO THE STATE ENGINEER OF OREGON:

I, M. B. Gilchrist Rt. 2 Box 468
of Salem County of Tillamook

State of Oreg., do hereby make application for a certificate of registration as evidence of a right to appropriate ground water.

- 1. Source from which water is withdrawn is Pump Well #1
(Flowing well, pump well, infiltration trench, or tunnel)
- 2. Location is: _____
(Approximate distance and direction from nearest city or town)

and is more particularly described as follows:

(a) 300 feet east & 1100 feet south from NE corner Section 34
(Give distance and bearing to corner of section or other legal subdivision)
being within NE 1/4 of NE 1/4 of Sec. 34, Twp. 6S, Rge. 2W
(Smallest legal subdivision) (N. or S.) (E. or W.)

or (b) within limits of recorded platted property, town or city: _____
in Lot _____, Block _____ of _____
(Name of plat or addition)
County of _____
(If within city or town, give name)

3. Construction Work was begun on 1946; was completed on 1946
(Date) (Date)
and the ground water claimed was first used for the purposes set out below on 1946
(Date)
since which time the water has been used Intermittently during season
(Continuously or intermittently)
from 1946 to Oct 1957
(Date) (Date)

4. Quantity of water claimed and used is 60 gallons per minute; _____ acre feet per year.

5. Purpose or Purposes for which water is used Irrigation

(Domestic, irrigation, municipal, manufacturing, industrial, etc.)
6. Description of Well: Depth 96 feet. Type Drilled
(Dug or drilled)
diameter 6 inches. Elevation of ground at well site _____ feet, mean sea level.
(As near as known)
Depth to water table 19 feet.

7. Capacity of Well: _____ g.p.m. with _____ feet drawdown.
_____ g.p.m. with _____ feet drawdown.

Date of test _____
If Flowing Well: Measured discharge _____ g.p.m. on _____
(Date)
Shut-in pressure at ground surface _____ lbs. per sq. in. on _____
(Date)
Water is controlled by _____
(Cap, valve, etc.)

Township 6S Range 2W, W.M.
North

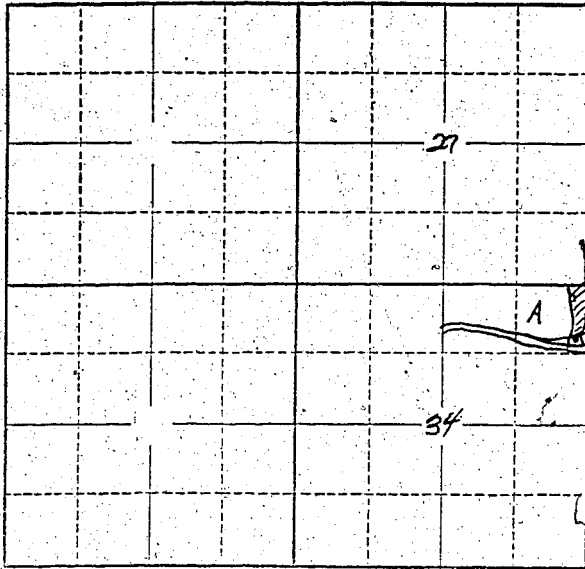

Locate well and acreage of irrigated land on plat.
Scale: 2" = 1 Mile

STATE OF OREGON

County of Marion } ss.

I, Marion B. Gilchrist, being first duly sworn, do hereby certify that I have read the foregoing Registration Statement and that all of the items therein contained are true to the best of my knowledge and belief.

Marion B. Gilchrist
(Signature of Registrant)

Subscribed and sworn to before me this 14th day of May, 1958

My commission expires 12th June 1961 Wm. S. Bartholmes
(Notary Public)

(SEAL)

CERTIFICATE OF REGISTRATION

STATE OF OREGON } ss.
County of Marion

This is to certify that the foregoing Registration Statement was received in the office of the State Engineer on the 14th day of May, 1958, at 12:00 o'clock A.M. and has been duly recorded in said office in Book No. 7 of Registration Statements on page GR-1509

~~Construction shall be completed by 1800 and the water completely applied to beneficial use by 1800~~

Witness my hand this 1st day of December, 1958

David A. Murphy
(State Engineer)

\$1500

By _____
(Deputy)

GR-1509