

Registration Statement

REGISTRATION NO. GR-1568
CERTIFICATE NO. GR-1510

OF CLAIMANT OF RIGHT TO APPROPRIATE GROUND WATER

(Under Chapter 708, Oregon Laws 1955.)

TO THE STATE ENGINEER OF OREGON:

I, Leonard R. Ferschweiler

of Rt. 1 Box 458 Woodburn County of Marion

State of Oregon do hereby make application for a certificate of registration as evidence of a right to appropriate ground water.

1. Source from which water is withdrawn is Pump
(Flowing well, pump well, infiltration trench, or tunnel)

2. Location is: 1 1/2 miles North of St. Louis
(Approximate distance and direction from nearest city or town)

and is more particularly described as follows: 2050 feet west & 1200 feet south from NE corner Section 16

(a) S. 89° 15' E 2,054.3" From Northeast Corner of Section 16
(Give distance and bearing to corner of section or other legal subdivision)

being within NW 1/4 of NE 1/4 of Sec. 16, Twp. 5 S, Rge. 2 W
(Smallest legal subdivision) (N. or S.) (E. or W.)

or (b) within limits of recorded platted property, town or city:

in Lot _____, Block _____ of _____
(Name of plat or addition)

(If within city or town, give name)

County of _____

3. Construction Work was begun on April 25, 1953; was completed on July 3, 1953
(Date) (Date)

and the ground water claimed was first used for the purposes set out below on July 3, 1953
(Date)

since which time the water has been used Intermittently
(Continuously or intermittently)

from April 1953 to Sept 1957
(Date) (Date)

4. Quantity of water claimed and used is 240 gallons per minute; 135 acre feet per year.

5. Purpose or Purposes for which water is used Irrigation

(Domestic, irrigation, municipal, manufacturing, industrial, etc.)

6. Description of Well: Depth 103 feet. Type Drilled

(Dug or drilled)

diameter 10 inches. Elevation of ground at well site 158 feet, mean sea level.
(As near as known)

Depth to water table 15 feet.

7. Capacity of Well: 400 g.p.m. with 18 feet drawdown.

_____ g.p.m. with _____ feet drawdown.

Date of test 6 - 2 - 53

If Flowing Well: Measured discharge _____ g.p.m. on _____

(Date)

Shut-in pressure at ground surface _____ lbs. per sq. in. on _____

(Date)

Water is controlled by _____

(Cap. valve, etc.)

8. Casing: (Give diameter, commercial specifications and depth below ground surface of each casing size.)

10 inch diameter Steel from 01 to 103 feet
 inch diameter from to feet
 inch diameter from to feet
 inch diameter from to feet

Describe and show depth of shoe, plug, adapter, liner or other details: No

9. Perforated Casings or Screens:

No. from to
 (Number per foot and size of perforations, or describe screen)
 from to
 from to
 from to

10. Log of Well: (Describe each stratum or formation clearly, indicate if water bearing, and give thickness and depth as indicated.)

MATERIAL	Thickness (Feet)	Depth to Bottom (Feet)
Surface	0	10
Water Mucky sand	12	22
Clay	56	78
Sand	5	83
Broken sand and gravel	3	86
Sand	2	88
Sand and gravel	4	92
Broken Sand and clay	7	99
Clay	4	103
Black sand well tested and clean at		
400 gal. per. minute at 18 ft. drawdown		
Pipe set at 97 ft. 1 inch		

If log of well is not available, give name and address of driller. J. T. Miller

Aurora, Oregon

11. Infiltration Trench: Covered or open None

Dimensions: Length _____ ft. Minimum depth _____ ft. Maximum depth _____ ft.

Bottom width _____ ft. Discharge _____ g.p.m. Date of test _____

12. Tunnel: Type of lining None

Dimensions: _____
(Length, course, and cross sectional size)

Position of water bearing stratum with reference to portal of tunnel _____

Log of tunnel: (Preceding table for log of well may be used, if desired. Give footage from portal and character of materials, as pertinent.)

13. Pumping Equipment:

(a) Pump Gould Centrifical Capacity 300 g.p.m.
(Make, type and size)

(b) Motor 25 Horse Power 3 PH
(Type and horsepower)

14. Location of area irrigated or to be irrigated, or place of use if for purposes other than irrigation.

Township North or South	Range E. or W. of Willamette Meridian	Section	Forty-acre Tract	Number Acres To Be Irrigated	Date of Reclamation
<u>T5S</u>	<u>R2W</u>	<u>16</u>	<u>NW 1/4 of NW 1/4</u>	<u>2⁰</u>	<u>July 3, 1953</u>
"	"	"	<u>NE 1/4 of NW 1/4</u>	<u>13⁰</u>	" " "
"	"	"	<u>NW 1/4 of NE 1/4</u>	<u>13⁰</u>	" " "
"	"	"	<u>NE 1/4 of NE 1/4</u>	<u>18⁰</u>	" " "
<u>T5S</u>	<u>R2W</u>	<u>15</u>	<u>NW 1/4 of NW 1/4</u>	<u>7⁰</u>	" " "
				<u>53⁰</u>	

15. If the ground water supply is supplemental to an existing water supply, identification of any application for a permit, permit, certificate or adjudicated right to appropriate water made or held by the registrant.

Township 55 Range 2W, W.M.
North

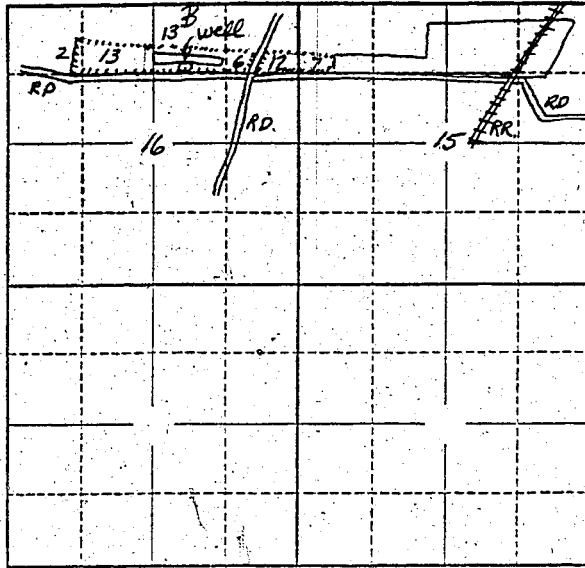

Locate well and acreage of irrigated land on plat.
Scale: 2" = 1 Mile

STATE OF OREGON }
County of Marion } ss.

I, Leonard Berachmidt, being first duly sworn, do hereby certify that I have read the foregoing Registration Statement and that all of the items therein contained are true to the best of my knowledge and belief.

Leonard Berachmidt
(Signature of Registrant)

Subscribed and sworn to before me this 15th day of May, 1958

My commission expires 12th June 1961 Wm. S. Bartholomew
(Notary Public)

(SEAL)

CERTIFICATE OF REGISTRATION

STATE OF OREGON }
County of Marion } ss.

This is to certify that the foregoing Registration Statement was received in the office of the State Engineer on the 15th day of May, 1958, at 10:00 o'clock A. M. and has been duly recorded in said office in Book No. 7 of Registration Statements on page GR-1510

~~Construction shall be completed by 1959 and the water completely applied to beneficial use by 1960.~~

Witness my hand this 1st day of December, 1958

Clara A. Glavin
(State Engineer)

\$ 18.75

By _____ (Deputy) GR-1510