

RECEIVED
MAY 21 1958
STATE ENGINEER
SALEM, OREGON

Registration No. GR 1591

Certificate No. GR 1539

Registration Statement

OF CLAIMANT OF RIGHT TO APPROPRIATE GROUND WATER

TO THE STATE ENGINEER OF OREGON:

I, Fielding C. Parker

of Route 4, Box 241, Albany County of Benton
(Mailing address)

State of Oregon, do hereby make application for a certificate of registration as evidence of a right to appropriate ground water.

1. Source from which water is withdrawn is pump well
(Flowing well, pump well, infiltration trench, or tunnel)

2. Location is: 2 miles N. W. of Albany, Oregon
(Approximate distance and direction from nearest city or town)

and is more particularly described as follows:
Beginning at a point which is 16.58 ch (S 89°54' W) W 21.78 ch distant from the N.W.

(a) corner of the A.M. Rainwater DIC
(Give distance and bearing to corner of section or other legal subdivision)

being within NW 1/4 Sec 2 of Sec. 2, Twp. 11 S, Rge. 4 W
(Smallest legal subdivision) (N. or S.) (E. or W.)

or (b) within limits of recorded platted property, town or city:

in Lot _____, Block _____ of _____
(Name of plat or addition)

_____ County of _____
(If within city or town, give name)

3. Construction Work was begun on June 1951; was completed on June 1951
(Date) (Date)

and the ground water claimed was first used for the purposes set out below on 6/10/51
(Date)

since which time the water has been used every summer - intermittently during season
(Continuously or Intermittently)

from 6/1951 to 10/1957
(Date) (Date)

4. Quantity of water claimed and used is 50 gallons per minute; 15,000 gals. per acre
feet per year.

5. Purpose or Purposes for which water is used irrigate home garden and limited acreage of
farm crops
(Domestic, irrigation, municipal, manufacturing, industrial, etc.)

6. Description of Well: Depth 22 feet. Type drone
(Dug or drilled)

diameter 2 1/2 inches. Elevation of ground at well site About 135 feet, mean sea level.
(As near as known)

Depth to water table 19 feet.

7. Capacity of Well: 50 g.p.m. with 0 feet drawdown.

_____ g.p.m. with _____ feet drawdown.

Date of test June 1951

If Flowing Well: Measured discharge _____ g.p.m. on _____
(Date)

Shut-in pressure at ground surface _____ lbs. per sq. in. on _____
(Date)

Water is controlled by _____
(Cap, valve, etc.)

8. Casing: (Give diameter, commercial specifications and depth below ground surface of each casing size)

2- 1 1/4 inch diameter Pipes from 0 to 22 feet
 _____ inch diameter _____ from _____ to _____ feet
 _____ inch diameter _____ from _____ to _____ feet
 _____ inch diameter _____ from _____ to _____ feet

Describe and show depth of shoe, plug, adapter, liner or other details: _____

9. Perforated Casings or Screens:

_____ from _____ to _____
 (Number per foot and size of perforations, or describe screen)
 _____ from _____ to _____
 _____ from _____ to _____
 _____ from _____ to _____

10. Log of Well: (Describe each stratum or formation clearly, indicate if water bearing, and give thickness and depth as indicated.)

MATERIAL	Thickness (Feet)	Depth to Bottom (Feet)
Sandy loam	19'	19'
Gravel	3'	3'

If log of well is not available, give name and address of driller.

11. Infiltration Trench: Covered or open
 Dimensions: Length ft. Minimum depth ft. Maximum depth ft.
 Bottom width ft. Discharge g.p.m. Date of test

12. Tunnel: Type of lining
 Dimensions:
(Length, course, and cross sectional size)
 Position of water bearing stratum with reference to portal of tunnel

Log of tunnel: (Preceding table for log of well may be used, if desired. Give footage from portal and character of materials, as pertinent.)

13. Pumping Equipment:
 (a) Pump $1\frac{1}{2}$ " centrifugal Capacity 50 g.p.m.
(Make, type and size)
 (b) Motor 7.2 H.P. Ward's gas engine
(Type and horsepower)

14. Location of area irrigated or to be irrigated, or place of use if for purposes other than irrigation.

Township North or South	Range E. or W. of Willamette Meridian	Section	Forty-acre Tract	Number Acres To Be Irrigated	Date of Reclamation
11S	4W	2	NW 1/4 SE 1/4	6	June 1951

15. If the ground water supply is supplemental to an existing water supply, identification of any application for a permit, permit, certificate or adjudicated right to appropriate water made or held by the registrant.

Township 11S Range 4W W.M. (more detailed map attached)
North

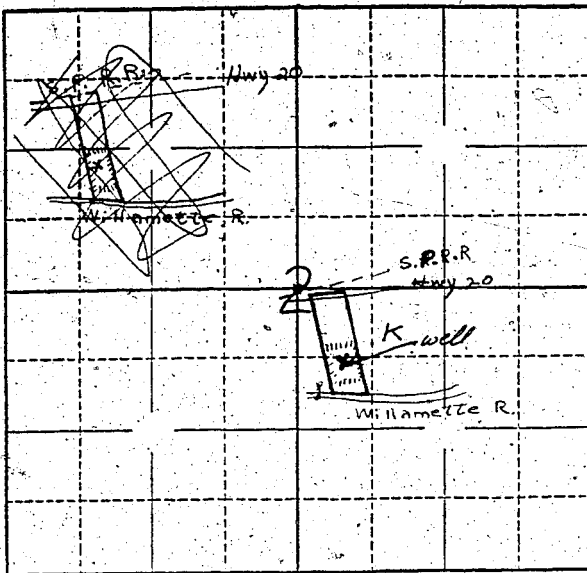

Locate well and acreage of irrigated land on plat.

Scale: $\frac{1}{4}'' = 1$ Mile

STATE OF OREGON

County of Benton } ss.

I, Fielding C. Parker, being first duly sworn, do hereby certify that I have read the foregoing Registration Statement and that all of the items therein contained are true to the best of my knowledge and belief.

Fielding C. Parker
(Signature of Registrant)

Subscribed and sworn to before me this 20th day of May, 1958.

My commission expires 4/16/60

Alphonsus B. Buzza
(Notary Public)

(SEAL)

CERTIFICATE OF REGISTRATION

STATE OF OREGON } ss.
County of Marion

This is to certify that the foregoing Registration Statement was received in the office of the State Engineer on the 21st day of May, 1958, at 8:00 o'clock A. M. and has been duly recorded in said office in Book No. 7 of Registration Statements on page GR-1539

Witness my hand this 1st day of December, 1958.

Lewis A. Standley
(State Engineer)

\$15.00

By _____ (Deputy)

GR - 1539