

RECEIVED
MAY 21 1958

STATE ENGINEER
SALEM, OREGON

Registration No. GR - 1597

Certificate No. GR - 1519

Registration Statement

OF CLAIMANT OF RIGHT TO APPROPRIATE GROUND WATER

TO THE STATE ENGINEER OF OREGON:

1. Donald J LaMotte

of Box 6 Milton Freewater County of Umatilla

State of Oregon do hereby make application for a certificate of registration as evidence of a right to appropriate ground water.

1. Source from which water is withdrawn is Dug Well

2. Location is: 490 1/2' West, 1610' North of SE Corner

1 1/2 Mile NW Milton Freewater

and is more particularly described as follows:

(a) 490 1/2' West 1610' North of SE Corner

being within E 1/4 of SW 1/4 of Sec. 34 Twp. 6N Rge. 35E

or (b) within limits of recorded platted property, town or city:

in Lot 5 Block - of Dext's Pleasantview Addn

County of Umatilla

3. Construction Work was begun on Nov 1922; was completed on 1922

and the ground water claimed was first used for the purposes set out below on 1922

since which time the water has been used Continuously

from 1922 to 1958

4. Quantity of water claimed and used is 250 gallons per minute; 44 acre feet per year.

5. Purpose or Purposes for which water is used Irrigation

6. Description of Well: Depth 48 feet. Type Dug

diameter 6' x 6' inches. Elevation of ground at well site 875 feet, mean sea level.

Depth to water table 40 feet. May 1958

7. Capacity of Well: 250 g.p.m. with 4-6 feet drawdown.

g.p.m. with _____ feet drawdown.

Date of test _____

If Flowing Well: Measured discharge _____ g.p.m. on _____ (Date)

Shut-in pressure at ground surface _____ lbs. per sq. in. on _____ (Date)

Water is controlled by _____ (Cap. valve, etc.)

8. Casing: (Give diameter, commercial specifications and depth below ground surface of each casing size.)

72 x 72 inch diameter Concrete Curbing from 0 to 15 feet
 inch diameter from to feet
 inch diameter from to feet
 inch diameter from to feet

Describe and show depth of shoe, plug, adapter, liner or other details:

9. Perforated Casings or Screens:

..... from to
(Number per foot and size of perforations, or describe screen)
 from to
 from to
 from to

10. Log of Well: (Describe each stratum or formation clearly, indicate if water bearing, and give thickness and depth as indicated.)

MATERIAL	Thickness (Feet)	Depth to Bottom (Feet)
<u>Gravelly loam</u>	<u>03</u>	<u>3</u>
<u>Cement Gravel + Cobbles</u>	<u>45</u>	<u>48</u>

If log of well is not available, give name and address of driller. L.N. KNOX

11. Infiltration Trench: Covered or open

Dimensions: Length ft. Minimum depth ft. Maximum depth ft.

Bottom width ft. Discharge g.p.m. Date of test

12. Tunnel: Type of lining

Dimensions:
(Length, course, and cross sectional size)

Position of water bearing stratum with reference to portal of tunnel

Log of tunnel: (Preceding table for log of well may be used, if desired. Give footage from portal and character of materials, as pertinent.)

13. Pumping Equipment:

(a) Pump 3" Centrifugal Capacity 350 g.p.m.
(Make, type and size)

(b) Motor 10 HP 3 phase Electric
(Type and horsepower)

14. Location of area irrigated or to be irrigated, or place of use if for purposes other than irrigation.

Township North or South	Range E. or W. of Williams's Meridian	Section	Forty-acre Tract	Number Acres To Be Irrigated	Date of Reclamation
<u>6N</u>	<u>35E</u>	<u>34</u>	<u>NE 1/4 of SW 1/4</u>	<u>11</u>	<u>Prior to 1914</u>

15. If the ground water supply is supplemental to an existing water supply, identification of any application for a permit, permit, certificate or adjudicated right to appropriate water made or held by the registrant.

Not Supplemental

Township 6N Range 35E, W.M.
North

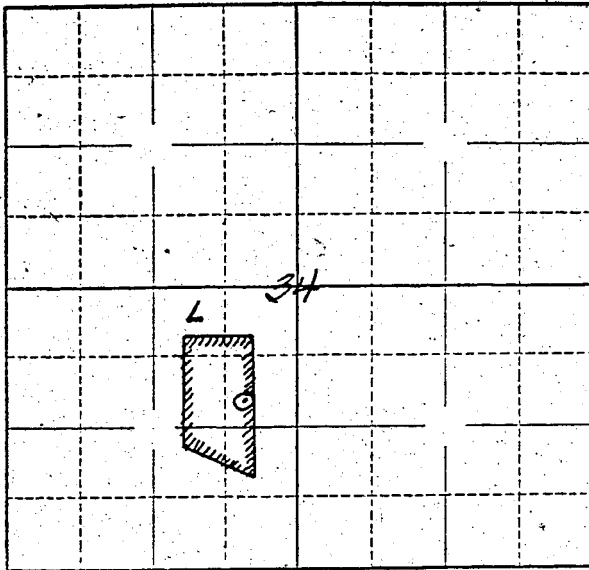

Locate well and acreage of irrigated land on plat.

Scale: $\frac{1}{4}$ - 1 Mile

STATE OF OREGON

County of WASCO } ss.

I, Donald L. Matto, being first duly sworn, do hereby certify that I have read the foregoing Registration Statement and that all of the items therein contained are true to the best of my knowledge and belief.

Donald L. Matto
(Signature of Registrant)

Subscribed and sworn to before me this _____ day of _____, 19____.

My commission expires _____ (Notary Public)

(SEAL)

CERTIFICATE OF REGISTRATION

STATE OF OREGON

County of Marion } ss.

This is to certify that the foregoing Registration Statement was received in the office of the State Engineer on the 23rd day of May, 1958, at 8:00 o'clock A.M. and has been duly recorded in said office in Book No. 7 of Registration Statements on page GR-1545

Witness my hand this 1st day of December, 1958

Lewis A. Skowron
(State Engineer)

#15.00

By _____ (Deputy)

GR - 1549