

Registration Statement

OF CLAIMANT OF RIGHT TO APPROPRIATE GROUND WATER

(Under Chapter 708, Oregon Laws 1955.)

TO THE STATE ENGINEER OF OREGON:

I, Honoras H. & Marjorie O. Ralphs
of Aumsville County of Marion

State of Oregon do hereby make application for a certificate of registration as evidence of a right to appropriate ground water.

1. Source from which water is withdrawn is Pumped Well # 1
(Flowing well, pump well, infiltration trench, or tunnel)

2. Location is: 5 miles South of Aumsville, Oregon
(Approximate distance and direction from nearest city or town)

and is more particularly described as follows:

Beginning S.E. Corner Sec. 24 thence N10°47'26" 2,063.6 ft. to well #1,
(a) 2,027' North & 386.3' West of the S.E. Corner Sec. 24
(Give distance and bearing to corner of section or other legal subdivision)

being within NE 1/4 SE 1/4 of Sec. 24, Twp. 9S, Rge. 2W
(Smallest legal subdivision) (N. or S.) (E. or W.)

or (b) within limits of recorded platted property, town or city:

in Lot _____, Block _____ of _____
(Name of plat or addition)

County of Marion

(If within city or town, give name)

3. Construction Work was begun on 3-16-43; was completed on 3-22-43
(Date) (Date)

and the ground water claimed was first used for the purposes set out below on 6-10-43
(Date)

since which time the water has been used Continuously during Irrigation Season
(Continuously or intermittently)

from 6-10-43 to present
(Date) (Date)

4. Quantity of water claimed and used is 350 gallons per minute; 87.5 acre
feet per year. ~~705~~

5. Purpose or Purposes for which water is used Irrigation

(Domestic, irrigation, municipal, manufacturing, industrial, etc.)

6. Description of Well: Depth 25 feet. Type drilled
(Dug or drilled)

diameter 8 inches. Elevation of ground at well site 372 feet, mean sea level.
(As near as known)

Depth to water table 11 feet.

7. Capacity of Well: 450 g.p.m. with 1 feet drawdown. - 6-14-55

215 g.p.m. with 7 feet drawdown. - 8-7-55

Date of test see above

If Flowing Well: Measured discharge _____ g.p.m. on _____
(Date)

Shut-in pressure at ground surface _____ lbs. per sq. in. on _____
(Date)

Water is controlled by _____
(Cap, valve, etc.)

8. Casing: (Give diameter, commercial specifications and depth below ground surface of each casing size.)

8 inch diameter *Steel casing* from *0* to *2.5* feet
 inch diameter from to feet
 inch diameter from to feet
 inch diameter from to feet

Describe and show depth of shoe, plug, adapter, liner or other details: *U.N.K.N.O.W.N.*

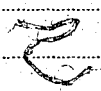

9. Perforated Casings or Screens:

Perforated from *unknown* to *unknown*
(Number per foot and size of perforations, or describe screen)
 from to
 from to
 from to

10. Log of Well: (Describe each stratum or formation clearly, indicate if water bearing, and give thickness and depth as indicated.)

MATERIAL	Thickness (Feet)	Depth to Bottom (Feet)
<i>Recent alluvial fill from North Santiam River. Chehalis top soil, dug into sand & gravel aquifer.</i>	<i>unknown</i>	<i>unknown</i>

If log of well is not available, give name and address of driller. Maria West, Rt. 6,

Salem, Ore.

11. Infiltration Trench: Covered or open

Dimensions: Length ft. Minimum depth ft. Maximum depth ft.

Bottom width ft. Discharge g.p.m. Date of test

12. Tunnel: Type of lining

Dimensions:
(Length, course, and cross sectional size)

Position of water bearing stratum with reference to portal of tunnel

Log of tunnel: (Preceding table for log of well may be used, if desired. Give footage from portal and character of materials, as pertinent.)

13. Pumping Equipment:

(a) Pump 4" Fairbanks Morse Centrifugal Capacity 450 g.p.m.
Universal
(Make, type and size)

(b) Motor 15 h.p. Electric
(Type and horsepower)

14. Location of area irrigated or to be irrigated, or place of use if for purposes other than irrigation.

Township North or South	Range E. or W. of Willamette Meridian	Section	Forty-acre Tract	Number Acres To Be Irrigated	Date of Reclamation
9S	2W	24	NE 1/4 SE 1/4	13 ⁰⁰	6-10-43
"	"	"	SE 1/4 NE 1/4	17 ⁰⁰	6-10-43
"	"	"	NE 1/4 NE 1/4	5 ⁰⁰	6-10-43
				<u>35⁰⁰</u>	

15. If the ground water supply is supplemental to an existing water supply, identification of any application for a permit, permit, certificate or adjudicated right to appropriate water made or held by the registrant.

See registration for Well #2 which is supplemental to this supply.

Township 9 S Range 2 W, W.M.
North

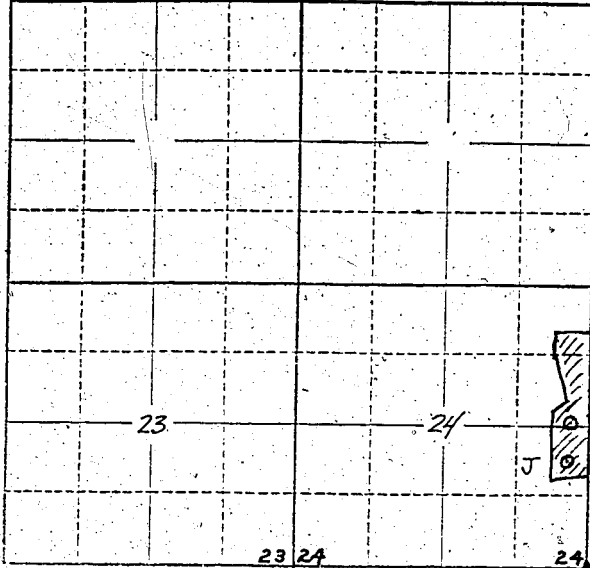

Locate well and acreage of irrigated land on plat.

Scale: 2" = 1 Mile

STATE OF OREGON

County of Marion } ss.

I, _____, being first duly sworn, do hereby certify that I have read the foregoing Registration Statement and that all of the items therein contained are true to the best of my knowledge and belief.

Howard H. Ralph
(Signature of Registrant)

Subscribed and sworn to before me this 23rd day of May, 1958.

My commission expires 12th June 1961

Wm. S. Bartholomew
(Notary Public)

(SEAL)

CERTIFICATE OF REGISTRATION

STATE OF OREGON }
County of Marion } ss.

This is to certify that the foregoing Registration Statement was received in the office of the State Engineer on the 23rd day of May, 1958, at 11:00 o'clock A.M. and has been duly recorded in said office in Book No. 7 of Registration Statements on page GR-1556

~~Construction shall be completed by _____ and the entire amount applied to _____~~
~~_____ by _____~~

Witness my hand this 1st day of December, 1958

(State Engineer)

By _____
(Deputy)

GR-1556

8. Casing: (Give diameter, commercial specifications and depth below ground surface of each casing size.)

10 inch diameter from 80 to 100 feet
..... inch diameter from to feet
..... inch diameter from to feet
..... inch diameter from to feet

Describe and show depth of shoe, plug, adapter, liner or other details:
.....
.....

9. Perforated Casings or Screens:

unknown from to
(Number per foot and size of perforations, or describe screen)
..... from to
..... from to
..... from to

10. Log of Well: (Describe each stratum or formation clearly, indicate if water bearing, and give thickness and depth as indicated.)

MATERIAL	Thickness (Feet)	Depth to Bottom (Feet)
unknown		

If log of well is not available, give name and address of driller. Waymore Well Drillers

Robinson Well Drillers

11. Infiltration Trench: Covered or open _____

Dimensions: Length _____ ft. Minimum depth _____ ft. Maximum depth _____ ft.

Bottom width _____ ft. Discharge _____ g.p.m. Date of test _____

12. Tunnel: Type of lining _____

Dimensions: _____
(Length, course, and cross sectional size)

Position of water bearing stratum with reference to portal of tunnel _____

Log of tunnel: (Preceding table for log of well may be used, if desired. Give footage from portal and character of materials, as pertinent.)

13. Pumping Equipment:

(a) Pump 15 hp pump _____ Capacity 300 g.p.m.
(Make, type and size)

(b) Motor Turbine _____
(Type and horsepower)

14. Location of area irrigated or to be irrigated, or place of use if for purposes other than irrigation.

Township North or South	Range E. or W. of Willamette Meridian	Section	Forty-acre Tract	Number Acres To Be Irrigated	Date of Reclamation
7 S	2 W	Caplinger Donation	(Vol. 326	Page 155)	1940

Please note that we do not use water for acreage irrigation but for Cannery and Growing of Mushroom in houses, not open fields

15. If the ground water supply is supplemental to an existing water supply, identification of any application for a permit, permit, certificate or adjudicated right to appropriate water made or held by the registrant.

Caplinger Donation
 Township 7 S Range 2W W.M.
 North

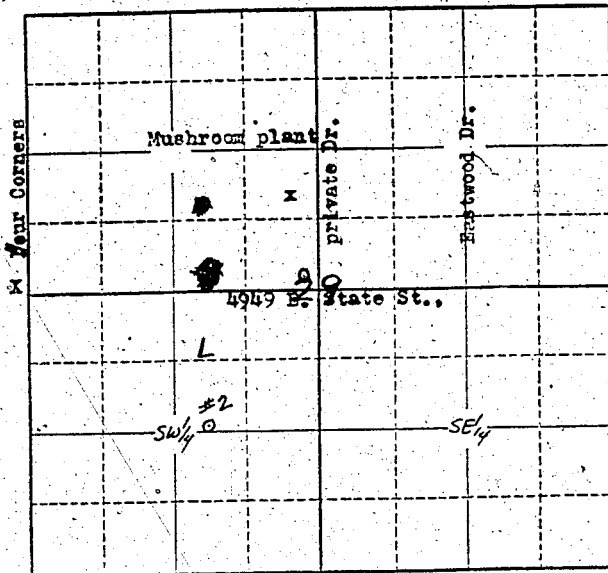

Locate well and acreage of irrigated land on plat.

Scale: 4" = 1 Mile
 4" = 1 Mile

STATE OF OREGON
 County of Marion

} ss.

I, Howard R. West, being first duly sworn, do hereby certify that I have read the foregoing Registration Statement and that all of the items therein contained are true to the best of my knowledge and belief.

WestFoods, Inc.

sec'y

(Signature of Registrant)

Subscribed and sworn to before me this 17th day of November, 1958.

My commission expires August 13, 1961

Laura Hume
 (Notary Public)

(SEAL)

CERTIFICATE OF REGISTRATION

STATE OF OREGON
 County of Marion

} ss.

This is to certify that the foregoing Registration Statement was received in the office of the State Engineer on the 21st day of May, 1957, at 8:00 o'clock A.M. and has been duly recorded in said office in Book No. 57 of Registration Statements on page GR-1566 G

Witness my hand this 1st day of December, 1958.

Laura A. Stinson
 (State Engineer)

By _____ (Deputy)

20.00

GR - 1566 - G