

Registration Statement

OF CLAIMANT OF RIGHT TO APPROPRIATE GROUND WATER

TO THE STATE ENGINEER OF OREGON:

I, Harry M. Schaffner

of Route 2, Box 622, Salem County of Marion

State of Oregon, do hereby make application for a certificate of registration as evidence of a right to appropriate ground water.

1. Source from which water is withdrawn is Drilled well
(Flowing well, pump well, infiltration trench, or tunnel)

2. Location is: 5 miles North East of Salem
(Approximate distance and direction from nearest city or town)

and is more particularly described as follows:

(a) 1100 feet east & 970 feet north from SW corner Section 15
(Give distance and bearing to corner of section, or other legal subdivision)

being within SW 1/4 SW 1/4 of Sec. 15, Twp. 7 S, Rge. 2 W
(Smallest legal subdivision) (S. or S.) (E. or W.)

or (b) within limits of recorded platted property, town or city:

in Lot _____, Block X of _____
(Name of plat or addition)

(If within city or town, give name) _____ County of _____

3. Construction Work was begun on 1950; was completed on 1950
(Date) (Date)

and the ground water claimed was first used for the purposes set out below on 1952
(Date)

since which time the water has been used intermittently during season
(Continuously or intermittently)

from 1952 to Oct 1957
(Date) (Date)

4. Quantity of water claimed and used is 40 gallons per minute; _____ acre feet per year.

5. Purpose or Purposes for which water is used Irrigation

(Domestic, irrigation, municipal, manufacturing, industrial, etc.)

6. Description of Well: Depth 62 feet. Type Drilled
(Dug or drilled)

diameter 6 inches. Elevation of ground at well site _____ feet, mean sea level.
(As near as known)

Depth to water table 40 feet.

7. Capacity of Well: 40 g.p.m. with 12 feet drawdown.

_____ g.p.m. with _____ feet drawdown.

Date of test _____

If Flowing Well: Measured discharge _____ g.p.m. on _____
(Date)

Shut-in pressure at ground surface _____ lbs. per sq. in. on _____
(Date)

Water is controlled by _____
(Cap, valve, etc.)

Township 7S Range 2W W.M.
North

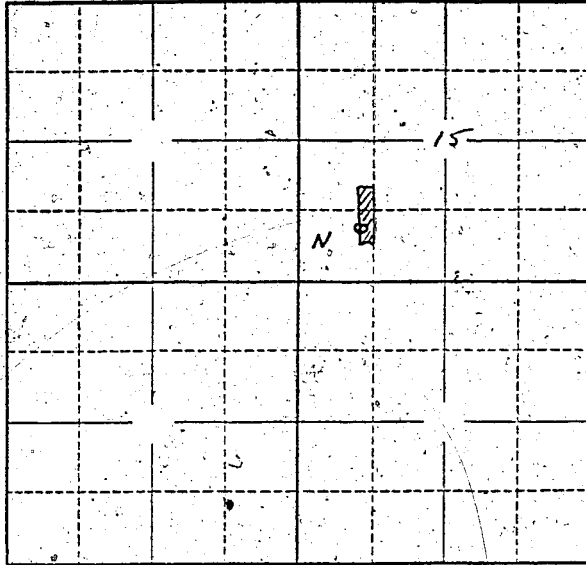

Locate well and acreage of irrigated land on plat.
Scale: 2" = 1 Mile

STATE OF OREGON

County of _____ } ss.

I, Harry M. Schaffer, being first duly sworn, do hereby certify that I have read the foregoing Registration Statement and that all of the items therein contained are true to the best of my knowledge and belief.

Harry M. Schaffer
(Signature of Registrant)

Subscribed and sworn to before me this 26th day of May, 1958.

My commission expires 12th June 1961 Wm. S. Bartholmeis
(Notary Public)

(SEAL)

CERTIFICATE OF REGISTRATION

STATE OF OREGON

County of Marion } ss.

This is to certify that the foregoing Registration Statement was received in the office of the State Engineer on the 26th day of May, 1958, at 1:00 o'clock P.M. and has been duly recorded in said office in Book No. 7 of Registration Statements on page GR-1558

Witness my hand this 1st day of December, 1958

Clara A. Atkinson
(State Engineer)

By _____
(Deputy)

\$1500