

MAY 1958
STATE ENGINEER
SALESMAN

Registration No. GR - 1607
Certificate No. GR - 1559

Registration Statement

OF CLAIMANT OF RIGHT TO APPROPRIATE GROUND WATER

TO THE STATE ENGINEER OF OREGON:

I, Clyde Cronshaw
of Rt 2 Box 187 Central Point County of Jackson
(Mailing address)
State of Oregon, do hereby make application for a certificate of registration as evidence of a right to appropriate ground water.

- 1. Source from which water is withdrawn is Pump well #1
(Flowing well, pump well, infiltration trench, or tunnel)
- 2. Location is: 3 miles Northeast of Central Point
(Approximate distance and direction from nearest city or town)

and is more particularly described as follows:

(a) Approx. 500 ft. SW of NE corner of the SW 1/4 of SW 1/4
(Give distance and bearing to corner of section or other legal subdivision)
being within SW 1/4 SW 1/4 of Sec. 30, Twp. 36 S, Rge. 1 W
(Smallest legal subdivision) (N. or S.) (E. or W.)

or (b) within limits of recorded platted property, town or city:
in Lot _____, Block _____ of _____
(Name of plat or addition)
County of Jackson
(If within city or town, give name)

3. Construction Work was begun on September 1953, was completed on Oct 1953
(Date) (Date)
and the ground water claimed was first used for the purposes set out below on Oct 1953
(Date)
since which time the water has been used Continuously through irrigating season
(Continuously or intermittently) (Date)
from Oct 1953 to present
(Date) (Date)

4. Quantity of water claimed and used is 320 gallons per minute; _____ acre feet per year.

5. Purpose or Purposes for which water is used irrigation
(Domestic, irrigation, municipal, manufacturing, industrial, etc.)

6. Description of Well: Depth 60 feet. Type Drilled
(Dug or drilled)
diameter 6 inches. Elevation of ground at well site _____ feet, mean sea level.
(As near as known)
Depth to water table 15 feet.

7. Capacity of Well: 327 g.p.m. with _____ feet drawdown.
_____ g.p.m. with _____ feet drawdown.

Date of test Oct 1953

If Flowing Well: Measured discharge _____ g.p.m. on _____ (Date)

Shut-in pressure at ground surface _____ lbs. per sq. in. on _____ (Date)

Water is controlled by _____ (Cap, valve, etc.)

Township 36 S Range 1 W W.M.
North

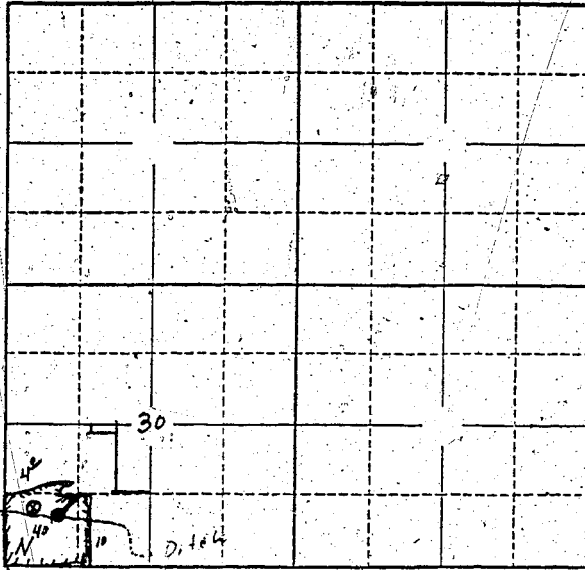

Locate well and acreage of irrigated land on plat.
Scale: 2" = 1 Mile

STATE OF OREGON

County of JACKSON

} ss.

I, CLYDE GREENSHAW, being first duly sworn, do hereby certify that I have read the foregoing Registration Statement and that all of the items therein contained are true to the best of my knowledge and belief.

Clyde Greenshaw

(Signature of Registrant)

Subscribed and sworn to before me this 22 day of MAY, 1958.

My commission expires SEP. 10, 1963

J. C. Miller

(Notary Public)

(SEAL)

CERTIFICATE OF REGISTRATION

STATE OF OREGON

County of Marion

} ss.

This is to certify that the foregoing Registration Statement was received in the office of the State Engineer on the 26th day of May, 1958, at 8:00 o'clock A.M. and has been duly recorded in said office in Book No. 7 of Registration Statements on page GR-1559

Witness my hand this 1st day of December, 1958.

Paul A. Stender

(State Engineer)

By _____
(Deputy)

GR - 1559

#1860