

MAY 20 1958
STATE ENGINEER
SALES DIVISION

Registration Statement

OF CLAIMANT OF RIGHT TO APPROPRIATE GROUND WATER

TO THE STATE ENGINEER OF OREGON:

I, Clyde Crenshaw
of Rt. 2 Box 187 Central Point County of Jackson
(Mailing address)
State of Oregon, do hereby make application for a certificate of registration as evidence of a right to appropriate ground water.

- 1. Source from which water is withdrawn is Pump well #3
(Flowing well, pump well, infiltration trench, or tunnel)
- 2. Location is: 3 m. 1.5 North East Central Point
(Approximate distance and direction from nearest city or town)

and is more particularly described as follows:

(a) Approx. 300 ft. South of NE corner of the SW 1/4 of SW 1/4
(Give distance and bearing to corner of section or other legal subdivision)
being within SW 1/4 SW 1/4 of Sec. 30, Twp. 36 S, Rge. 1 W
(Smallest legal subdivision) (N. or S.) (E. or W.)

or (b) within limits of recorded platted property, town or city:

in Lot _____, Block _____ of _____
(Name of plat or addition)

County of Jackson
(If within city or town, give name)

3. Construction Work was begun on September 1953; was completed on October 1953
(Date) (Date)
and the ground water claimed was first used for the purposes set out below on October 1953
(Date)
since which time the water has been used Continuously through irrigation season
(Continuously or Intermittently) (As noted)
from Oct 1953 to present
(Date) (Date)

4. Quantity of water claimed and used is 13.6 gallons per minute; _____ acre feet per year.

5. Purpose or Purposes for which water is used irrigation
(Domestic, irrigation, municipal, manufacturing, industrial, etc.)

6. Description of Well: Depth 88 feet. Type Drilled
(Dug or drilled)
diameter 6 inches. Elevation of ground at well site _____ feet, mean sea level.
(As near as known)
Depth to water table 1.5 feet.

7. Capacity of Well: 13.6 g.p.m. with _____ feet drawdown.
_____ g.p.m. with _____ feet drawdown.

Date of test Oct 1953

If Flowing Well: Measured discharge _____ g.p.m. on _____
(Date)

Shut-in pressure at ground surface _____ lbs. per sq. in. on _____
(Date)

Water is controlled by _____
(Cap. valve, etc.)

8. Casing: (Give diameter, commercial specifications and depth below ground surface of each casing size.)

4 inch diameter heavy gauge from 0 to 88 feet
inch diameter from to feet
inch diameter from to feet
inch diameter from to feet

Describe and show depth of shoe, plug, adapter, liner or other details:
.....
.....

9. Perforated Casings or Screens:

perforated from to
(Number per foot and size of perforations, or describe screen)
from to
from to
from to

10. Log of Well: (Describe each stratum or formation clearly, indicate if water bearing, and give thickness and depth as indicated.)

MATERIAL	Thickness (Feet)	Depth to Bottom (Feet)

If log of well is not available, give name and address of driller.

11. Infiltration Trench: Covered or open

Dimensions: Length ft. Minimum depth ft. Maximum depth ft.

Bottom width ft. Discharge g.p.m. Date of test

12. Tunnel: Type of lining

Dimensions: (Length, course, and cross sectional size)

Position of water bearing stratum with reference to portal of tunnel

Log of tunnel: (Preceding table for log of well may be used, if desired. Give footage from portal and character of materials, as pertinent.)

13. Pumping Equipment:

(a) Pump Turbine 2" Capacity 136 g.p.m.

(Make, type and size)

(b) Motor Portable Gas 7 HP

(Type and horsepower)

14. Location of area irrigated or to be irrigated, or place of use if for purposes other than irrigation.

Township North or South	Range E. or W. of Williamsite Meridian	Section	Forty-acre Tract	Number Acres To Be Irrigated	Date of Reclamation
36 S	1 W	30	NE 1/4 SW 1/4	8 ⁰	Oct 1953
			SE 1/4 SW 1/4	17 ⁰	
				25 ⁰	

15. If the ground water supply is supplemental to an existing water supply, identification of any application for a permit, permit, certificate or adjudicated right to appropriate water made or held by the registrant.

Township 36 S Range 1 W W.M.
North

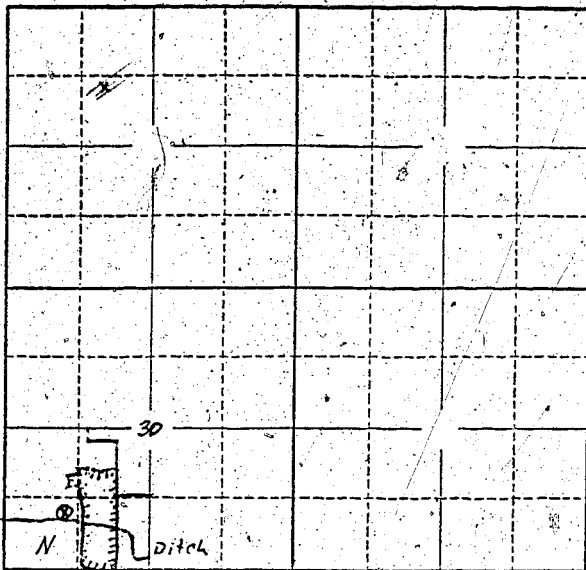

See 30

Locate well and acreage of irrigated land on plat.
Scale: 2" = 1 Mile

STATE OF OREGON

County of JACKSON } ss.

I, CLYDE CRENSHAW, being first duly sworn, do hereby certify that I have read the foregoing Registration Statement and that all of the items therein contained are true to the best of my knowledge and belief.

Clyde Crenshaw
(Signature of Registrant)

Subscribed and sworn to before me this 23 day of May, 1958.

My commission expires Sept. 10, 1961

F. J. Miller
(Notary Public)

(SEAL)

CERTIFICATE OF REGISTRATION

STATE OF OREGON

County of Marion } ss.

This is to certify that the foregoing Registration Statement was received in the office of the State Engineer on the 26th day of May, 1958, at 8:00 o'clock A. M. and has been duly recorded in said office in Book No. 7 of Registration Statements on page GR-1560

Witness my hand this 1st day of December, 1958.

Elmer A. Stankis
(State Engineer)

By _____
(Deputy)

\$15.00