

Registration No. GR. 1621

Certificate No. GR. 1579

# Registration Statement

## OF CLAIMANT OF RIGHT TO APPROPRIATE GROUND WATER

TO THE STATE ENGINEER OF OREGON:

I, Henry J. Neiger  
of Route 1 Box 447 Salem County of Polk  
(Mailing address)

State of Oregon, do hereby make application for a certificate of registration as evidence of a right to appropriate ground water.

1. Source from which water is withdrawn is PUMP  
(Flowing well, pump well, infiltration trench, or tunnel)

2. Location is: 6 1/2 miles N.W. of Salem  
(Approximate distance and direction from nearest city or town)

and is more particularly described as follows: 2800ft. West & 100ft. North from NE Cor. Sec. 29.

(a) S 26° 30' E 1600 ft. from S.E. Cor. of C.C. Walker D.L.C.  
(Give distance and bearing to corner of section or other legal subdivision)

being within NW 1/4 NE 1/4 of Sec. 29, Twp. 6S Rge. 3W  
(Smallest legal subdivision) (N. or S.) (E. or W.)

or (b) within limits of recorded platted property, town or city:

in Lot \_\_\_\_\_, Block \_\_\_\_\_ of \_\_\_\_\_  
(Name of plat or addition)

County of \_\_\_\_\_  
(If within city or town, give name)

3. Construction Work was begun on 1942; was completed on 1942  
(Date) (Date)

and the ground water claimed was first used for the purposes set out below on 1942  
(Date)

since which time the water has been used Continuously  
(Continuously or intermittently)

from 1942 to 1955  
(Date) (Date)

4. Quantity of water claimed and used is 200 gallons per minute; \_\_\_\_\_ acre feet per year.

5. Purpose or Purposes for which water is used Irrigation

(Domestic, irrigation, municipal, manufacturing, industrial, etc.)

6. Description of Well: Depth 89 feet. Type Hand-dug  
(Dug or drilled)

diameter 5 inches. Elevation of ground at well site 52 feet, mean sea level.  
(As near as known)

Depth to water table 3-2 feet.

7. Capacity of Well: \_\_\_\_\_ g.p.m. with \_\_\_\_\_ feet drawdown.

\_\_\_\_\_ g.p.m. with \_\_\_\_\_ feet drawdown.

Date of test 7-27-52

If Flowing Well: Measured discharge \_\_\_\_\_ g.p.m. on \_\_\_\_\_  
(Date)

Shut-in pressure at ground surface \_\_\_\_\_ lbs. per sq. in. on \_\_\_\_\_  
(Date)

Water is controlled by \_\_\_\_\_  
(Cap, valve, etc.)





Township 6 S Range 3 W, W.M.  
North

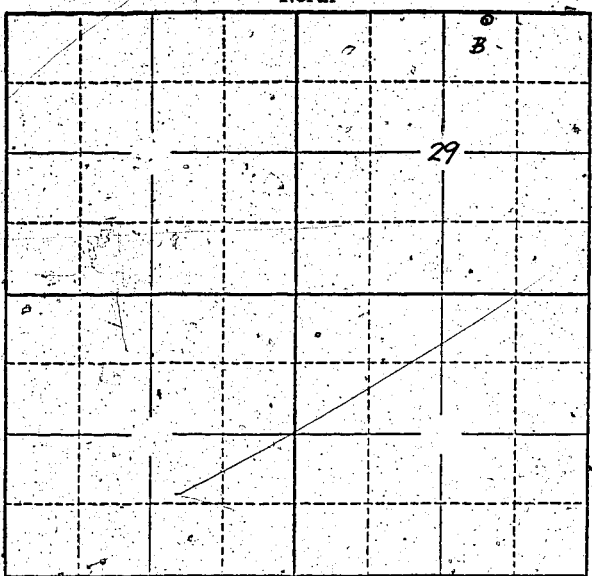

Locate well and acreage of irrigated land on plat.  
Scale: 2" = 1 Mile

STATE OF OREGON

County of Marion } ss.

I, Henry J. Nizer, being first duly sworn, do hereby certify that I have read the foregoing Registration Statement and that all of the items therein contained are true to the best of my knowledge and belief.

Henry J. Nizer  
(Signature of Registrant)

Subscribed and sworn to before me this 28th day of May, 1958

My commission expires 12th June 1961 Wm. S. Bartholmes  
(Notary Public)

(SEAL)

**CERTIFICATE OF REGISTRATION**

STATE OF OREGON

County of Marion } ss.

This is to certify that the foregoing Registration Statement was received in the office of the State Engineer on the 28th day of May, 1958, at 11:00 o'clock A. M. and has been duly recorded in said office in Book No. 7 of Registration Statements on page GR-1579

Witness my hand this 1st day of December 1958

Leura A. Stanley  
(State Engineer)

By \_\_\_\_\_  
(Deputy)

\$15.00

GR 1579