

RECEIVED  
APR 23 1956  
STATE ENGINEER  
SALEM, OREGON

Registration Statement

REGISTRATION NO. GR-163  
CERTIFICATE NO. GR-156

OF CLAIMANT OF RIGHT TO APPROPRIATE GROUND WATER

(Under Chapter 708, Oregon Laws 1955.)

TO THE STATE ENGINEER OF OREGON:

I, Charles C. Martin  
of 1435 N.W. Connell Ave Hillsboro County of Washington

State of Oregon do hereby make application for a certificate of registration as evidence of a right to appropriate ground water.

1. Source from which water is withdrawn is pump well  
(Flowing well, pump well, infiltration trench, or tunnel)

2. Location is: Approx 700' N. City limits of Hillsboro, SW 1/4 NE 1/4 Sec 36 TWP 1N R 3W WM  
(Approximate distance and direction from nearest city or town)

and is more particularly described as follows:

(a) N 10° 40' W a distance of 772' from SW Corner A. Kelsey DIC  
(Give distance and bearing to corner of section or other legal subdivision)

being within S 1/4 NE 1/4 of Sec. 36, Twp. 1N, Rge. 3W  
(Smallest legal subdivision) (N. or S.) (E. or W.)

or (b) within limits of recorded platted property, town or city:

in Lot \_\_\_\_\_, Block \_\_\_\_\_ of \_\_\_\_\_  
(Name of plat or addition)

County of \_\_\_\_\_  
(If within city or town, give name)

3. Construction Work was begun on Aug 5 1948; was completed on Aug 19 1948  
(Date) (Date)

and the ground water claimed was first used for the purposes set out below on Aug 24 1948  
(Date)

since which time the water has been used Continuously for household and during summer for irrigation  
(Continuously or Intermittently)

from May to Sept Each Year for irrigation.  
(Date) (Date)

4. Quantity of water claimed and used is 66 63 gallons per minute; 7188 2.01 acre feet per year.

Note This is figured for the 16 acres

5. Purpose or Purposes for which water is used Irrigation and domestic use

(Domestic; irrigation, municipal, manufacturing, industrial, etc.)

6. Description of Well: Depth 50 feet, Type Drilled  
(Dug or drilled)

diameter 6 inches. Elevation of ground at well site 200 feet, mean sea level.  
(As near as known)

Depth to water table 30 feet.

7. Capacity of Well: 85 g.p.m. with 35 feet drawdown.

\_\_\_\_\_ g.p.m. with \_\_\_\_\_ feet drawdown.

Date of test Aug 1948

If Flowing Well: Measured discharge \_\_\_\_\_ g.p.m. on \_\_\_\_\_  
(Date)

Shut-in pressure at ground surface \_\_\_\_\_ lbs. per sq. in. on \_\_\_\_\_  
(Date)

Water is controlled by \_\_\_\_\_  
(Cap, valve, etc.)





Township 1 N Range 3 W, W.M.  
North

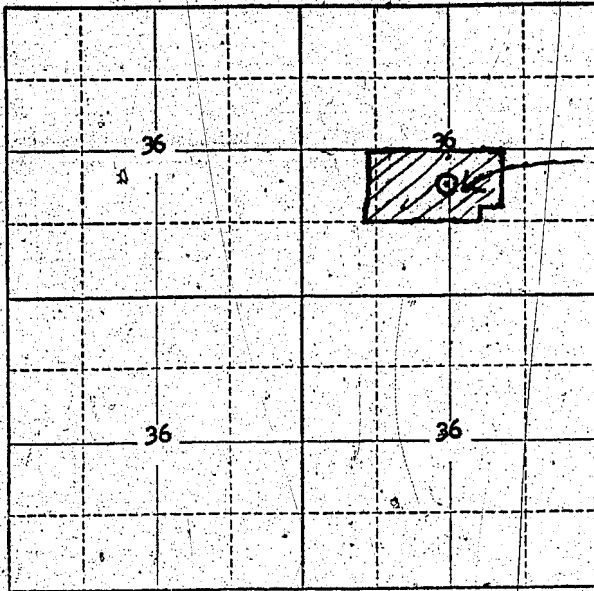

Locate well and acreage of irrigated land on plat.  
Scale: 4" = 1 Mile

STATE OF OREGON

County of Washington } ss.

I, Charles P. Martin, being first duly sworn, do hereby certify that I have read the foregoing Registration Statement and that all of the items therein contained are true to the best of my knowledge and belief.

Charles P. Martin  
(Signature of Registrant)

Subscribed and sworn to before me this 16<sup>th</sup> day of July, 1956.

My commission expires 10/7/56 L. Howard Lewis  
(Notary Public)

(SEAL)

**CERTIFICATE OF REGISTRATION**

STATE OF OREGON

County of Marion } ss.

This is to certify that the foregoing Registration Statement was received in the office of the State Engineer on the 23rd day of April, 1956, at 9:30 o'clock A. M. and has been duly recorded in said office in Book No. 1 of Registration Statements on page GR-156 C

~~Construction shall be completed by \_\_\_\_\_ and the water completely applied to beneficial use by \_\_\_\_\_~~

Witness my hand this 8th day of October, 1956

Lewis A. Stanley  
(State Engineer)

By \_\_\_\_\_  
(Deputy)

GR-156 C