

RECEIVED
C. T. Hamilton
4824 Gebhard Road
Central Point, Oregon
MAY 20 1955
STATE ENGINEER
SALE REGISTRATION

GR-1632
REGISTRATION NO. _____
CERTIFICATE NO. 1597

Registration Statement

OF CLAIMANT OF RIGHT TO APPROPRIATE GROUND WATER

(Under Chapter 708, Oregon Laws 1955.)

TO THE STATE ENGINEER OF OREGON:

I, C. T. Hamilton
of Central Point, County of Jackson

State of Oregon, do hereby make application for a certificate of registration as evidence of a right to appropriate ground water.

1. Source from which water is withdrawn is Irrigation Well
(Flowing well, pump well, infiltration trench, or tunnel)
2. Location is: One mile Northeast of Central Point, Oregon
(Approximate distance and direction from nearest city or town)

and is more particularly described as follows:

(a) 500 feet west of NE corner of DLC No. 55, in T 37, - S. Range 2 West, WM.
(Give distance and bearing to corner of section or other legal subdivision)
being within NW 1/4 of NW 1/4 of Sec. 1, Twp. 37 So., Rge. 2 West
(Smallest legal subdivision) (N. or S.) (E. or W.)

or (b) within limits of recorded platted property, town or city:

in Lot _____, Block _____ of _____
(Name of plat or addition)
County of _____
(If within city or town, give name)

3. Construction Work was begun on 1914; was completed on about 1914.
(Date) (Date)

and the ground water claimed was first used for the purposes set out below on about 1914,
(Date)

since which time the water has been used Continuously
(Continuously or intermittently)

from 1914 to 1957.
(Date) (Date)

4. Quantity of water claimed and used is 100 To irrigate when needed. _____ acre feet per year. _____ gallons per minute;

5. Purpose or Purposes for which water is used Irrigation

(Domestic, irrigation, municipal, manufacturing, industrial, etc.)

6. Description of Well: Depth 14 feet. Type sa dug
(Dug or drilled)

diameter 7 by 14 feet inches. Elevation of ground at well site 1230 feet, mean sea level.
(As near as known)

Depth to water table eight feet.

7. Capacity of Well: 100 g.p.m. with 6 feet drawdown. Estimate. We operate 10
_____ g.p.m. with _____ feet drawdown. sprinkler heads.

Date of test _____

If Flowing Well: Measured discharge _____ g.p.m. on _____
(Date)

Shut-in pressure at ground surface _____ lbs. per sq. in. on _____
(Date)

Water is controlled by _____
(Cap, valve, etc.)

8. Casing: (Give diameter, commercial specifications and depth below ground surface of each casing size.)

..... inch diameter from to feet
 inch diameter from to feet
 inch diameter from to feet
 inch diameter from to feet

Describe and show depth of shoe, plug, adapter, liner or other details:

9. Perforated Casings or Screens:

..... from to
(Number per foot and size of perforations, or describe screen)
 from to
 from to
 from to

10. Log of Well: (Describe each stratum or formation clearly, indicate if water bearing, and give thickness and depth as indicated.)

MATERIAL	Thickness (Feet)	Depth to Bottom (Feet)
<p>This well is about 17 ft in depth about 6 ft x 12 ft. Dug approx 50-55 years ago. Has been concreted bottom to top (cannot describe different layers of soil etc.)</p>		

If log of well is not available, give name and address of driller:

Dug by J. C. Barnett, then owner of property, in about 1914. Decided abandoned

11. Infiltration Trench: Covered or open

Dimensions: Length 10' ft. Minimum depth 17' ft. Maximum depth ft.

Bottom width 10' ft. Discharge g.p.m. Date of test

12. Tunnel: Type of lining Concrete top to bottom

Dimensions:
(Length, course, and cross sectional size)

Position of water bearing stratum with reference to portal of tunnel

Log of tunnel: (Preceding table for log of well may be used, if desired. Give footage from portal and character of materials, as pertinent.)

13. Pumping Equipment:

(a) Pump 2 Briggs & Stratton each 4" and 2" Capacity 120 g.p.m.
(Make, type and size)

(b) Motor Five HP., supposed to operate 10 sprinkler heads, Briggs-Stratton
engine; plan to install electric outfit.
(Type and horsepower)

14. Location of area irrigated or to be irrigated, or place of use if for purposes other than irrigation.

Township North or South	Range E. or W. of Willamette Meridian	Section	Forty-acre Tract	Number Acres To Be Irrigated	Date of Reclamation
37 S	West 2	2	NE 1/4 of NE 1/4	16	When Indians left. 1914
37 S	2 W	2	NE 1/4 of NE 1/4	16 ⁰	1914
"	"	1	NW 1/4 of NW 1/4	4 ⁰	"
				<u>20⁰ Ac Total</u>	"

15. If the ground water supply is supplemental to an existing water supply, identification of any application for a permit, permit, certificate or adjudicated right to appropriate water made or held by the registrant.

567.6 x 1547.7

Acreage involved is rectangular, 567.6 feet by 1547.7 feet.

Sections 1 and 2 Township 37S Range 2 West, W.M.

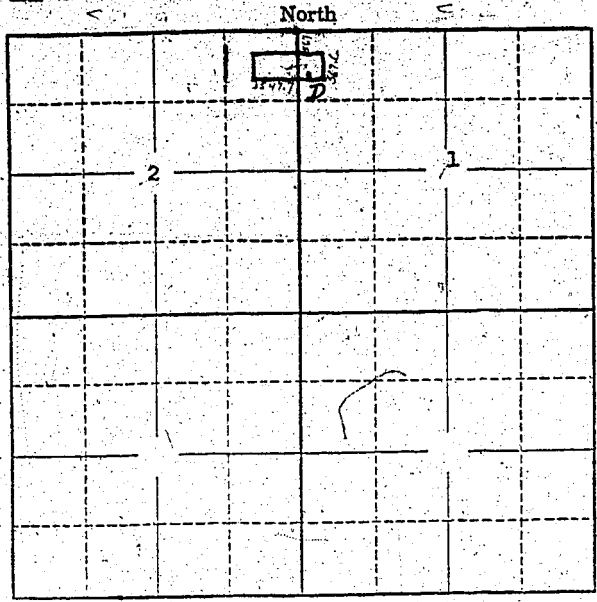

Red dot indicates location of well.

Locate well and acreage of irrigated land on plat. Scale: 2" = 1 Mile

STATE OF OREGON }
County of Jackson } ss.

I, C. T. Hamilton, being first duly sworn, do hereby certify that I have read the foregoing Registration Statement and that all of the items therein contained are true to the best of my knowledge and belief.

X *C. T. Hamilton*
(Signature of Registrant)

Subscribed and sworn to before me this 9 day of July, 1957

My commission expires Nov 28 1966 *Walter Mc Ferguson*
(Notary Public)

(SEAL)

CERTIFICATE OF REGISTRATION

STATE OF OREGON }
County of Marion } ss.

This is to certify that the foregoing Registration Statement was received in the office of the State Engineer on the 29th day of May, 1958, at 7:00 o'clock A.M. and has been duly recorded in said office in Book No. 7 of Registration Statements on page GR-1597

~~Construction shall be completed by 1958 and the water completely applied to beneficial use by 1958.~~

Witness my hand this 7th day of January, 1959

Flora A. ...
(State Engineer)

\$15.00

By _____ (Deputy)

GR-1597