

RECEIVED  
 APR 12 1955  
 STATE ENGINEER  
 SALEM, OREGON

**Registration Statement**

**OF CLAIMANT OF RIGHT TO APPROPRIATE GROUND WATER**

**TO THE STATE ENGINEER OF OREGON:**

I, James F. and Hazel M. Myers

of 2829 Table Rock Road, Medford County of Jackson

(Mailing address)

State of Oregon, do hereby make application for a certificate of registration as evidence of a right to appropriate ground water.

1. Source from which water is withdrawn is pump well

(Flowing well, pump well, infiltration trench, or tunnel)

2. Location is: approximately 1 mile north of Medford, Oregon (Big-Y)

(Approximate distance and direction from nearest city or town)

and is more particularly described as follows:

(a) 1810 feet north and 1905 feet East from the SW corner DIC #59

(Give distance and bearing to corner of section or other legal subdivision)

being within NE 1/4 NW 1/4 of Sec. 13, Twp. 37 S., Rge. 2 W.

(Smallest legal subdivision)

(N. or S.)

(E. or W.)

or (b) within limits of recorded platted property, town or city:

in Lot \_\_\_\_\_, Block \_\_\_\_\_ of \_\_\_\_\_

(Name of plat or addition)

County of \_\_\_\_\_

(If within city or town, give name)

3. Construction Work was begun on April 6, 1955; was completed on April 6, 1955

(Date)

(Date)

and the ground water claimed was first used for the purposes set out below on April 28, 1955

(Date)

since which time the water has been used continuously

(Continuously or intermittently)

from Apr. 28, 1955 to \_\_\_\_\_ date \_\_\_\_\_

(Date)

(Date)

4. Quantity of water claimed and used is 55 gallons per minute; 1 1/2 acre feet per year.

5. Purpose or Purposes for which water is used irrigation

(Domestic, irrigation, municipal, manufacturing, industrial, etc.)

6. Description of Well: Depth 13 feet. Type CUG

(Dug or drilled)

diameter 30 inches. Elevation of ground at well site 1205 feet, mean sea level.

(As near as known)

Depth to water table 4 feet.

7. Capacity of Well: \_\_\_\_\_ g.p.m. with \_\_\_\_\_ feet drawdown.

\_\_\_\_\_ g.p.m. with \_\_\_\_\_ feet drawdown.

Date of test none

If Flowing Well: Measured discharge \_\_\_\_\_ g.p.m. on \_\_\_\_\_

(Date)

Shut-in pressure at ground surface \_\_\_\_\_ lbs. per sq. in. on \_\_\_\_\_

(Date)

Water is controlled by \_\_\_\_\_

(Cap. valve, etc.)





Township 37 S. Range 2 W. W.M.

North

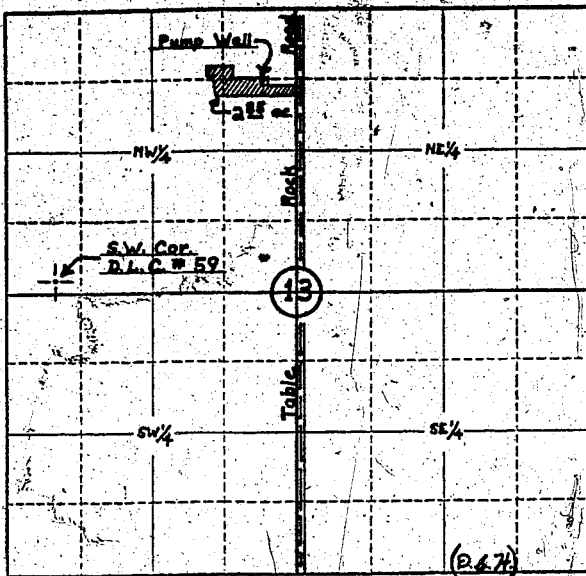

Locate well and acreage of irrigated land on plat.

Scale: 4" = 1 Mile

STATE OF OREGON

County of Jackson

ss.

We, James F. Myers and Hazel M. Myers, being first duly sworn, do hereby certify that I have read the foregoing Registration Statement and that all of the items therein contained are true to the best of my knowledge and belief.

*James F. Myers*  
*Hazel M. Myers*  
 (Signature of Registrant)

Subscribed and sworn to before me this 26th day of May, 1958.

My commission expires August 25, 1958.

*Alfred P. [Signature]*  
 (Notary Public)

(SEAL)

CERTIFICATE OF REGISTRATION

STATE OF OREGON

County of Marion

ss.

This is to certify that the foregoing Registration Statement was received in the office of the State Engineer on the 2nd day of June, 1958, at 8:00 o'clock A.M. and has been duly recorded in said office in Book No. 7 of Registration Statements on page GR-1601

Witness my hand this 7th day of January, 1959.

*Arthur A. Stanley*  
 (State Engineer)

\$15.00

By

(Deputy)

GR 1601