

#2 RECEIVED OCT 27 1961 STATE ENGINEER DEPT. OREGON

Registration No. GR 1616
Certificate No. GR 4111

Registration Statement

OF CLAIMANT OF RIGHT TO APPROPRIATE GROUND WATER

TO THE STATE ENGINEER OF OREGON:

I, CHENOWETH IRRIGATION COOPERATIVE, Inc.

of P. O. Box No. 800 County of Wasco

State of Oregon, do hereby make application for a certificate of registration as evidence of a right to appropriate ground water.

1. Source from which water is withdrawn is Pump well
(Flowing well, pump well, infiltration trench, or tunnel)

2. Location is: One Mile Westerly of The Dalles, Oregon
(Approximate distance and direction from nearest city or town)

and is more particularly described as follows:

(a) 375 feet South and 350 feet West of the one quarter corner between Section 32 and Section 33
(Give distance, and bearing to corner of section or other legal subdivision)

being within NE 1/4 of the SW 1/4 of Sec. 32, Twp. 2 North, Rge. 13 East,
(Smallest legal subdivision) (N. or S.) (E. or W.)

or (b) within limits of recorded platted property, town or city:

in Lot _____, Block _____ of _____
(Name of plat or addition)

County of _____
(If within city or town, give name)

3. Construction Work was begun on Drilling date of No. 2 Well About Jan. 1949; was completed on About April 1949
(Date) (Date)

and the ground water claimed was first used for the purposes set out below on May 1949
(Date)

since which time the water has been used Continuously
(Continuously or intermittently)

from May 1949 to date
(Date) (Date)

4. Quantity of water claimed and used is 200-300 gallons per minute; _____ acre feet per year.

5. Purpose or Purposes for which water is used Group Domestic
O.K. S. N. M. P.
(Domestic, irrigation, municipal, manufacturing, industrial, etc.)

6. Description of Well: Depth 260 feet. Type Drilled
(Dug or drilled)

10" at top-8 inches at bottom diameter _____ inches. Elevation of ground at well site approx. 158 feet, mean sea level.
(As near as known)

Depth to water table 86 feet.

7. Capacity of Well: 700 g.p.m. with one feet drawdown.
_____ g.p.m. with _____ feet drawdown.

Date of test About June 1949

If Flowing Well: Measured discharge _____ g.p.m. on _____
(Date)

Shut-in pressure at ground surface _____ lbs. per sq. in. on _____
(Date)

Water is controlled by _____
(Cap, valve, etc.)

8. Casing: (Give diameter, commercial specifications and depth below ground surface of each casing size.)

10 ID inch diameter from 0 to 21½ feet
 inch diameter from to feet
 inch diameter from to feet
 inch diameter from to feet

Describe and show depth of shoe, plug, adapter, liner or other details:

9. Perforated Casings or Screens:

..... from to
 (Number per foot and size of perforations, or describe screen)
 from to
 from to
 from to

10. Log of Well: (Describe each stratum or formation clearly, indicate if water bearing, and give thickness and depth as indicated.)

MATERIAL	Thickness (Feet)	Depth to Bottom (Feet)
----------	------------------	------------------------

LOG OF WELL NO. 2

Surface to	9½ ft.	Sand, gravel. Surface water
9½ ft. to	12 ft.	Broken rock.
12	to 36 ft.	Basalt, grey, hard.
36	to 44 ft.	Basalt, brown, hard.
44	to 50 ft.	Basalt, grey, hard.
50	to 69 ft.	Blue clay, black rock & water crystals, seep water.
69	to 81 ft.	Basalt, grey.
81	to 89 ft.	Basalt, grey, hard.
89	to 110 ft.	Basalt, black, blue clay and water crystals
110	to 126 ft.	Blue clay, black basalt.
126	to 169 ft.	Basalt, black.
169	to 174 ft.	Basalt, black, hard.
174	to 229 ft.	Basalt, grey, hard (at 210 water level dropped from 55 feet to 87½ feet from surface. All formation from 69 to 174 feet slanting and V.B.D.)
229	to 231 ft.	Basalt, black, hard.
231	to 241 ft.	Basalt, black and red porous honeycomb. Water bearing - source of supply for well.
241	to 249 ft.	Basalt, black.
249	to 260 ft.	Basalt, grey, hard.

If log of well is not available, give name and address of driller.

11. Infiltration Trench: Covered or open

Dimensions: Length ft. Minimum depth ft. Maximum depth ft.

Bottom width ft. Discharge g.p.m. Date of test

12. Tunnel: Type of lining

Dimensions:
(Length, course, and cross sectional size)

Position of water bearing stratum with reference to portal of tunnel

Log of tunnel: (Preceding table for log of well may be used, if desired. Give footage from portal and character of materials, as pertinent.)

13. Pumping Equipment:

(a) Pump Cook Pump Capacity 300 g.p.m.
(Make, type and size)

(b) Motor General Electric 30 hp; and auxillary gas Ford motor 94hp
(Type and horsepower)

14. Location of area irrigated or to be irrigated, or place of use if for purposes other than irrigation.

Township	Range	Section	Forty-acre Tract	
2N	13E	29	NW 1/4	SW 1/4
2N	13E	29	SW 1/4	SW 1/4
2N	13E	29	NE 1/4	SW 1/4
2N	13E	29	SE 1/4	SW 1/4
2N	13E	29	NW 1/4	SE 1/4
2N	13E	29	SW 1/4	SE 1/4
2N	13E	29	NE 1/4	SE 1/4
2N	13E	29	SE 1/4	SE 1/4
2N	13E	28	SW 1/4	SW 1/4
2N	13E	32	NE 1/4	NW 1/4
2N	13E	32	SE 1/4	NW 1/4
2N	13E	32	NW 1/4	NE 1/4
2N	13E	32	SW 1/4	NE 1/4
2N	13E	32	NE 1/4	NE 1/4
2N	13E	32	SE 1/4	NE 1/4
2N	13E	32	NW 1/4	SE 1/4
2N	13E	32	SW 1/4	SE 1/4
2N	13E	32	NE 1/4	SE 1/4
2N	13E	32	SE 1/4	SE 1/4
2N	13E	33	NW 1/4	NW 1/4
2N	13E	33	SW 1/4	NW 1/4
2N	13E	33	NW 1/4	SW 1/4
2N	13E	33	SE 1/4	NW 1/4
2N	13E	33	NE 1/4	SW 1/4
2N	13E	33	SE 1/4	SW 1/4
1N	13E	5	NE 1/4	NE 1/4
1N	13E	4	NE 1/4	NW 1/4
1N	13E	4	NE 1/4	NW 1/4
1N	13E	4	SE 1/4	NW 1/4

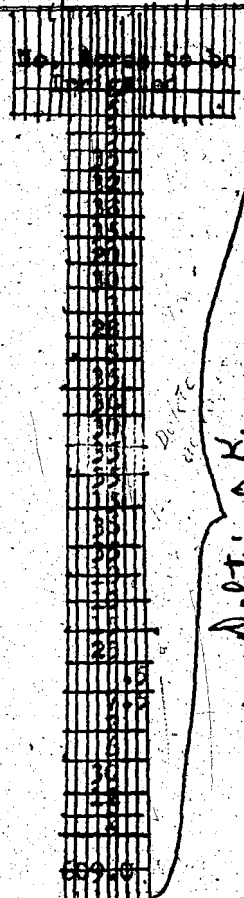

*Deletion O.K.
Geo. W. McWayland
President*

This registration statement is not to be considered in any way a waiver of any rights under previous applications, or a waiver of any other rights. This statement is in addition to and supplemental to all other applications on file.

15. If the ground water supply is supplemental to an existing water supply, identification of any application for a permit, permit, certificate or adjudicated right to appropriate water made or held by the registrant.
Permit No. U-184, Application No. U-203; and Permit No. G-294
and File No. G-33

Township 2 North Range 13 East, W.M.

North

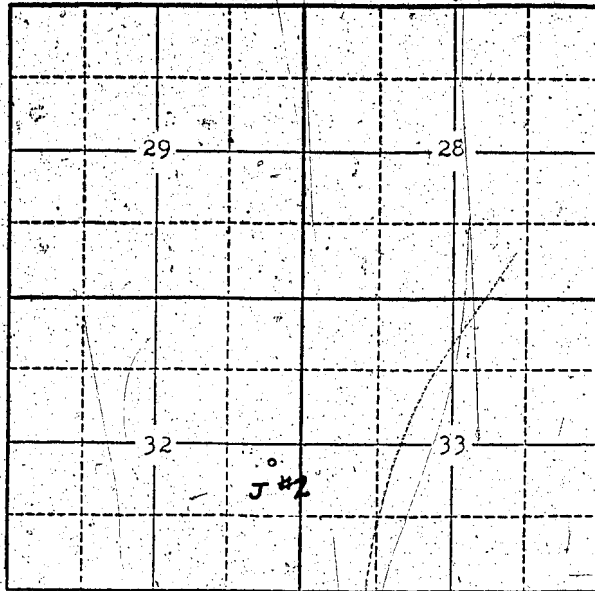

Locate well and acreage of irrigated land on plat.

Scale: 2" = 1 Mile

STATE OF OREGON

County of Wasco } ss.

I, GEORGE N. McDONALD, PRESIDENT OF CHENOWETH IRRIGATION COOPERATIVE, Inc., being first duly sworn, do hereby certify that I have read the foregoing Registration Statement and that all of the items therein contained are true to the best of my knowledge and belief.

Geo. N. McDonald, President (Signature of Registrant)

Subscribed and sworn to before me this 22nd day of May, 1958

My commission expires January 15, 1962.

David E. Hunter (Notary Public)

(SEAL)

CERTIFICATE OF REGISTRATION

STATE OF OREGON } ss. County of Marion

This is to certify that the foregoing Registration Statement was received in the office of the State Engineer on the 11th day of October, 1961, at 8:20 o'clock A.M. and has been duly recorded in said office in Book No. 17 of Registration Statements on page GR-1111

Witness my hand this 30th day of October, 1961

Levia A. Stanley (State Engineer)

\$ 20.00

By GR-4111 (Deputy) GR- [redacted]