

Registration Statement

OF CLAIMANT OF RIGHT TO APPROPRIATE GROUND WATER

TO THE STATE ENGINEER OF OREGON:

I, LLOYD H. HOUGE

of RT 3 BOX 104 CANBY ORE County of CLATSOP
(Mailing address)

State of _____, do hereby make application for a certificate of registration as evidence of a right to appropriate ground water.

1. Source from which water is withdrawn is PUMP WELL
(Flowing well, pump well, infiltration trench, or tunnel)

2. Location is: 3 - M. S. 1 MI. W. OF CANBY
(Approximate distance and direction from nearest city or town)

and is more particularly described as follows:

(a) WELL 480' E + 1650' S FROM NW CORNER
(Give distance and bearing to corner of section or other legal subdivision)

being within SW 1/4 of NW 1/4 of Sec. 9, Twp. 4-S, Rge. 1-E
(Smallest legal subdivision) (N. or S.) (E. or W.)

or (b) within limits of recorded platted property, town or city: _____

in Lot _____, Block _____ of _____
(Name of plat or addition)

County of _____
(If within city or town, give name)

3. Construction Work was begun on 11-1-1957; was completed on _____
(Date) (Date)

and the ground water claimed was first used for the purposes set out below on June 15, 1954
(Date)

since which time the water has been used INTERMITTENTLY
(Continuously or intermittently)

from June 15, 1954 to Oct. 1957
(Date) (Date)

4. Quantity of water claimed and used is 92 gallons per minute; _____ acre feet per year.

5. Purpose or Purposes for which water is used IRRIGATION

(Domestic, irrigation, municipal, manufacturing, industrial, etc.)

6. Description of Well: Depth 14 feet. Type PUMP
(Dug or drilled)

diameter 4.2 inches. Elevation of ground at well site _____ feet, mean sea level.

(As near as known)

Depth to water table 7 feet.

7. Capacity of Well: 92 g.p.m. with 3 feet drawdown.

_____ g.p.m. with _____ feet drawdown.

Date of test _____

If Flowing Well: Measured discharge _____ g.p.m. on _____
(Date)

Shut-in pressure at ground surface _____ lbs. per sq. in. on _____
(Date)

Water is controlled by _____
(Cap, valve, etc.)

Township 4S Range 1E W.M.
North

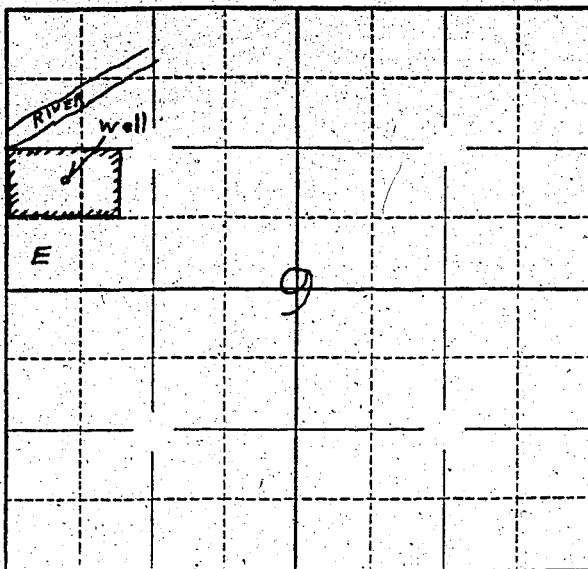

Locate well and acreage of irrigated land on plat.
Scale: 2" = 1 Mile

STATE OF OREGON

County of Marion } ss.

I, Floyd H. Hauge, being first duly sworn, do hereby certify that I have read the foregoing Registration Statement and that all of the items therein contained are true to the best of my knowledge and belief.

Floyd H. Hauge
(Signature of Registrant)

Subscribed and sworn to before me this 6th day of June, 1958.

My commission expires 12th June 1961

Wm. S. Bartholmeus
(Notary Public)

(SEAL)

CERTIFICATE OF REGISTRATION

STATE OF OREGON } ss.
County of Marion

This is to certify that the foregoing Registration Statement was received in the office of the State Engineer on the 6th day of June, 1958, at 10:30 o'clock A.M. and has been duly recorded in said office in Book No. 7 of Registration Statements on page GR-1609.

Witness my hand this 7th day of January, 1959.

Lewis A. Stanley
(State Engineer)

By _____ (Deputy)

\$1,500

GR-1609