

Registration Statement

OF CLAIMANT OF RIGHT TO APPROPRIATE GROUND WATER

TO THE STATE ENGINEER OF OREGON:

1- Harry and David, an Oregon Corporation

of P. O. Box 712, Medford County of Jackson

(Mailing address)

State of Oregon, do hereby make application for a certificate of registration as evidence of a right to appropriate ground water.

1. Source from which water is withdrawn is pump well
(Flowing well, pump well, infiltration trench, or tunnel)

2. Location is: at the southern boundary of Medford, Oregon
(Approximate distance and direction from nearest city or town)

and is more particularly described as follows:

(a) 670 feet south and 1655 feet east from the NW corner DIC #85
(Give distance and bearing to corner of section or other legal subdivision)

being within SW $\frac{1}{4}$ NW $\frac{1}{4}$ of Sec. 31, Twp. 37 S., Rge. 1 W.
(Smallest legal subdivision) (N. or S.) (E. or W.)

or (b) within limits of recorded platted property, town or city:

in Lot _____, Block _____ of _____
(Name of plat or addition)

(If within city or town, give name)

County of _____

3. Construction Work was begun on May - 1942; was completed on May - 1942
(Date) (Date)

and the ground water claimed was first used for the purposes set out below on May - 1942
(Date)

since which time the water has been used intermittently
(Continuously or Intermittently)

from May 1942 to present
(Date) (Date)

4. Quantity of water claimed and used is 60 gallons per minute; _____ acre feet per year.

5. Purpose or Purposes for which water is used commercial (Orchard spraying)

(Domestic, irrigation, municipal, manufacturing, industrial, etc.)

6. Description of Well: Depth 14 feet. Type dug
(Dug or drilled)

diameter 36 inches. Elevation of ground at well site 1410 feet, mean sea level.
(As near as known)

Depth to water table 10 feet.

7. Capacity of Well: 60 g.p.m. with 3 feet drawdown.

_____ g.p.m. with _____ feet drawdown.

Date of test May 20, 1958

If Flowing Well: Measured discharge _____ g.p.m. on _____
(Date)

Shut-in pressure at ground surface _____ lbs. per sq. in. on _____
(Date)

Water is controlled by _____
(Cap, valve, etc.)

If log of well is not available, give name and address of driller. dug by Bear Creek Orchard Employees

11. Infiltration Trench: Covered or open _____

Dimensions: Length _____ ft. Minimum depth _____ ft. Maximum depth _____ ft.

Bottom width _____ ft. Discharge _____ g.p.m. Date of test _____

12. Tunnel: Type of lining _____

Dimensions: _____
(Length, course, and cross sectional size)

Position of water bearing stratum with reference to portal of tunnel _____

Log of tunnel: (Preceding table for log of well may be used, if desired. Give footage, from portal and character of materials, as pertinent.)

13. Pumping Equipment:

(a) Pump Pacific 1 1/2" centrifugal Capacity 60 g.p.m.
(Make, type and size)

(b) Motor G.E. 3/4 H.P., RPM 1725
(Type and horsepower)

14. Location of area irrigated or to be irrigated, or place of use if for purposes other than irrigation.

Township North or South	Range E. or W. of Willamette Meridian	Section	Forty-acre Tract	Number Acres To Be Irrigated	Date of Reclamation
37 S.	1 W.	31	SW 1/4 NW 1/4	Orchard Spraying	May 1942
"	"	31	SE 1/4 NW 1/4	Orchard Spraying	May 1942
"	"	31	N 1/2 NE 1/4 SW 1/4	Orchard Spraying	May 1942
"	"	31	N 1/2 NW 1/4 SW 1/4	Orchard Spraying	May 1942
37 S.	2 W.	36	E 1/2 SE 1/4 NE 1/4	Orchard Spraying	May 1942
"	"	36	NE 1/4 NE 1/4 SE 1/4	Orchard Spraying	May 1942

15. If the ground water supply is supplemental to an existing water supply, identification of any application for a permit, permit, certificate or adjudicated right to appropriate water made or held by the registrant.
 None.

Township 37S Range 1W W.M.
North

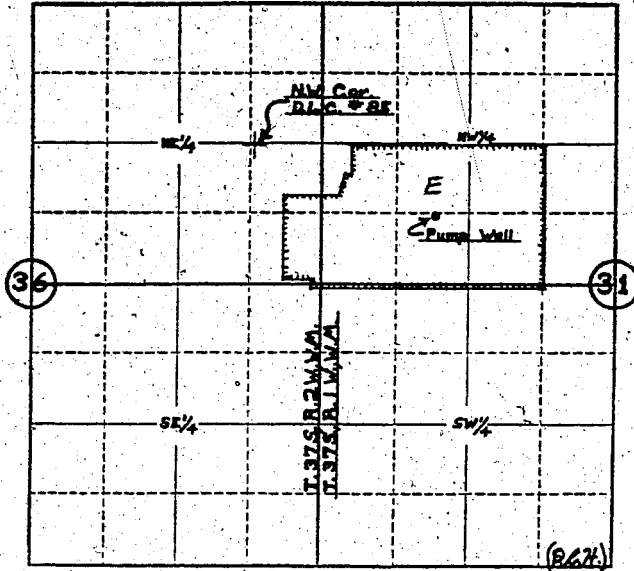

Locate well and acreage of irrigated land on plat.
Scale: 4" = 1 Mile

STATE OF OREGON

County of Jackson } ss.

I, G. A. Cottingham, being first duly sworn, do hereby certify that I have read the foregoing Registration Statement and that all of the items therein contained are true to the best of my knowledge and belief.

By: G. A. Cottingham
(Signature of Registrant) Secy-Treas.

Subscribed and sworn to before me this 5th day of June, 1958

NOTARY PUBLIC FOR OREGON

My commission expires My Commission Expires Feb. 8, 1961

G. H. Harrison
(Notary Public)

(SEAL)

CERTIFICATE OF REGISTRATION

STATE OF OREGON } ss.
County of Marion

This is to certify that the foregoing Registration Statement was received in the office of the State Engineer on the 9th day of June, 1958, at 2:00 o'clock A.M. and has been duly recorded in said office in Book No. 8 of Registration Statements on page GR-1632

Witness my hand this 7th day of January, 1959

\$ 20.⁰⁰

Lewis J. Stanley
(State Engineer)

By _____ (Deputy)