

Registration Statement

OF CLAIMANT OF RIGHT TO APPROPRIATE GROUND WATER

TO THE STATE ENGINEER OF OREGON:

I, Wilhelm A. Paulson

of Route 1, Box 28, Dayton County of Yamhill

(Mailing address)

State of Oregon, do hereby make application for a certificate of registration as evidence of a right to appropriate ground water.

1. Source from which water is withdrawn is pump well
(Flowing well, pump well, infiltration trench, or tunnel)

2. Location is: four miles southwest of Dayton
(Approximate distance and direction from nearest city or town)

and is more particularly described as follows:

(a) 501' North & 1772' East of SW corner Sec. 31, T4 S., R 3 W.
(Give distance and bearing to corner of section or other legal subdivision)

being within SE 1/4 of SW 1/4 of Sec. 31, Twp. 4 S., Rge. 3 W.
(Smallest legal subdivision) (N. or S.) (E. or W.)

or (b) within limits of recorded platted property, town or city:

in Lot _____, Block _____ of _____
(Name of plat or addition)

County of _____
(If within city or town, give name)

3. Construction Work was begun on July 1951; was completed on July 24, 1951
(Date) (Date)

and the ground water claimed was first used for the purposes set out below on Sept. 21, 1951
(Date)

since which time the water has been used Continuously
(Continuously or intermittently)

from Sept. 21, 1951 to present
(Date) (Date)

4. Quantity of water claimed and used is 126 gallons per minute; _____ acre feet per year.

5. Purpose or Purposes for which water is used irrigation

(Domestic, irrigation, municipal, manufacturing, industrial, etc.)

6. Description of Well: Depth 116 feet. Type drilled
(Dug or drilled)

diameter 8 inches. Elevation of ground at well site 137 feet, mean sea level.
(As near as known)

Depth to water table 20 feet.

7. Capacity of Well: 130 g.p.m. with 90 feet drawdown.

_____ g.p.m. with _____ feet drawdown.

Date of test Sept. 21, 1951

If Flowing Well: Measured discharge _____ g.p.m. on _____
(Date)

Shut-in pressure at ground surface _____ lbs. per sq. in. on _____
(Date)

Water is controlled by _____
(Cap, valve, etc.)

Township 4 S Range 3 W W.M.
North

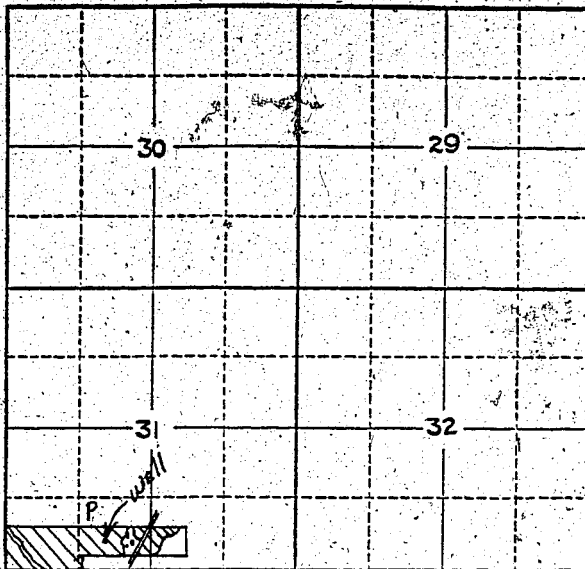

Locate well and acreage of irrigated land on plat.
Scale: 2" = 1 Mile

STATE OF OREGON

County of Yamhill } ss.

I, Wilhelm A. Parison, being first duly sworn, do hereby certify that I have read the foregoing Registration Statement and that all of the items therein contained are true to the best of my knowledge and belief.

Wilhelm A. Parison
(Signature of Registrant)

Subscribed and sworn to before me this 11th day of May, 1958

My commission expires October 28, 1961
Paul C. Parison
(Notary Public)

(SEAL)

CERTIFICATE OF REGISTRATION

STATE OF OREGON }
County of Marion } ss.

This is to certify that the foregoing Registration Statement was received in the office of the State Engineer on the 10th day of June, 1958, at 10:30 o'clock A.M. and has been duly recorded in said office in Book No. 8 of Registration Statements on page GR-1645

Witness my hand this 7th day of January, 1959
Henry A. Stanley
(State Engineer)

By _____
(Deputy)

GR -1645

16.65