

Registration Statement

OF CLAIMANT OF RIGHT TO APPROPRIATE GROUND WATER

TO THE STATE ENGINEER OF OREGON:

I, Thurman Barnes

of 1576 Beall Lane, Medford, County of Jackson

(Mailing address)

State of Oregon do hereby make application for a certificate of registration as evidence of a right to appropriate ground water.

1. Source from which water is withdrawn is pump well
(Flowing well, pump well, infiltration trench, or tunnel)

2. Location is: 1 mile South of Central Point, Oregon
(Approximate distance and direction from nearest city or town)

and is more particularly described as follows:

(a) 230 feet North and 3565 feet West from the SE corner DLC #54
(Give distance and bearing to corner of section or other legal subdivision)

being within NE¹ SE¹ SE¹ of Sec. 10, Twp. 37 S., Rge. 2 W.
(Smallest legal subdivision) (N. or S.) (E. or W.)

or (b) within limits of recorded platted property, town or city:

in Lot _____, Block _____ of _____
(Name of plat or addition)

County of _____
(If within city or town, give name)

3. Construction Work was begun on Aug. 1951; was completed on October 1951
(Date) (Date)

and the ground water claimed was first used for the purposes set out below on May 1952
(Date)

since which time the water has been used continuously
(Continuously or intermittently)

from May 1952 to date
(Date) (Date)

4. Quantity of water claimed and used is 25 gallons per minute; 14 acre feet per year.

5. Purpose or Purposes for which water is used irrigation

(Domestic, irrigation, municipal, manufacturing, industrial, etc.)

6. Description of Well: Depth 26 feet. Type dug
(Dug or drilled)

diameter 96 inches. Elevation of ground at well site 1295 feet, mean sea level.
(As near as known)

Depth to water table 7 feet.

7. Capacity of Well: 25 g.p.m. with 19 feet drawdown. in 4 hours.

_____ g.p.m. with _____ feet drawdown.

Date of test none - noted from use.

If Flowing Well: Measured discharge _____ g.p.m. on _____
(Date)

Shut-in pressure at ground surface _____ lbs. per sq. in. on _____
(Date)

Water is controlled by _____
(Cap, valve, etc.)

Township 37 S. Range 2 W., W.M.
North

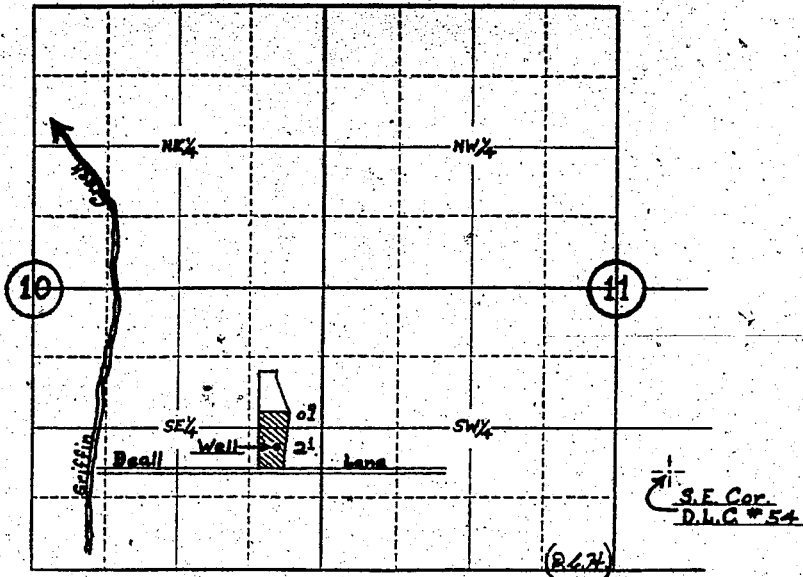

Locate well and acreage of irrigated land on plat.
Scale: 4" - 1 Mile

STATE OF OREGON

County of Jackson } ss.

I, Thurman Barnes, being first duly sworn, do hereby certify that I have read the foregoing Registration Statement and that all of the items therein contained are true to the best of my knowledge and belief.

Thurman Barnes
(Signature of Registrant)

Subscribed and sworn to before me this 10th day of June, 1958.

My commission expires August 25, 1958

(SEAL)

CERTIFICATE OF REGISTRATION

STATE OF OREGON } ss.

County of Marion

This is to certify that the foregoing Registration Statement was received in the office of the State Engineer on the 11th day of June, 1958, at 8:00 o'clock A. M. and has been duly recorded in said office in Book No. 8 of Registration Statements on page GR-1653

Witness my hand this 7th day of January, 1959.

\$15.00

Levon A. Stanley
(State Engineer)

By _____
(Deputy)

GR - 1653