

Registration Statement

OF CLAIMANT OF RIGHT TO APPROPRIATE GROUND WATER

(Under Chapter 708, Oregon Laws 1955.)

TO THE STATE ENGINEER OF OREGON:

I, Arcie Claggett
 of 2175 Chumana Rd County of Marion

State of Oregon, do hereby make application for a certificate of registration as evidence of a right to appropriate ground water.

1. Source from which water is withdrawn is Pump Well
(Flowing well, pump well, infiltration trench, or tunnel)
2. Location is: 1 Mile NE from Keizer
(Approximate distance and direction from nearest city or town)

and is more particularly described as follows:

(a) 3400' S & 350' W from the NE corner section 35
(Give distance and bearing to corner of section or other legal subdivision)
 being within NE 1/4 SE 1/4 of Sec. 35, Twp. 6 S, Rge. 3 W
(Smallest legal subdivision) (N. or S.) (E. or W.)

or (b) within limits of recorded platted property, town or city: _____

in Lot _____, Block _____ of _____
(Name of plat or addition)

County of _____
(If within city or town, give name)

3. Construction Work was begun on April - 1951; was completed on April 19 - 1951
(Date) (Date)

and the ground water claimed was first used for the purposes set out below on April 20 - 1951
(Date)

since which time the water has been used Continuously
(Continuously or intermittently)

from May to Sept
(Date) (Date)

4. Quantity of water claimed and used is 136 gallons per minute; _____ acre feet per year.

5. Purpose or Purposes for which water is used Irrigation

(Domestic, irrigation, municipal, manufacturing, industrial, etc.)

6. Description of Well: Depth 59 feet. Type Drilled
(Dug or drilled)

diameter 10" ID inches. Elevation of ground at well site 145 feet, mean sea level.
(As near as known)

Depth to water table 12 feet.

7. Capacity of Well: 150 g.p.m. with 6 feet drawdown.

_____ g.p.m. with _____ feet drawdown.

Date of test _____

If Flowing Well: Measured discharge _____ g.p.m. on _____
(Date)

Shut-in pressure at ground surface _____ lbs. per sq. in. on _____
(Date)

Water is controlled by _____
(Cap, valve, etc.)

Township 6 S Range 3 W W.M.
North

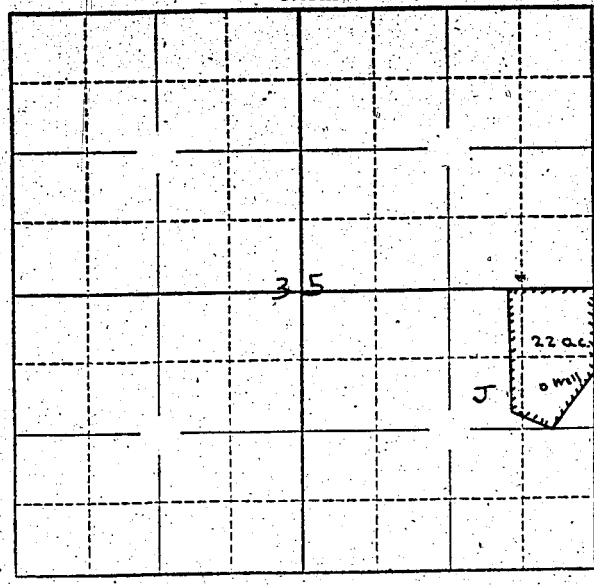

Locate well and acreage of irrigated land on plat.
Scale: $\frac{1}{4}$ " = 1 Mile

STATE OF OREGON }
County of Marion } ss.

I, Archie Claggett, being first duly sworn, do hereby certify that I have read the foregoing Registration Statement and that all of the items therein contained are true to the best of my knowledge and belief.

Archie Claggett
(Signature of Registrant)

Subscribed and sworn to before me this 11th day of June, 1958

My commission expires September 2, 1960

Harold Jones
(Notary Public)

(SEAL)

CERTIFICATE OF REGISTRATION

STATE OF OREGON }
County of Marion } ss.

This is to certify that the foregoing Registration Statement was received in the office of the State Engineer on the 10th day of June, 1958, at 11:00 o'clock M. and has been duly recorded in said office in Book No. 8 of Registration Statements on page GR-1656

~~Construction shall be completed by _____ 19____ and the water completely applied to beneficial uses by _____ 19____~~

Witness my hand this 7th day of January, 1959

Alvaro A. Stank
(State Engineer)

\$15.00

By _____ (Deputy)

GR-1656