

Registration Statement

OF CLAIMANT OF RIGHT TO APPROPRIATE GROUND WATER

TO THE STATE ENGINEER OF OREGON:

I, Robert E. Taylor

of Route 4, Box 319, Corvallis County of Linn

State of Oregon, do hereby make application for a certificate of registration as evidence of a right to appropriate ground water.

1. Source from which water is withdrawn is pump well #2

2. Location is: 2 miles east of Corvallis

and is more particularly described as follows: S 16° 15' W 491' to SE corner of property, said corner being S 89° 43' W 5.267 chains hence 2.30 chains N and 6.81 chains

(a) E to SE corner Section 36, T. 11S, R. 5W, W.M. Well

being within SE 1/4 SE 1/4 of Sec. 36, Twp. 11S, Rge. 5W

or (b) within limits of recorded platted property, town or city:

in Lot _____, Block _____ of _____

County of _____

3. Construction Work was begun on 1940; was completed on 1940

and the ground water claimed was first used for the purposes set out below on 1940

since which time the water has been used continuously

from 1940 to 1958

4. Quantity of water claimed and used is 350 when pumping gallons per minute; 15 acre feet per year.

5. Purpose or Purposes for which water is used irrigation

6. Description of Well: Depth 36 feet. Type drilled

diameter 4 inches. Elevation of ground at well site 220 feet, mean sea level.

Depth to water table 10 feet.

7. Capacity of Well: more than 350 gpm suck directly from casing

Date of test untested

If Flowing Well: Measured discharge _____ g.p.m. on _____

Shut-in pressure at ground surface _____ lbs. per sq. in. on _____

Water is controlled by _____

8. Casing: (Give diameter, commercial specifications and depth below ground surface of each casing size.)

4 inch diameter steel from surface to 36 feet
inch diameter from to feet
inch diameter from to feet
inch diameter from to feet

Describe and show depth of shoe, plug, adapter, liner or other details:

9. Perforated Casings or Screens:

perforated from 28' to 36'
(Number per foot and size of perforations, or describe screen)
from to
from to
from to

10. Log of Well: (Describe each stratum or formation clearly, indicate if water bearing, and give thickness and depth as indicated.)

Table with 3 columns: MATERIAL, Thickness (Feet), Depth to Bottom (Feet). Row 1 contains 'unknown' in the MATERIAL column.

If log of well is not available, give name and address of driller. Frank Skillings, deceased

11. Infiltration Trench: Covered or open _____

Dimensions: Length _____ ft. Minimum depth _____ ft. Maximum depth _____ ft.

Bottom width _____ ft. Discharge _____ g.p.m. Date of test _____

12. Tunnel: Type of lining _____

Dimensions: _____
(Length, course, and cross sectional size)

Position of water bearing stratum with reference to portal of tunnel _____

Log of tunnel: (Preceding table for log of well may be used, if desired. Give footage from portal and character of materials, as pertinent.)

13. Pumping Equipment:

(a) Pump 3 x 2 $\frac{1}{2}$ centrifugal _____ Capacity 350 _____ g.p.m.
(Make, type and size)

(b) Motor 10 hp, 3 phase electric _____
(Type and horsepower)

14. Location of area irrigated or to be irrigated, or place of use if for purposes other than irrigation.

Township North or South	Range E. or W. of Willamette Meridian	Section	Forty-acre Tract	Number Acres To Be Irrigated	Date of Reclamation
11S	5W	36	SE $\frac{1}{4}$ SE $\frac{1}{4}$	6.0	1940

15. If the ground water supply is supplemental to an existing water supply, identification of any application for a permit, permit, certificate or adjudicated right to appropriate water made or held by the registrant.

Township 11S Range 5W, W.M.
North

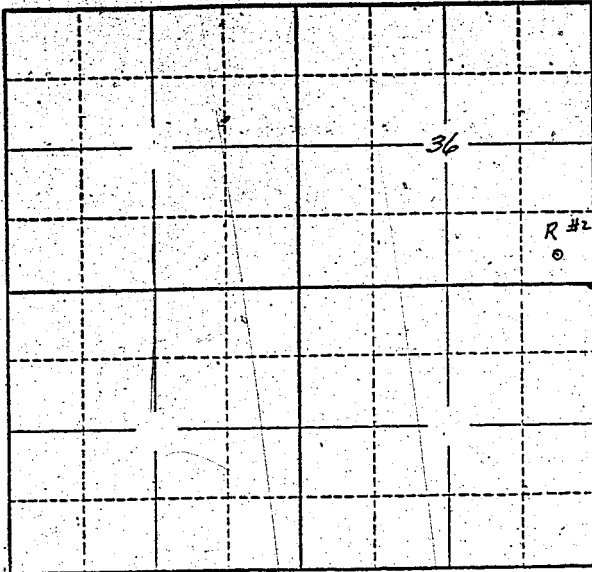

Locate well and acreage of irrigated land on plat.
Scale: 2" = 1 Mile

STATE OF OREGON

County of Benton } ss.

I, ROBERT E. TAYLOR, being first duly sworn, do hereby certify that I have read the foregoing Registration Statement and that all of the items therein contained are true to the best of my knowledge and belief.

Robert E. Taylor
(Signature of Registrant)

Subscribed and sworn to before me this 10 day of June, 1958

My commission expires 8-18-61

W. Carter
(Notary Public)

(SEAL)

CERTIFICATE OF REGISTRATION

STATE OF OREGON

County of Marion } ss.

This is to certify that the foregoing Registration Statement was received in the office of the State Engineer on the 13th day of June, 1958, at 8:00 o'clock A. M. and has been duly recorded in said office in Book No. 8 of Registration Statements on page GR-1671

Witness my hand this 7th day of January

1959
Lewis A. Stanley
(State Engineer)

By _____ (Deputy)

GR-1671

\$15.00