

Registration Statement

OF CLAIMANT OF RIGHT TO APPROPRIATE GROUND WATER

(Under Chapter 708, Oregon Laws 1955.)

TO THE STATE ENGINEER OF OREGON:

I, Myron and Ballard Ingraham

of Rt. 2, Box 362, Albany County of Linn

State of Oregon, do hereby make application for a certificate of registration as evidence of a right to appropriate ground water.

1. Source from which water is withdrawn is Pump well 1
(Flowing well, pump well, infiltration trench, or tunnel)

2. Location is: eight miles NE Albany, Oregon
(Approximate distance and direction from nearest city or town)

and is more particularly described as follows:

(a) S. 19° W. 14.0 chains from the NE corner of NE 1/4 of SE 1/4, S. 5, T. 10 S. R. 3 W.
(Give distance and bearing to corner of section or other legal subdivision)
being within NE 1/4 of SE 1/4
(Smallest legal subdivision) of Sec. 5, Twp. 10 S., Rge. 3 W.
(N. or S.) (E. or W.)

or (b) within limits of recorded platted property, town or city:

in Lot _____, Block _____ of _____
(Name of plat or addition)

County of Linn
(If within city or town, give name)

3. Construction Work was begun on April 10, 1950 was completed on April 12, 1950
(Date) (Date)

and the ground water claimed was first used for the purposes set out below on April 20, 1950
(Date)

since which time the water has been used continuously
(Continuously or intermittently)

from April 20, 1950 to present time
(Date) (Date)

4. Quantity of water claimed and used is 250 gallons per minute; 47 acre feet per year.

5. Purpose or Purposes for which water is used Irrigation

(Domestic, irrigation, municipal, manufacturing, industrial, etc.)

6. Description of Well: Depth 25 feet. Type drilled
(Dug or drilled)

diameter 4 inches. Elevation of ground at well site 190 feet, mean sea level.
(As near as known)

Depth to water table _____ feet.

7. Capacity of Well: 300 g.p.m. with 3 feet drawdown.

_____ g.p.m. with _____ feet drawdown.

Date of test Not tested

If Flowing Well: Measured discharge _____ g.p.m. on _____
(Date)

Shut-in pressure at ground surface _____ lbs. per sq. in. on _____
(Date)

Water is controlled by _____
(Cap, valve, etc.)

8. Casing: (Give diameter, commercial specifications and depth below ground surface of each casing size.)

4 inch diameter steel casing from 0 to 25 feet
 inch diameter from to feet
 inch diameter from to feet
 inch diameter from to feet

Describe and show depth of shoe, plug, adapter, liner or other details:

9. Perforated Casings or Screens:

Slit perforations from 15 to 25

(Number per foot and size of perforations, or describe screen)

from to

from to

from to

10. Log of Well: (Describe each stratum or formation clearly, indicate if water bearing, and give thickness and depth as indicated.)

MATERIAL	Thickness (Feet)	Depth to Bottom (Feet)
Log not available		

If log of well is not available, give name and address of driller. R. S. Bennett,

107 N. 1st E., Tropic, Utah

11. Infiltration Trench: Covered or open

Dimensions: Length ft. Minimum depth ft. Maximum depth ft.

Bottom width ft. Discharge g.p.m. Date of test

12. Tunnel: Type of lining

Dimensions:
(Length, course, and cross sectional size)

Position of water bearing stratum with reference to portal of tunnel

Log of tunnel: (Preceding table for log of well may be used, if desired. Give footage from portal and character of materials, as pertinent.)

13. Pumping Equipment:

(a) Pump 2" Rain O Flow centrifugal Capacity 250 g.p.m.
(Make, type and size)

(b) Motor 10 H. P. electric
(Type and horsepower)

14. Location of area irrigated or to be irrigated, or place of use if for purposes other than irrigation.

Township North or South	Range E. or W. of Willamette Meridian	Section	Forty-acre Tract	Number Acres To Be Irrigated	Date of Reclamation
10 S	3 W.	5	NE $\frac{1}{4}$ of SE $\frac{1}{4}$	18.3	April 12, 1950
10 S	3 W.	5	SE $\frac{1}{4}$ of NE $\frac{1}{4}$	0.4	"
				18.7	

15. If the ground water supply is supplemental to an existing water supply, identification of any application for a permit, permit, certificate or adjudicated right to appropriate water made or held by the registrant.

Township 10.0 Range 3.W, W.M.
North

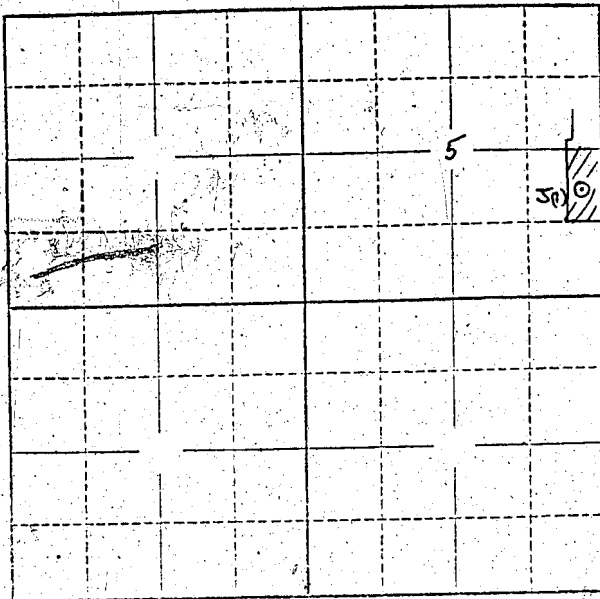

Locate well and acreage of irrigated land on plat.
Scale: 2" = 1 Mile

STATE OF OREGON

County of Linn

ss.

I, Myron and Ballard Ingraham, being first duly sworn, do hereby certify that I have read the foregoing Registration Statement and that all of the items therein contained are true to the best of my knowledge and belief.

Myron Ingraham
Ballard Ingraham
(Signature of Registrant)

Subscribed and sworn to before me this day of 19.....

My commission expires

(Notary Public)

(SEAL)

SEE PAGE GR-269-K FOR
CERTIFICATE OF REGISTRATION

STATE OF OREGON

County of Marion

ss.

~~I do hereby certify that the foregoing Registration Statement was approved by the office of the State Engineer and that the same is in accordance with the provisions of the laws of the State of Oregon and that the same has been duly recorded in my office.~~
Construction shall be completed by and the water completely applied to beneficial use by

Witness my hand this day of 19.....

(State Engineer)

By

(Deputy)

GR-269 C

RECEIVED
SEP 11 1956

REGISTRATION NO. GR-178

Registration Statement CERTIFICATE NO. GR-269

OF CLAIMANT OF RIGHT TO APPROPRIATE GROUND WATER

(Under Chapter 708, Oregon Laws 1955.)

TO THE STATE ENGINEER OF OREGON:

I, Myron and Ballard Ingraham

of Rt. 2, Box 362, Albany County of Linn

State of Oregon, do hereby make application for a certificate of registration as evidence of a right to appropriate ground water.

1. Source from which water is withdrawn is Pump well 2
(Flowing well, pump well, infiltration trench, or tunnel)

2. Location is: eight miles NE Albany, Oregon
(Approximate distance and direction from nearest city or town)

and is more particularly described as follows:

(a) N. 31 1/2° W. 16.5 chains from the SE corner of SE 1/4 of S. 5, T. 10 S., R. 3 W.
(Give distance and bearing to corner of section or other legal subdivision)

being within SE 1/4 of NE 1/4 of Sec. 5 Twp. 10 S. Rge. 3 W.
(Smallest legal subdivision) (N. or S.) (E. or W.)

or (b) within limits of recorded platted property, town or city:

in Lot _____, Block _____ of _____
(Name of plat or addition)

County of Linn
(If within city or town, give name)

3. Construction Work was begun on April 16, 1951; was completed on April 18, 1951
(Date) (Date)

and the ground water claimed was first used for the purposes set out below on May 10, 1951
(Date)

since which time the water has been used continuously
(Continuously or Intermittently)

from May 10, 1951 to present time
(Date) (Date)

4. Quantity of water claimed and used is 250 gallons per minute; 52 acre feet per year.

5. Purpose or Purposes for which water is used Irrigation

(Domestic, irrigation, municipal, manufacturing, industrial, etc.)

6. Description of Well: Depth 25 feet. Type drilled
(Dug or drilled)

diameter 8 inches. Elevation of ground at well site 185 feet, mean sea level.
(As near as known)

Depth to water table _____ feet.

7. Capacity of Well: 400 g.p.m. with 2 feet drawdown.

g.p.m. with _____ feet drawdown.

Date of test Not tested

If Flowing Well: Measured discharge _____ g.p.m. on _____
(Date)

Shut-in pressure at ground surface _____ lbs. per sq. in. on _____
(Date)

Water is controlled by _____
(Cap, valve, etc.)

GR-269D

8. Casing: (Give diameter, commercial specifications and depth below ground surface of each casing size.)

8 inch diameter steel casing from 0 to 25 feet
..... inch diameter from to feet
..... inch diameter from to feet
..... inch diameter from to feet

Describe and show depth of shoe, plug, adapter, liner or other details:

9. Perforated Casings or Screens:

Slit perforations from 15 to 25 feet
(Number per foot and size of perforations, or describe screen)
..... from to
..... from to
..... from to

10. Log of Well: (Describe each stratum or formation clearly, indicate if water bearing, and give thickness and depth as indicated.)

MATERIAL	Thickness (Feet)	Depth to Bottom (Feet)
Logs not available		

If log of well is not available, give name and address of driller. *T. J. Burkhart*

11. **Infiltration Trench:** Covered or open
 Dimensions: Length ft. Minimum depth ft. Maximum depth ft.
 Bottom width ft. Discharge g.p.m. Date of test

12. **Tunnel:** Type of lining
 Dimensions:
 (Length, course, and cross sectional size)
 Position of water bearing stratum with reference to portal of tunnel

Log of tunnel: (Preceding table for log of well may be used, if desired. Give footage from portal and character of materials, as pertinent.)

13. **Pumping Equipment:**
 (a) Pump *2" Fairbanks Morse centrifugal* Capacity *250* g.p.m.
 (Make, type and size)
 (b) Motor *10 H. P. electric*
 (Type and horsepower)

14. Location of area irrigated or to be irrigated, or place of use if for purposes other than irrigation.

Township North or South	Range E. or W. of Willamette Meridian	Section	Forty-acre Tract	Number Acres To Be Irrigated	Date of Reclamation
10 S	3 W	5	NE $\frac{1}{4}$ of SE $\frac{1}{4}$	1.6	May 10, 1951
10 S	3 W	5	SE $\frac{1}{4}$ of NE $\frac{1}{4}$	16.4	May 10, 1951
10 S	3 W	5	NE $\frac{1}{4}$ of NE $\frac{1}{4}$	2.7	May 10, 1951
				20.7	

15. If the ground water supply is supplemental to an existing water supply, identification of any application for a permit, permit, certificate or adjudicated right to appropriate water made or held by the registrant.

Township 10S Range 30W W.M.
North

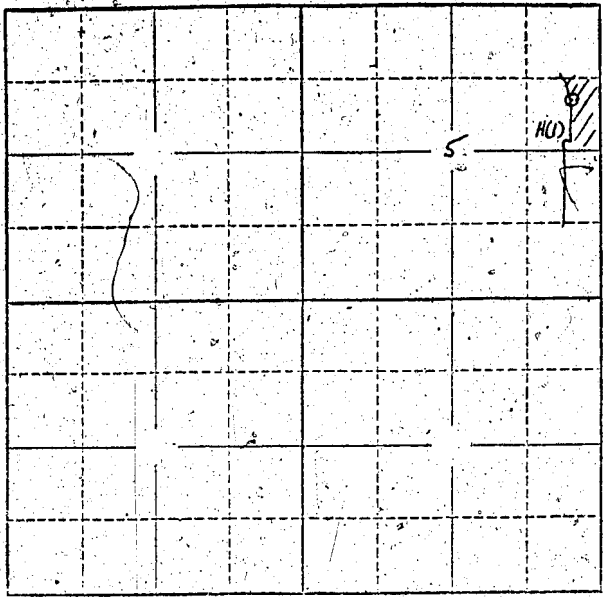

Locate well and acreage of irrigated land on plat.
Scale: 2" = 1 Mile

STATE OF OREGON

County of Linn

ss.

I, Myron and Ballard Ingraham, being first duly sworn, do hereby certify that I have read the foregoing Registration Statement and that all of the items therein contained are true to the best of my knowledge and belief.

Myron Ingraham
Ballard Ingraham
(Signature of Registrant)

Subscribed and sworn to before me this day of 19.....

My commission expires

(Notary Public)

(SEAL)

SEE PAGE GR-269-K FOR
CERTIFICATE OF REGISTRATION

STATE OF OREGON

County of Marion

ss.

~~This is to certify that the foregoing Registration Statement was received in the office of the State Engineer on the X-X-X day of X-X-X-X-X-X-X-X, 19X-X, at X-X-X-X-X-X-X-X, X-X-X-X-X-X-X-X, and has been duly recorded in said office in Book No. X-X-X-X-X-X of Registration Statements on pages X-X-X-X-X-X-X-X. Construction shall be completed by X-X-X-X-X-X-X-X, 19 X-X, and the water conveyed to beneficial use by X-X-X-X-X-X-X-X, 19 X-X.~~

Witness my hand this day of 19.....

(State Engineer)

By

(Deputy)

GR-269G

REGISTRATION NO. GR-173

CERTIFICATE NO. GR-269

Registration Statement

OF CLAIMANT OF RIGHT TO APPROPRIATE GROUND WATER

(Under Chapter 702, Oregon Laws 1955.)

TO THE STATE ENGINEER OF OREGON:

I, Myron and Ballard Ingraham

of Rt. 2, Box 362, Albany County of Linn

State of Oregon, do hereby make application for a certificate of registration as evidence of a right to appropriate ground water.

1. Source from which water is withdrawn is Pump well 3
(Flowing well, pump well, infiltration trench, or tunnel)

2. Location is: eight miles NE Albany, Oregon
(Approximate distance and direction from nearest city or town)

and is more particularly described as follows:

(a) S. 9.1 chains from the NE corner of S. 5, T. 10 S., R. 3 W.
(Give distance and bearing to corner of section or other legal subdivision)

being within NE $\frac{1}{4}$ of NE $\frac{1}{4}$ of Sec. 5, Twp. 10 S., Rge. 3 W.
(Smallest legal subdivision) (N. or S.) (E. or W.)

or (b) within limits of recorded platted property, town or city:

in Lot _____, Block _____ of _____
(Name of plat or addition)

County of Linn

(If within city or town, give name)

3. Construction Work was begun on April 6, 1953; was completed on April 9, 1953
(Date) (Date)

and the ground water claimed was first used for the purposes set out below on May 20, 1953
(Date)

since which time the water has been used continuously
(Continuously or intermittently)

from May 20, 1953 to present time
(Date) (Date)

4. Quantity of water claimed and used is 250 gallons per minute; 46 acre feet per year.

5. Purpose or Purposes for which water is used Irrigation

(Domestic, irrigation, municipal, manufacturing, industrial, etc.)

6. Description of Well: Depth 25 feet. Type drilled
(Dug or drilled)

diameter 4 inches. Elevation of ground at well site 190 feet, mean sea level.
(As near as known)

Depth to water table _____ feet.

7. Capacity of Well: 300 g.p.m. with 3 feet drawdown.

_____ g.p.m. with _____ feet drawdown.

Date of test Not tested

If Flowing Well: Measured discharge _____ g.p.m. on _____
(Date)

Shut-in pressure at ground surface _____ lbs. per sq. in. on _____
(Date)

Water is controlled by _____
(Cap, valve, etc.)

GR-269 H

8. **Casing:** (Give diameter, commercial specifications and depth below ground surface of each casing size.)

4 inch diameter steel casing from 0 to 25 feet
..... inch diameter from to feet
..... inch diameter from to feet
..... inch diameter from to feet

Describe and show depth of shoe, plug, adapter, liner or other details:

9. **Perforated Casings or Screens:**

Slit perforations from 15 to 25
(Number per foot and size of perforations, or describe screen)

..... from to
..... from to
..... from to

10. **Log of Well:** (Describe each stratum or formation clearly, indicate if water bearing, and give thickness and depth as indicated.)

MATERIAL	Thickness (Feet)	Depth to Bottom (Feet)
Logs not available		

If log of well is not available, give name and address of driller. T. S. Boushant,

11. Infiltration Trench: Covered or open

Dimensions: Length ft. Minimum depth ft. Maximum depth ft.

Bottom width ft. Discharge g.p.m. Date of test

12. Tunnel: Type of lining

Dimensions:
(Length, course, and cross sectional size)

Position of water bearing stratum reference to portal of tunnel

Log of tunnel: (Preceding table for log of well may be used, if desired. Give footage from portal and character of materials, as pertinent.)

13. Pumping Equipment:

(a) Pump 2" Pacific Centrifugal Capacity 250 g.p.m.
(Make, type and size)

(b) Motor 10 H. P. electric
(Type and horsepower)

14. Location of area irrigated or to be irrigated, or place of use if for purposes other than irrigation.

Township North or South	Range E. or W. of Willamette Meridian	Section	Forty-acre Tract	Number Acres To Be Irrigated	Date of Reclamation
10 S	3 W	5	NE $\frac{1}{4}$ of NE $\frac{1}{4}$	18.5	May 20, 1953

213-244

Beginning at the quarter Section corner on the East boundary line of Sec. 5, T. 10 S., R. 3 W. of the Will. Mer. in Linn County, Oregon; and running thence South ~~42.90 feet West~~ along the East line of said Section 5; 20 chains; thence West 9.95 chains; thence Northerly 62.82 chains to the North-west corner of the Northeast quarter of the Northeast quarter of the Northeast quarter of Sec. 5; thence S. 89°42' E. 10 chains to the NE corner of said Sec. 5; thence South ~~42.90 feet West~~ 42.90 chains to the place of beginning and containing 62.70 acre, more or less. Save and except an open roadway off the South end of the above described premises also an open roadway 30 feet wide off the East side of the Southeast quarter of the Southeast quarter of Sec. 5 in T. 10-3W. of the Will. Mer. all lying and being in Linn Co. State of Oregon

15. If the ground water supply is supplemental to an existing water supply, identification of any application for a permit, permit, certificate or adjudicated right to appropriate water made or held by the registrant.

Township 10S Range 3W W.M.
North

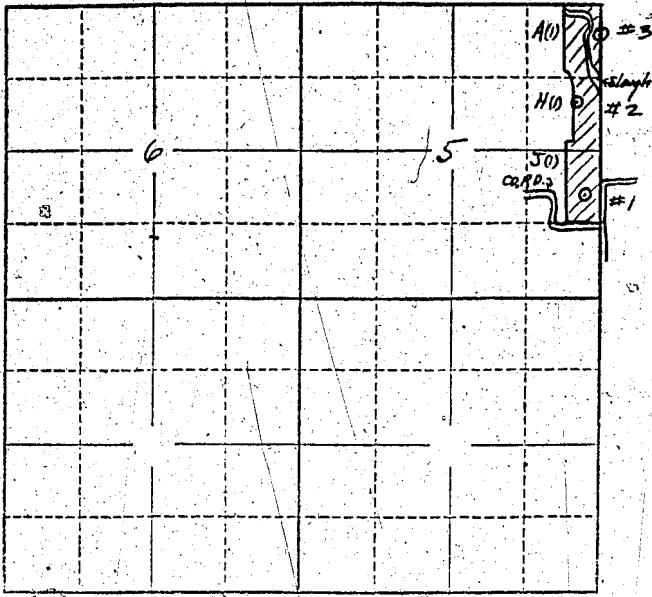

Locate well and acreage of irrigated land on plat.
Scale: 2" = 1 Mile

STATE OF OREGON

County of Linn } ss.

I, Myron and Ballard Ingraham, being first duly sworn, do hereby certify that I have read the foregoing Registration Statement and that all of the items therein contained are true to the best of my knowledge and belief.

Myron Ingraham
Ballard Ingraham
(Signature of Registrant)

Subscribed and sworn to before me this 18th day of September, 1956

My commission expires _____
(SEAL) R. M. Russell, Clerk
Red. Magart, Deputy
(Notary Public)

CERTIFICATE OF REGISTRATION

STATE OF OREGON

County of Marion } ss.

This is to certify that the foregoing Registration Statement was received in the office of the State Engineer on the 8th day of May, 1956, at 8 o'clock A. M. and has been duly recorded in said office in Book No. 2 of Registration Statements on page GR-269-K.

~~Construction shall be completed by _____ 19____ and the water completely applied to beneficial use by _____ 19____.~~

Witness my hand this 15th day of January, 1957
Lewis R. Timney
(State Engineer)

By _____
(Deputy)