

RECEIVED  
JUN 16 1958  
STATE ENGINEER  
SALEM, OREGON

REGISTRATION NO. GR-1730  
CERTIFICATE NO. GR-1679

# Registration Statement

## OF CLAIMANT OF RIGHT TO APPROPRIATE GROUND WATER

(Under Chapter 708, Oregon Laws 1955.)

TO THE STATE ENGINEER OF OREGON:

I, JACK DELDANCHE  
of Route 1 Cornelius <sup>Box 385</sup> County of Washington  
State of Oregon, do hereby make application for a certificate of registration as evidence of a right to appropriate ground water.

- Source from which water is withdrawn is Pump Well  
(Flowing well, pump well, infiltration trench, or tunnel)
- Location is: 3.5 Miles North Cornelius on Wren Road  
(Approximate distance and direction from nearest city or town)

and is more particularly described as follows:

(a) From NE Corner Sec 22 S 62° 50' West 4125' to well  
(Give distance and bearing to corner of section or other legal subdivision)  
being within SE 1/4 NW 1/4 of Sec. 22, Twp. 14N, Rge. 3W  
(Smallest legal subdivision) (N. or S.) (E. or W.)

or (b) within limits of recorded platted property, town or city:  
in Lot \_\_\_\_\_ Block \_\_\_\_\_ of \_\_\_\_\_  
(Name of plat or addition)  
County of \_\_\_\_\_  
(If within city or town, give name)

3. Construction Work was begun on July 1, 1952; was completed on Oct 25, 1952  
(Date) (Date)  
and the ground water claimed was first used for the purposes set out below on May 5, 1953  
(Date)  
since which time the water has been used Continuously from May 1953 to Oct 1, 1953  
(Continuously or intermittently)  
from 1953 to Present Date  
(Date) (Date)

4. Quantity of water claimed and used is 200 gallons per minute; 50 acre feet per year.

5. Purpose or Purposes for which water is used Irrigation  
(Domestic, irrigation, municipal, manufacturing, industrial, etc.)

6. Description of Well: Depth 216' 8" feet. Type Buried  
(Dug or drilled)  
diameter 12 inches. Elevation of ground at well site 210' feet, mean sea level.  
(As near as known)  
Depth to water table 16' feet.

7. Capacity of Well: 90 g.p.m. with 60 feet drawdown.  
160 g.p.m. with 140 feet drawdown.

Date of test A. Sep 22 1952 B. Oct 25 1952

If Flowing Well: Measured discharge \_\_\_\_\_ g.p.m. on \_\_\_\_\_  
(Date)

Shut-in pressure at ground surface \_\_\_\_\_ lbs. per sq. in. on \_\_\_\_\_  
(Date)

Water is controlled by \_\_\_\_\_  
(Cap, valve, etc.)

8. Casing: (Give diameter, commercial specifications and depth below ground surface of each casing size.)

12 inch diameter *Steel Shoe Joint Casing* from *Surface* to *216' 8"* feet  
 inch diameter from to feet  
 inch diameter from to feet  
 inch diameter from to feet

Describe and show depth of shoe, plug, adapter, liner or other details:

*NONE*

9. Perforated Casings or Screens:

(Number per foot and size of perforations, or describe screen) from to  
 from to  
 from to  
 from to

10. Log of Well: (Describe each stratum or formation clearly, indicate if water bearing, and give thickness and depth as indicated.)

MATERIAL	Thickness (Feet)	Depth to Bottom (Feet)
<i>Top Soil</i>	<i>16</i>	<i>16</i>
<i>Fine Sand and Water</i>	<i>47</i>	<i>63</i>
<i>Sticky Blue Clay</i>	<i>27</i>	<i>88</i>
<i>Blue Sandy Clay</i>	<i>49</i>	<i>136</i>
<i>Blue Sand &amp; Quartz Grats, Water-bearing Sand</i>	<i>12</i>	<i>147</i>
<i>Blue Clay</i>	<i>36</i>	<i>182</i>
<i>Blue Sandy Clay - Fine Water</i>	<i>10</i>	<i>191</i>
<i>Blue &amp; yellow Clay</i>	<i>13</i>	<i>203</i>
<i>Gravel, Water also Wood particles</i>	<i>5</i>	<i>208</i>
<i>Blue &amp; yellow Clay</i>	<i>49</i>	<i>255</i>



Township 1N Range 3W, W.M.  
 North

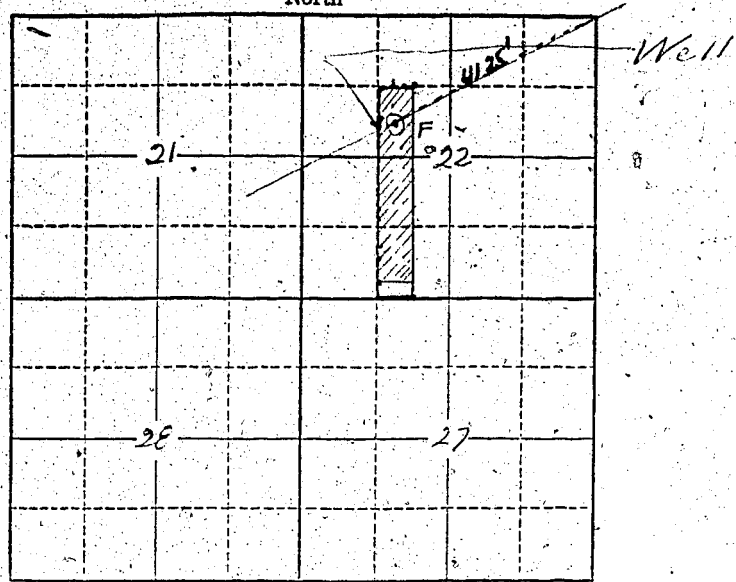

Locate well and acreage of irrigated land on plat.  
 Scale: 2" = 1 Mile

STATE OF OREGON }  
 County of ..... } ss.

I, ....., being first duly sworn, do hereby certify that I have read the foregoing Registration Statement and that all of the items therein contained are true to the best of my knowledge and belief.

*Jack Delplanché*  
 (Signature of Registrant)

Subscribed and sworn to before me this 17 day of June, 1958

My commission expires Sept 24, 1958  
*Floyd C. Shroy*  
 (Notary Public)

(SEAL)

NOTARY PUBLIC FOR OREGON  
 My Commission Expires Sept. 24, 1958

**CERTIFICATE OF REGISTRATION**

STATE OF OREGON }  
 County of Marion } ss.

This is to certify that the foregoing Registration Statement was received in the office of the State Engineer on the 16<sup>th</sup> day of June, 1958, at 8:00 o'clock A. M. and has been duly recorded in said office in Book No. 8 of Registration Statements on page GR-1679

~~Construction shall be completed by .....~~  
~~beneficial use by .....~~

Witness my hand this 7<sup>th</sup> day of January, 1959

*Henry A. Stanku*  
 (State Engineer)

\$1800

By .....  
 (Deputy)

**GR-1679**