

RECEIVED JUN 19 1958 STATE ENGINEER SALEM OREGON

Registration No. GR-1746 Certificate No. GR 1693

Registration Statement

OF CLAIMANT OF RIGHT TO APPROPRIATE GROUND WATER

TO THE STATE ENGINEER OF OREGON:

I, David H. Holmes

of P. O. Box 712, Medford, Oregon County of Jackson

State of Oregon, do hereby make application for a certificate of registration as evidence of a right to appropriate ground water.

- 1. Source from which water is withdrawn is Infiltration Trench (Sump) and Tiling
2. Location is: 1 Mile NE of Phoenix, Oregon

and is more particularly described as follows:

(a) 114.0 feet South and 310 feet West from the NE corner DLC #41

being within NE 1/4 NE 1/4 of Sec. 9, Twp. 38 S., Rge. 1 W.

or (b) within limits of recorded platted property, town or city:

in Lot, Block of County of

3. Construction Work was begun on June 1955; was completed on July 1955

and the ground water claimed was first used for the purposes set out below on July 1955

since which time the water has been used intermittently

from July 1955 to present

4. Quantity of water claimed and used is 250 gallons per minute; 98 acre feet per year.

5. Purpose or Purposes for which water is used irrigation (see note at #10 infra.)

6. Description of Well: Depth feet. Type

diameter inches. Elevation of ground at well site 1465 feet, mean sea level.

Depth to water table 6 feet.

7. Capacity of Well: g.p.m. with feet drawdown.

Date of test

If Flowing Well: Measured discharge g.p.m. on

Shut-in pressure at ground surface lbs. per sq. in. on

Water is controlled by



8. Casing: (Give diameter, commercial specifications and depth below ground surface of each casing size.)

inch diameter none from _____ to _____ feet
inch diameter _____ from _____ to _____ feet
inch diameter _____ from _____ to _____ feet
inch diameter _____ from _____ to _____ feet

Describe and show depth of shoe, plug, adapter, liner or other details:
none

9. Perforated Casings or Screens:

none from _____ to _____
(Number per foot and size of perforations, or describe screen)
from _____ to _____
from _____ to _____
from _____ to _____

10. Log of Well: (Describe each stratum or formation clearly, indicate if water bearing, and give thickness and depth as indicated.)

MATERIAL	Thickness (Feet)	Depth to Bottom (Feet)
(not known)		
<p>Note: At present the irrigated acreage contains young pear trees which are hand-watered by means of water from said sump. An 80 g.p.m. pump draws water from the sump to a tank trailer which is driven over the grounds releasing water at each tree. However, the water needs for said acreage will increase each year as the trees grow, and, within a few years, the full capacity of said sump will be needed for complete irrigation.</p>		

If log of well is not available, give name and address of driller. Tru Mix Concrete Co., Medford, Oreg

11. Infiltration Trench: Covered or open open

Dimensions: Length 40 ft. Minimum depth 15 ft. Maximum depth 20 ft.

Bottom width 20 ft. Discharge over 250 g.p.m. Date of test July, 1955

Tiling
12. Tunnel: Type of lining drain tile (straight)

Dimensions: 600 feet long and 10" diameter
(Length, course, and cross sectional size)

Position of water bearing stratum with reference to portal of tunnel N/A

Log of tunnel: (Preceding table for log of well may be used, if desired. Give footage from portal and character of materials, as pertinent.)

13. Pumping Equipment:

(a) Pump 2" Rex General Purpose Centrifugal Capacity 80 g.p.m.
(Make, type and size)

(b) Motor Briggs and Stratton 1 cylinder air-cooled - 2 H.P.
(Type and horsepower)

14. Location of area irrigated or to be irrigated, or place of use if for purposes other than irrigation.

Township North or South	Range E. or W. of Willamette Meridian	Section	Forty-acre Tract	Number Acres To Be Irrigated	Date of Reclamation
38 S.	1 W.	4	SW $\frac{1}{4}$ SE $\frac{1}{4}$	4.0	July 1955
"	"	4	SE $\frac{1}{4}$ SE $\frac{1}{4}$	5.4	July 1955
"	"	9	NE $\frac{1}{4}$ NE $\frac{1}{4}$	12.3	July 1955
"	"	9	NW $\frac{1}{4}$ NE $\frac{1}{4}$	0.1	July 1955
			Total	21.8	

15. If the ground water supply is supplemental to an existing water supply, identification of any application for a permit, permit, certificate or adjudicated right to appropriate water made or held by the registrant.

None

Township 38 S. Range 1 W., W.M.

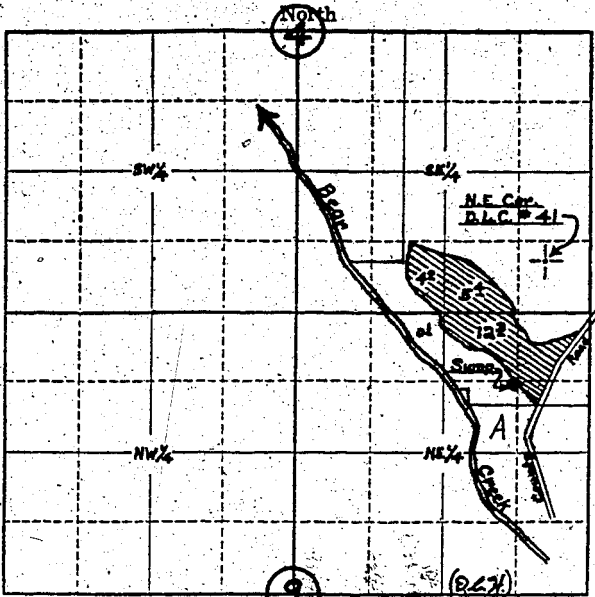

Locate well and acreage of irrigated land on plat.

Scale: 4" = 1 Mile

STATE OF OREGON

County of Jackson

I, David H. Holmes, being first duly sworn, do hereby certify that I have read the foregoing Registration Statement and that all of the items therein contained are true to the best of my knowledge and belief.

David H. Holmes
(Signature of Registrant)

Subscribed and sworn to before me this 9th day of June, 19 58

My commission expires PROBATIONARY PUBLIC FOR OREGON
My Commission Expires Feb. 8, 1961
(SEAL)

G. W. Hamon
(Notary Public)

CERTIFICATE OF REGISTRATION

STATE OF OREGON

County of Marion

This is to certify that the foregoing Registration Statement was received in the office of the State Engineer on the 19th day of June, 19 58, at 8:00 o'clock A. M. and has been duly recorded in said office in Book No. 8 of Registration Statements on page GR-1693

Witness my hand this 7th day of January, 19 59

Henry A. Stanley
(State Engineer)

By _____
(Deputy)

\$15.00

GR-1693