

Registration Statement

OF CLAIMANT OF RIGHT TO APPROPRIATE GROUND WATER

(Under Chapter 708, Oregon Laws 1955.)

TO THE STATE ENGINEER OF OREGON:

I, Anna M. Hulfemeyer
of 4645 Haywood Dr., Salem County of Marion
State of Oregon, do hereby make application for a certificate of registration as evidence
of a right to appropriate ground water.

1. Source from which water is withdrawn is Pump well
(Flowing well, pump well, infiltration trench, or tunnel)

2. Location is: Five miles N.E. of Salem
(Approximate distance and direction from nearest city or town)

and is more particularly described as follows:

(a) 100 feet east and 150 North from W/4 corner of section #5
7.50 N. from Co. rd. 726 (Haywood Dr.)
(Give distance and bearing to corner of section or other legal subdivision)

being within Lot 10 Florence Fruit Farm of Sec. 3, Twp. 7 S Rge. 2 W
(Smallest legal subdivision) (N. or S.) (E. or W.)

or (b) within limits of recorded platted property, town or city:
in Lot _____, Block _____ of _____
(Name of plat or addition)

County of _____
(If within city or town, give name)

3. Construction Work was begun on 1941; was completed on 1941
(Date) (Date)

and the ground water claimed was first used for the purposes set out below on Aug. 1948
(Date)

since which time the water has been used intermittently
(Continuously or Intermittently)

from May to Sept
(Date) (Date)

4. Quantity of water claimed and used is 250 gallons per minute; 2 acre
feet per year.

5. Purpose or Purposes for which water is used irrigation
(Domestic, irrigation, municipal, manufacturing, industrial, etc.)

6. Description of Well: Depth 150 feet. Type drilled
(Dug or drilled)

diameter 12 inches; Elevation of ground at well site 190 feet, mean sea level.
(As near as known)

Depth to water table 20 feet.

7. Capacity of Well: 300 g.p.m. with _____ feet drawdown.

_____ g.p.m. with _____ feet drawdown.

Date of test _____

If Flowing Well: Measured discharge _____ g.p.m. on _____
(Date)

Shut-in pressure at ground surface _____ lbs. per sq. in. on _____
(Date)

Water is controlled by _____
(Cap, valve, etc.)

8. Casing: (Give diameter, commercial specifications and depth below ground surface of each casing size.)

all 1.2 inch diameter unknown from to feet
 inch diameter from to feet
 inch diameter from to feet
 inch diameter from to feet

Describe and show depth of shoe, plug, adapter, liner or other details:

9. Perforated Casings or Screens:

..... unknown from to
 (Number per foot and size of perforations, or describe screen)
 from to
 from to
 from to

10. Log of Well: (Describe each stratum or formation clearly, indicate if water bearing, and give thickness and depth as indicated.)

MATERIAL	Thickness (Feet)	Depth to Bottom (Feet)
unknown		

If log of well is not available, give name and address of driller. Marion E. West, 4120
Market St., Salem, Ore

11. Infiltration Trench: Covered or open _____
 Dimensions: Length _____ ft. Minimum depth _____ ft. Maximum depth _____ ft.

Bottom width _____ ft. Discharge _____ g.p.m. Date of test _____

12. Tunnel: Type of lining _____

Dimensions: _____
(Length, course, and cross sectional size)

Position of water bearing stratum with reference to portal of tunnel _____

Log of tunnel: (Preceding table for log of well may be used, if desired. Give footage from portal and character of materials, as pertinent.)

13. Pumping Equipment:

(a) Pump Pomona Turbine, 6" discharge Capacity 300 g.p.m.
(Make, type and size)

(b) Motor Westinghouse 7 1/2 h.p. - single phase
Type - CT Induction motor (Type and horsepower) 220 volts

14. Location of area irrigated or to be irrigated, or place of use if for purposes other than irrigation.

Township North or South	Range E. or W. of Willamette Meridian	Section	Forty-acre Tract	Number Acres To Be Irrigated	Date of Reclamation
<u>7 S</u>	<u>2 W</u>	<u>5</u>	<u>-</u>	<u>50 Total</u>	
<u>7 S</u>	<u>2 W</u>	<u>6</u>	<u>SE 1/4 of NE 1/4</u>	<u>18</u>	<u>Aug. 1948</u>
<u>"</u>	<u>"</u>	<u>6</u>	<u>NE 1/4 of SE 1/4</u>	<u>9</u>	<u>"</u>
<u>"</u>	<u>"</u>	<u>5</u>	<u>SW 1/4 of NW 1/4</u>	<u>20</u>	<u>"</u>
<u>"</u>	<u>"</u>	<u>5</u>	<u>NW 1/4 of SW 1/4</u>	<u>3</u>	<u>"</u>
				<u>50</u>	

15. If the ground water supply is supplemental to an existing water supply, identification of any application for a permit, permit, certificate or adjudicated right to appropriate water made or held by the registrant.

GR-165B

Township E 7 S Range 2 W, W.M.
North

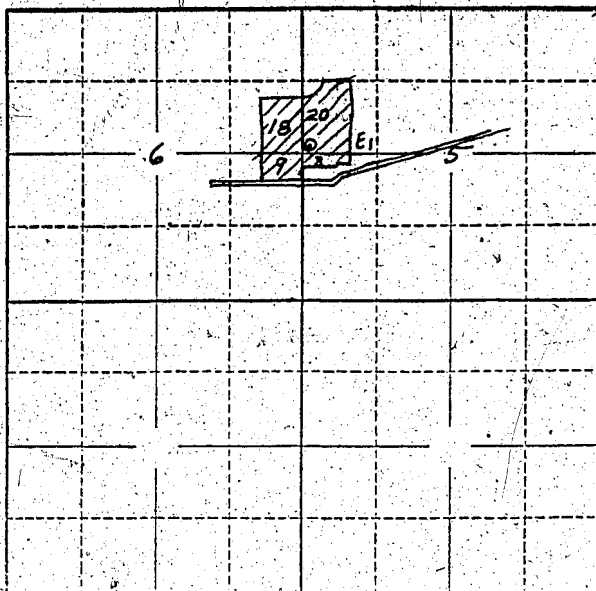

Locate well and acreage of irrigated land on plat.
Scale: 2" = 1 Mile

STATE OF OREGON

County of _____ } ss.

I, Anna M. Wulfmeyer, being first duly sworn, do hereby certify that I have read the foregoing Registration Statement and that all of the items therein contained are true to the best of my knowledge and belief.

Anna M. Wulfmeyer
(Signature of Registrant)

Subscribed and sworn to before me this 9th day of May, 1956

My commission expires _____ (Notary Public)

(SEAL)

CERTIFICATE OF REGISTRATION

STATE OF OREGON

County of Marion } ss.

This is to certify that the foregoing Registration Statement was received in the office of the State Engineer on the 9th day of May, 1956, at 11 o'clock A. M. and has been duly recorded in said office in Book No. 1 of Registration Statements on page GR-165 C.

~~Construction shall be completed by _____ and the work shall be completed by _____~~

~~_____~~

Witness my hand this 8th day of October, 1956

Lewis A. Stanley
(State Engineer)

By _____ (Deputy)

GR-165 C