

RECEIVED
JUN 19 1958
STATE ENGINEER
SALEM, OREGON

Registration No. GR 1752
Certificate No. GR 1699

Registration Statement

OF CLAIMANT OF RIGHT TO APPROPRIATE GROUND WATER

TO THE STATE ENGINEER OF OREGON:

I, Mae Ferguson

of Milton-Freewater, R. #2, box 356 County of Umatilla
(Mailing address)

State of Oregon do hereby make application for a certificate of registration as evidence of a right to appropriate ground water.

1. Source from which water is withdrawn is Pump well
(Flowing well, pump well, infiltration trench, or tunnel)

2. Location is: 2 miles Northwest from Milton-Freewater, Ore.
(Approximate distance and direction from nearest city or town)

and is more particularly described as follows:

(a) a point 665 ft. South from a point 656 ft. East, NW Cor/SE 1/4
Sec. 34 TP. 6 N. R. 35 E. W. 3 R.
being within NW 1/4 of SE 1/4 of Sec. 34, Twp. 6 N., Rge. 35 E.
(Smallest legal subdivision) (N. or S.) (E. or W.)

or (b) within limits of recorded platted property, town or city:

in Lot _____, Block _____ of _____
(Name of plat or addition)

_____ County of Umatilla
(If within city or town, give name)

3. Construction Work was begun on 1916; was completed on 1916
(Date) (Date)

and the ground water claimed was first used for the purposes set out below on 1916
(Date)

since which time the water has been used continuously
(Continuously or intermittently)

from May 1916 to 11 Sept. 1957
(Date) (Date)

4. Quantity of water claimed and used is 230 gallons per minute; 90 acre feet per year.

5. Purpose or Purposes for which water is used Irrigation

(Domestic, irrigation, municipal, manufacturing, industrial, etc.)

6. Description of Well: Depth _____ feet. Type Dug 38', drilled 160 ft.
(Dug or drilled)
Dug part 7' x 7' x 15'
diameter 8 inches. Elevation of ground at well site Approx 900 feet, mean sea level.
(As near as known)

Depth to water table 30 feet. June 1st.

7. Capacity of Well: 230 g.p.m. with 30 feet drawdown.
_____ g.p.m. with _____ feet drawdown.

Date of test unknown

If Flowing Well: Measured discharge _____ g.p.m. on _____
(Date)

Shut-in pressure at ground surface _____ lbs. per sq. in. on _____
(Date)

Water is controlled by _____
(Cap, valve, etc.)

If log of well is not available, give name and address of driller.

~~Driller unknown~~

11. Infiltration Trench: Covered or open

Dimensions: Length ft. Minimum depth ft. Maximum depth ft.

Bottom width ft. Discharge g.p.m. Date of test

12. Tunnel: Type of lining

Dimensions:
(Length, course, and cross sectional size)

Position of water bearing stratum with reference to portal of tunnel

Log of tunnel: (Preceding table for log of well may be used, if desired. Give footage from portal and character of materials, as pertinent.)

13. Pumping Equipment:

(a) Pump 2, 1/2 or 3 in pump Capacity 300 g.p.m.
(Make, type and size)

(b) Motor 3 H.P. 3 phase motor
(Type and horsepower)

14. Location of area irrigated or to be irrigated, or place of use if for purposes other than irrigation.

Township North or South	Range E. or W. of Willamette Meridian	Section	Forty-acre Tract	Number Acres To Be Irrigated	Date of Reclamation
6 n.	35 E.	34	nW of SE 1/4	11	1916

Property in name of Mae Ferguson, surviving spouse of Bert Ferguson, an Estate by Entirety.

Commencing at the Northwest corner of the Southeast Quarter of Section 34, Township 6 North, Range 35; running thence South 665.23 feet; thence at right angles East 332.4 feet; thence at right angles South 131.05 feet; thence at right angles East 332.4 feet to the East line of that tract of land conveyed to C. W. Rasmussen and Marieta L. Rasmussen, husband and wife, by deed recorded in Book 177 at Page 311, Deed Records of Umatilla County, Oregon; thence North along the East line of said Rasmussen tract a distance of 796.23 feet to the Northeast corner thereof; thence West 664.3 feet to the place of beginning.

All being East of the Willamette Meridian, in the County of Umatilla and State of Oregon;

Excepting the North 15 feet thereof for road purposes, and also excepting any and all water rights of way. + 20 feet for road along west side

15. If the ground water supply is supplemental to an existing water supply, identification of any application for a permit, permit, certificate or adjudicated right to appropriate water made or held by the registrant.

Supplemental to permit from Pleasantview Irr.CO. 1912

Township 6N Range 35E, W.M.
North

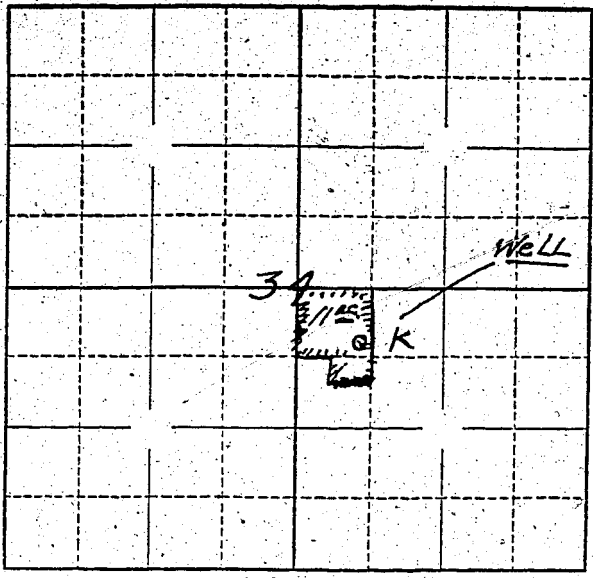

Locate well and acreage of irrigated land on plat.

Scale: ~~2"~~ 1 Mile
4" = 1 M.

STATE OF OREGON

County of Umatilla } ss.

I, Mae Ferguson being first duly sworn, do hereby certify that I have read the foregoing Registration Statement and that all of the items therein contained are true to the best of my knowledge and belief.

Mae Ferguson
(Signature of Registrant)

Subscribed and sworn to before me this 16th day of June, 1950.

My commission expires 1/26/1952

G. H. Bishop
(Notary Public) of Oregon
My commission expires 1/26/1952

(SEAL)

CERTIFICATE OF REGISTRATION

STATE OF OREGON }
County of Marion } ss.

This is to certify that the foregoing Registration Statement was received in the office of the State Engineer on the 19th day of June, 1950, at 1:00 o'clock P.M. and has been duly recorded in said office in Book No. 8 of Registration Statements on page GR-1699

Witness my hand this 7th day of January, 1959

Lewis A. Stanley
(State Engineer)

#1500

By _____
(Deputy)