

RECEIVED  
JUN 20 1953

STATE ENGINEER  
SALEM, OREGON

Registration No. GR-1252

Certificate No. GR 1702

# Registration Statement

## OF CLAIMANT OF RIGHT TO APPROPRIATE GROUND WATER

TO THE STATE ENGINEER OF OREGON:

I, Bert J. Marshall

of 138 Vilas Road (West) Central Point, County of Jackson

(Mailing address)

State of Oregon, do hereby make application for a certificate of registration as evidence of a right to appropriate ground water.

1. Source from which water is withdrawn is pump well  
(Flowing well, pump well, infiltration trench, or tunnel)

2. Location is: 2 1/2 miles Northeast of Central Point, Oregon  
(Approximate distance and direction from nearest city or town)

and is more particularly described as follows:

(a) 265 feet north and 740 feet west from S 1/4 corner Section 36  
(Give distance and bearing to corner of section or other legal subdivision)

being within E 1/2 E 1/2 W 1/2 SE 1/4 SW 1/4 of Sec. 36, Twp. 36 S., Rge. 2 W.  
(Smallest legal subdivision) (N. or S.) (E. or W.)

or (b) within limits of recorded platted property, town or city:

in Lot \_\_\_\_\_, Block \_\_\_\_\_ of \_\_\_\_\_  
(Name of plat or addition)

\_\_\_\_\_ County of \_\_\_\_\_  
(If within city or town, give name)

3. Construction Work was begun on 1951; was completed on 1951  
(Date) (Date)

and the ground water claimed was first used for the purposes set out below on 1951  
(Date)

since which time the water has been used intermittently  
(Continuously or intermittently)

from 1951 to present  
(Date) (Date)

4. Quantity of water claimed and used is 12 gallons per minute; 9.0 acre feet per year.

5. Purpose or Purposes for which water is used irrigation

(Domestic, irrigation, municipal, manufacturing, industrial, etc.)

6. Description of Well: Depth 68 feet. Type drilled  
(Dug or drilled)

diameter 6.0 inches. Elevation of ground at well site 1280 feet, mean sea level.  
(As near as known)

Depth to water table 20 Est. feet.

7. Capacity of Well: \_\_\_\_\_ g.p.m. with \_\_\_\_\_ feet drawdown.

\_\_\_\_\_ g.p.m. with \_\_\_\_\_ feet drawdown.

Date of test none

If Flowing Well: Measured discharge \_\_\_\_\_ g.p.m. on \_\_\_\_\_  
(Date)

Shut-in pressure at ground surface \_\_\_\_\_ lbs. per sq. in. on \_\_\_\_\_  
(Date)

Water is controlled by \_\_\_\_\_  
(Cap, valve, etc.)

D

8. Casing: (Give diameter, commercial specifications and depth below ground surface of each casing size.)

6.0 inch diameter steel casing from 0 to 60 (est) feet  
 . inch diameter from to feet  
 . inch diameter from to feet  
 . inch diameter from to feet

Describe and show depth of shoe, plug, adapter, liner or other details: not known

9. Perforated Casings or Screens:

(Number per foot and size of perforations, or describe screen) from to  
 not known from to  
 from to  
 from to

10. Log of Well: (Describe each stratum or formation clearly, indicate if water bearing, and give thickness and depth as indicated.)

MATERIAL	Thickness (Feet)	Depth to Bottom (Feet)
not known		

If log of well is not available, give name and address of driller. ..... not known

11. Infiltration Trench: Covered or open .....

Dimensions: Length  $5\frac{1}{2}$  ft. Minimum depth ..... ft. Maximum depth ..... ft.

Bottom width ..... ft. Discharge ..... g.p.m. Date of test .....

12. Tunnel: Type of lining .....

Dimensions: .....  
(Length, course, and cross sectional size)

Position of water bearing stratum with reference to portal of tunnel .....

Log of tunnel: (Preceding table for log of well may be used, if desired. Give footage from portal and character of materials, as pertinent.)

13. Pumping Equipment: ..... system)

(a) Pump 1.0" x 3/4" jet (Wards) (pressure / Capacity 12 (est.) g.p.m.)  
(Make, type and size)

(b) Motor 3/4 H.P. electric motor (Wards)  
(Type and horsepower)

14. Location of area irrigated or to be irrigated, or place of use if for purposes other than irrigation.

Township North or South	Range E. or W. of Willamette Meridian	Section	Forty-acre Tract	Number Acres To Be Irrigated	Date of Reclamation
36 S.	2 W.	36	$E\frac{1}{2}$ $E\frac{1}{2}$ $W\frac{1}{2}$ $SE\frac{1}{4}$ $SW\frac{1}{4}$	2.0	1951

15. If the ground water supply is supplemental to an existing water supply, identification of any application for a permit, permit, certificate or adjudicated right to appropriate water made or held by the registrant.  
none /

Township 36 S. Range 2 W. W.M.  
North

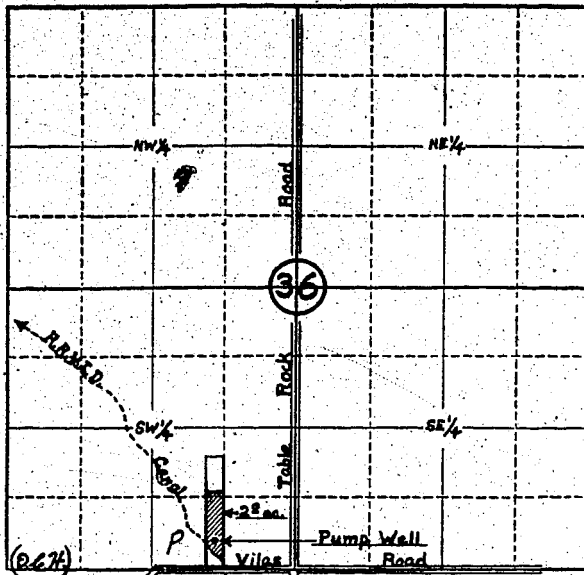

Locate well and acreage of irrigated land on plat.  
Scale: 4" = 1 Mile

STATE OF OREGON

County of Jackson } ss.

I, Bert J. Marshall, being first duly sworn, do hereby certify that I have read the foregoing Registration Statement and that all of the items therein contained are true to the best of my knowledge and belief.

Bert J. Marshall  
(Signature of Registrant)

Subscribed and sworn to before me this 16 day of February, 1937

My commission expires 11-7-31 Robert H. [Signature]  
(Notary Public)

(SEAL)

**CERTIFICATE OF REGISTRATION**

STATE OF OREGON } ss.  
County of Marion

This is to certify that the foregoing Registration Statement was received in the office of the State Engineer on the 20th day of June, 1938, at 9.00 o'clock A.M. and has been duly recorded in said office in Book No. 8 of Registration Statements on page GR-1702

Witness my hand this 7th day of January, 1959.

Lewis A. Stanley  
(State Engineer)

71502

By \_\_\_\_\_ (Deputy)