

RECEIVED JUN 23 1958

STATE ENGINEER SALEM, OREGON

Registration No. GR-1763

Certificate No. GR 1711

Registration Statement

OF CLAIMANT OF RIGHT TO APPROPRIATE GROUND WATER

TO THE STATE ENGINEER OF OREGON:

I, Det Leland C. Ross

of RT. 1, Box 651 Eugene County of L & N C

State of Oregon, do hereby make application for a certificate of registration as evidence of a right to appropriate ground water.

1. Source from which water is withdrawn is Pump well

2. Location is: 5 ML NW Eugene

and is more particularly described as follows:

(a) 2640'S E 2490'W of NW Cor Sec 9

being within NW 1/4 of SE 1/4 of Sec. 9, Twp. 17 S, Rge. 7 W

or (b) within limits of recorded platted property, town or city:

in Lot \_\_\_\_\_, Block \_\_\_\_\_ of \_\_\_\_\_

County of \_\_\_\_\_

3. Construction Work was begun on 8/50; was completed on 9/50

and the ground water claimed was first used for the purposes set out below on 5/20/52

since which time the water has been used intermittently

from MAY to SEPT

4. Quantity of water claimed and used is 270 gallons per minute; 85 acre feet per year.

5. Purpose or Purposes for which water is used \_\_\_\_\_

IRRIG  
(Domestic, irrigation, municipal, manufacturing, industrial, etc.)

6. Description of Well: Depth 22 feet. Type DUG

diameter 60' x 100' inches. Elevation of ground at well site \_\_\_\_\_ feet, mean sea level.

Depth to water table 28 feet.

7. Capacity of Well: \_\_\_\_\_ g.p.m. with \_\_\_\_\_ feet drawdown.

Date of test Not tested

If Flowing Well: Measured discharge \_\_\_\_\_ g.p.m. on \_\_\_\_\_

Shut-in pressure at ground surface \_\_\_\_\_ lbs. per sq. in. on \_\_\_\_\_

Water is controlled by \_\_\_\_\_

8. Casing: (Give diameter, commercial specifications and depth below ground surface of each casing size.)

60' x 100' inch diameter ..... from 0 to 20 feet  
 ..... inch diameter ..... from ..... to ..... feet  
 ..... inch diameter ..... from ..... to ..... feet  
 ..... inch diameter ..... from ..... to ..... feet

Describe and show depth of shoe, plug, adapter, liner or other details: .....

9. Perforated Casings or Screens:

Not apply ..... from ..... to .....  
 (Number per foot and size of perforations, or describe screen).  
 ..... from ..... to .....  
 ..... from ..... to .....  
 ..... from ..... to .....

10. Log of Well: (Describe each stratum or formation clearly, indicate if water bearing, and give thickness and depth as indicated.)

MATERIAL	Thickness (Feet)	Depth to Bottom (Feet)
Not apply		

If log of well is not available, give name and address of driller. \_\_\_\_\_

11. Infiltration Trench: Covered or open \_\_\_\_\_

Dimensions: Length 100' ft. Minimum depth 60 ft. Maximum depth 20 ft.

Bottom width 60 ft. Discharge 240 g.p.m. Date of test \_\_\_\_\_

12. Tunnel: Type of lining \_\_\_\_\_

Dimensions: \_\_\_\_\_  
(Length, course, and cross sectional size)

Position of water bearing stratum with reference to portal of tunnel \_\_\_\_\_

Log of tunnel: (Preceding table for log of well may be used, if desired. Give footage from portal and character of materials, as pertinent.)

13. Pumping Equipment:

(a) Pump Carnel 2 1/2" Centrifugal 10 HP Capacity 240 g.p.m.  
(Make, type and size)

(b) Motor Elec 10 HP  
(Type and horsepower)

14. Location of area irrigated or to be irrigated, or place of use if for purposes other than irrigation.

Township North or South	Range E. or W. of Willamette Meridian	Section	Forty-acre Tract	Number Acres To Be Irrigated	Date of Reclamation
<u>17S</u>	<u>4W</u>	<u>9</u>	<u>SE 1/4 of NW 1/4</u>	<u>20.0</u>	<u>May 1952</u>
<u>17S</u>	<u>4W</u>	<u>9</u>	<u>NW 1/4 of SE 1/4</u>	<u>14.0</u>	<u>"</u>
				<u>34.0</u>	

15. If the ground water supply is supplemental to an existing water supply, identification of any application for a permit, permit, certificate or adjudicated right to appropriate water made or held by the registrant.

\_\_\_\_\_

\_\_\_\_\_

Township 17S Range 7W, W.M.  
North

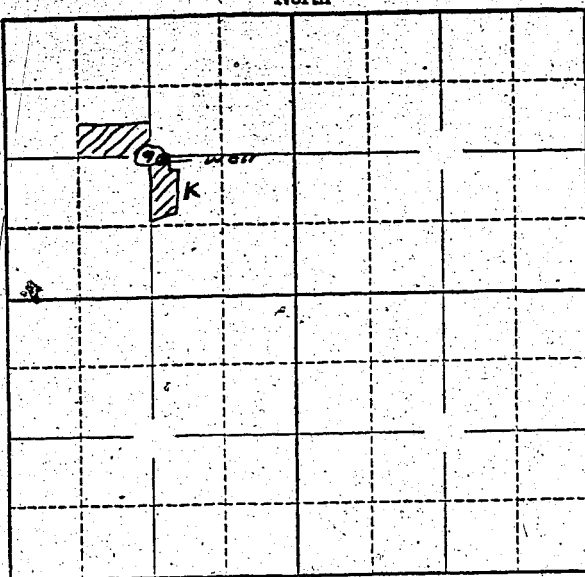

Locate well and acreage of irrigated land on plat.  
Scale: 2" = 1 Mile

STATE OF OREGON

County of Laine } ss.

I, Leland C Ross, being first duly sworn, do hereby certify that I have read the foregoing Registration Statement and that all of the items therein contained are true to the best of my knowledge and belief.

Leland C Ross  
(Signature of Registrant)

Subscribed and sworn to before me this 7th day of June, 1958

My commission expires \_\_\_\_\_  
NOTARY PUBLIC FOR OREGON.  
My Commission Expires Oct. 16, 1959

Robert E. Inman  
(Notary Public)

(SEAL)

**CERTIFICATE OF REGISTRATION**

STATE OF OREGON

County of Marion } ss.

This is to certify that the foregoing Registration Statement was received in the office of the State Engineer on the 23rd day of June, 1958, at 8:00 o'clock A. M. and has been duly recorded in said office in Book No. 8 of Registration Statements on page GR-1711

Witness my hand this 7th day of January, 1959

Lewis A. Stanley  
(State Engineer)

\$15.60

By \_\_\_\_\_  
(Deputy)

GR-1711