

RECEIVED
JUN 23 1953
STATE ENGINEER
SALEM OREGON

Registration No. GR-1268

Certificate No. GR-1715

Registration Statement

OF CLAIMANT OF RIGHT TO APPROPRIATE GROUND WATER

TO THE STATE ENGINEER OF OREGON:

I, JACK MOYE
of P.O. Box 318, Junction City County of LANE
(Mailing address)
State of OREGON, do hereby make application for a certificate of registration as evidence of a right to appropriate ground water.

1. Source from which water is withdrawn is PIED PUMP
(Flowing well, pump well, infiltration trench, or tunnel)
2. Location is: 2 1/2 MILES NORTHWEST JUNCTION CITY, OREGON ON HWY. 99 W.
(Approximate distance and direction from nearest city or town)

and is more particularly described as follows:

(a) 2353' N12° 30' W FROM SE CORNER SECT. 30
(Give distance and bearing to corner of section or other legal subdivision)
being within PORTION OF 1/4, 1/2, 3/4, NE 1/4, SE 1/4 of Sec. 30, Twp. T.15S, Rge. R.4W
(Smallest legal subdivision) (N. or S.) (E. or W.)

or (b) within limits of recorded platted property, town or city:
in Lot _____, Block _____ of _____
(Name of plat or addition)
County of _____
(If within city or town, give name)

3. Construction Work was begun on 1948; was completed on 1948
(Date) (Date)
and the ground water claimed was first used for the purposes set out below on _____
(Date)
since which time the water has been used _____
(Continuously or intermittently)
from 1948 to Oct 1958
(Date) (Date)

4. Quantity of water claimed and used is 25 gallons per minute; 94 acre feet per year.

5. Purpose or Purposes for which water is used IRRIGATION & POSSIBLY DOMESTIC
(Domestic, irrigation, municipal, manufacturing, industrial, etc.)

6. Description of Well: Depth 28 feet. Type _____
(Dug or drilled)
diameter 4 inches. Elevation of ground at well site _____ feet, mean sea level.
(As near as known)
Depth to water table _____ feet.

7. Capacity of Well: _____ g.p.m. with _____ feet drawdown.
_____ g.p.m. with _____ feet drawdown.

Date of test _____

If Flowing Well: Measured discharge _____ g.p.m. on _____
(Date)

Shut-in pressure at ground surface _____ lbs. per sq. in. on _____
(Date)

Water is controlled by _____
(Cap, valve, etc.)

Township 15 S Range 4 W W.M.
North

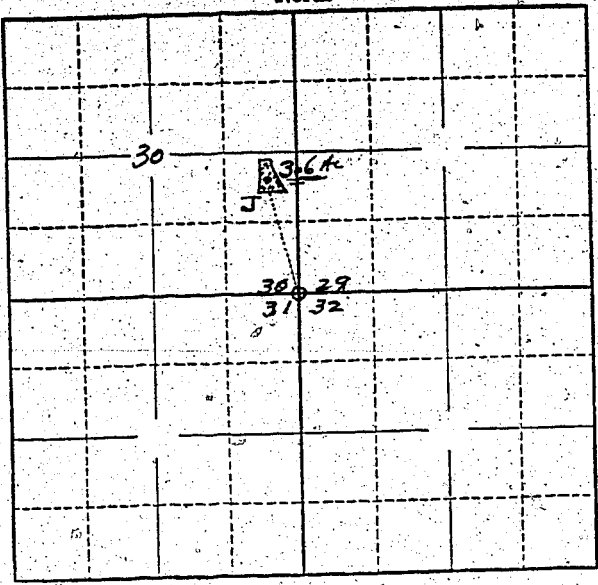

Locate well and acreage of irrigated land on plat.
Scale: 2" = 1 Mile

STATE OF OREGON }
County of Clatsop } ss.

I, Jack Moya, being first duly sworn, do hereby certify that I have read the foregoing Registration Statement and that all of the items therein contained are true to the best of my knowledge and belief.

(Signature of Registrant)

Subscribed and sworn to before me this 20th day of June, 1958

My commission expires March 14, 1962

Herman H. Berglund
(Notary Public)

(SEAL)

CERTIFICATE OF REGISTRATION

STATE OF OREGON }
County of Marion } ss.

This is to certify that the foregoing Registration Statement was received in the office of the State Engineer on the 23rd day of June, 1958, at 6.00 o'clock A.M. and has been duly recorded in said office in Book No. 8 of Registration Statements on page GR-1715

Witness my hand this 7th day of January, 1959

Lewis A. Stanley
(State Engineer)

\$1500

By _____ (Deputy)

GR-1715