

OF CLAIMANT OF RIGHT TO APPROPRIATE GROUND WATER

(Under Chapter 706, Oregon Laws 1955.)

TO THE STATE ENGINEER OF OREGON:

I, Warner C. McCollister

of XXXXXX Sublimity County of XXXXXXXX Marion

State of Oregon, do hereby make application for a certificate of registration as evidence of a right to appropriate ground water.

1. Source from which water is withdrawn is Pump Well
(Flowing well, pump well, infiltration trench, or tunnel)

2. Location is: One half mile north Sublimity.
(Approximate distance and direction from nearest city or town)

and is more particularly described as follows:

(a) APPROX. 500' E. OF SW CORNER OF S.E. QUARTER OF SEC. 27, TWP 9S RGE 1W.
(Give distance and bearing to corner of section or other legal subdivision)

being within SW 1/4 of SW 1/4 of Sec. 27, Twp. 8S, Rge. 1W
(Smallest legal subdivision) (N. or S.) (E. or W.)

or (b) within limits of recorded platted property, town or city:

in Lot _____, Block _____ of _____
(Name of plat or addition)

County of _____
(If within city or town, give name)

3. Construction Work was begun on April 1953; was completed on Feb. 1955
(Date) (Date)

and the ground water claimed was first used for the purposes set out below on July 1955
(Date)

since which time the water has been used Continuously - DOMESTIC
(Continuously or Intermittently)

from May to Oct. Irrigation
(Date) (Date)

4. Quantity of water claimed and used is 90 gallons per minute; _____ acre
feet per year.

5. Purpose or Purposes for which water is used _____

Domestic and Irrigation -- Domestic Continuously.
(Domestic, irrigation, municipal, manufacturing, industrial, etc.)

6. Description of Well: Depth 200 feet. Type Drilled
(Dug or drilled)

diameter 6 inches. Elevation of ground at well site 500 feet, mean sea level.
(As near as known)

Depth to water table 59 feet.

7. Capacity of Well: 90 g.p.m. with 3 feet drawdown.

_____ g.p.m. with _____ feet drawdown.

Date of test: Feb. 11 1955

If Flowing Well: Measured discharge _____ g.p.m. on _____
(Date)

Shut-in pressure at ground surface _____ lbs. per sq. in. on _____
(Date)

Water is controlled by _____
(Cap. valve, etc.)

8. Casing: (Give diameter, commercial specifications and depth below ground surface of each casing size.)

6 inch diameter Surface to 22 Feet Below from to feet
..... inch diameter from to feet
..... inch diameter from to feet
..... inch diameter from to feet

Describe and show depth of shoe, plug, adapter, liner or other details:

9. Perforated Casings or Screens:

(Number per foot and size of perforations, or describe screen) from to
..... from to
..... from to
..... from to

10. Log of Well: (Describe each stratum or formation clearly, indicate if water bearing, and give thickness and depth as indicated.)

MATERIAL	Thickness (Feet)	Depth to Bottom (Feet)

Sec 27+34

Township 8 S Range 1 W, W.M.

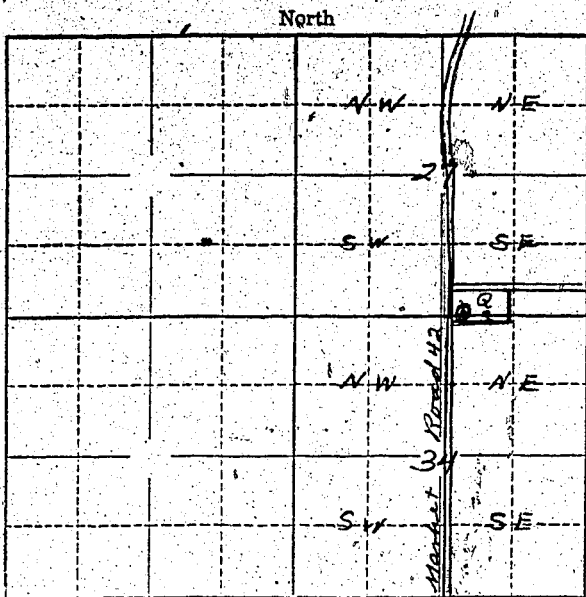

20.04 A in Sec 27
 - 2.88 A in Sec 34
 22.92 A Total

Locate well and acreage of irrigated land on plat.
 Scale: 2" = 1 Mile

STATE OF OREGON

County of _____ } ss.

I, _____, being first duly sworn, do hereby certify that I have read the foregoing Registration Statement and that all of the items therein contained are true to the best of my knowledge and belief.

Warner C. McCallister
 (Signature of Registrant)

Subscribed and sworn to before me this 17 day of June, 1958

My commission expires Oct 16 - 1958
Paul H. [Signature]
 (Notary Public)

(SEAL)

CERTIFICATE OF REGISTRATION

STATE OF OREGON

County of Marion } ss.

This is to certify that the foregoing Registration Statement was received in the office of the State Engineer on the 24th day of June, 1958, at 8:00 o'clock A.M. and has been duly recorded in said office in Book No. 8 of Registration Statements on page GR-1721

~~Construction to be completed by _____ 19____ and the water completely applied and beneficial used by _____ 19____~~

Witness my hand this 7th day of January, 1959

Leura A. Stanley
 (State Engineer)

#1500

By _____
 (Deputy)

GR-1721