

Registration Statement

OF CLAIMANT OF RIGHT TO APPROPRIATE GROUND WATER

TO THE STATE ENGINEER OF OREGON:

We I, Kenneth R. Humke and Elna S. Humke, Husband and wife

of 8022 S. E. 162nd Avenue, Portland 36 County of Multnomah

(Mailing address)

State of Oregon, do hereby make application for a certificate of registration as evidence of a right to appropriate ground water.

1. Source from which water is withdrawn is pump well
(Flowing well, pump well, infiltration trench, or tunnel)

2. Location is: approx. 11 miles southeast from Multnomah County Court House
(Approximate distance and direction from nearest city or town)

and is more particularly described as follows:

(a) NORTH 1293' 0" & EAST 320' FROM S.W. COR. SEC. 19
(Give distance and bearing to corner of section or other legal subdivision)

being within Tax Lot 106 1/2 S.W. 1/4 S.W. 19 of Sec. 19, Twp. 1, S, Rge. 3, E
(Smallest legal subdivision) (N. or S.) (E. or W.)

(b) within limits of recorded platted property, town or city:

in Lot _____; Block _____ of _____
(Name of plat or addition)

County of _____
(If within city or town, give name)

3. Construction Work was begun on Aug. 1, 1951; was completed on Dec. 1, 1951
(Date) (Date)

and the ground water claimed was first used for the purposes set out below on March 1952
(Date)

since which time the water has been used continuously
(Continuously or intermittently)

from March 1, 1952 to present and continuing.
(Date) (Date)

4. Quantity of water claimed and used is 200 gallons per minute; _____ acre feet per year.

5. Purpose or Purposes for which water is used domestic and irrigation

(Domestic, irrigation, municipal, manufacturing, industrial, etc.)

6. Description of Well: Depth 263 feet. Type drilled

(Dug or drilled)

diameter 8 inches. Elevation of ground at well site 290 feet, mean sea level.

(As near as known)

Depth to water table 80 feet.

7. Capacity of Well: 200 g.p.m. with 150 feet drawdown.

_____ g.p.m. with _____ feet drawdown.

Date of test Nov. 1, 1951

If Flowing Well: Measured discharge _____ g.p.m. on _____
(Date)

Shut-in pressure at ground surface _____ lbs. per sq. in. on _____
(Date)

Water is controlled by _____
(Cap, valve, etc.)

Township 1 S Range 3 E W.M.
North

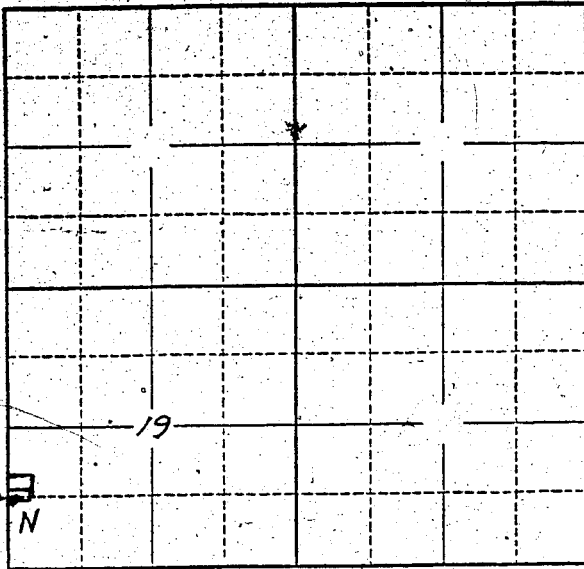

Locate well and acreage of irrigated land on plat.
Scale: 2" = 1 Mile

STATE OF OREGON }
County of Multnomah } ss.

I, Kenneth R. Humke, being first duly sworn, do hereby certify that I have read the foregoing Registration Statement and that all of the items therein contained are true to the best of my knowledge and belief.

Kenneth R. Humke
(Signature of Registrant)

Subscribed and sworn to before me this 11 day of June, 1958

My commission expires MY COMMISSION EXPIRES AUG. 1, 1959
Max Rott
(Notary Public)

(SEAL)

CERTIFICATE OF REGISTRATION

STATE OF OREGON }
County of Marion } ss.

This is to certify that the foregoing Registration Statement was received in the office of the State Engineer on the 24th day of June, 1958, at 8:00 o'clock A.M. and has been duly recorded in said office in Book No. 8 of Registration Statements on page GR-1722

Witness my hand this 3rd day of January, 1959

Laura A. Stanley
(State Engineer)

\$15.00

By _____ (Deputy)

GR-1722