

Registration Statement

OF CLAIMANT OF RIGHT TO APPROPRIATE GROUND WATER

TO THE STATE ENGINEER OF OREGON:

I, MILTON A. PALMER

of Dayton County of Yamhill
(Mailing address)

State of Oregon, do hereby make application for a certificate of registration as evidence of a right to appropriate ground water.

1. Source from which water is withdrawn is Pump well
(Flowing well, pump well, infiltration trench, or tunnel)

2. Location is: 1/4 Sec. 20
(Approximate distance and direction from nearest city or town)

and is more particularly described as follows:

(a) Approximately 150 feet south and 1375 feet east of the Northwest corner of
(Give distance and bearing to corner section or other legal subdivision)

NE 1/4 of NW 1/4 Sec. 20, Twp. 4 S., Rge. 3 W.
(Smallest legal subdivision) (N. or S.) (E. or W.)

or (b) within limits of recorded platted property, town or city:

in Lot 11, Block 10 of Lippincott's Second Addition
(Name of plat or addition)
Dayton County of Yamhill
(If within city or town, give name)

3. Construction Work was begun on June 1948; was completed on June 1948
(Date) (Date)

and the ground water claimed was first used for the purposes set out below on June 1948
(Date)

since which time the water has been used Continuously
(Continuously or intermittently)

from 1948 to June 1948
(Date) (Date)

4. Quantity of water claimed and used is 4 gallons per minute; exempt acre feet per year.

5. Purpose or Purposes for which water is used domestic use for 2 dwelling houses and lumber yard, and irrigation
(Domestic, irrigation, municipal, manufacturing, industrial, etc.)

6. Description of Well: Depth 118 feet. Type drilled
(Dug or drilled)

diameter 6 inches. Elevation of ground at well site feet, mean sea level.
(As near as known)

Depth to water table 60 feet.

7. Capacity of Well: g.p.m. with feet drawdown.
 g.p.m. with feet drawdown.

Date of test

If Flowing Well: Measured discharge g.p.m. on
(Date)

Shut-in pressure at ground surface lbs. per sq. in. on
(Date)

Water is controlled by
(Cap, valve, etc.)

Township 4 S Range 3 W, W.M.
North

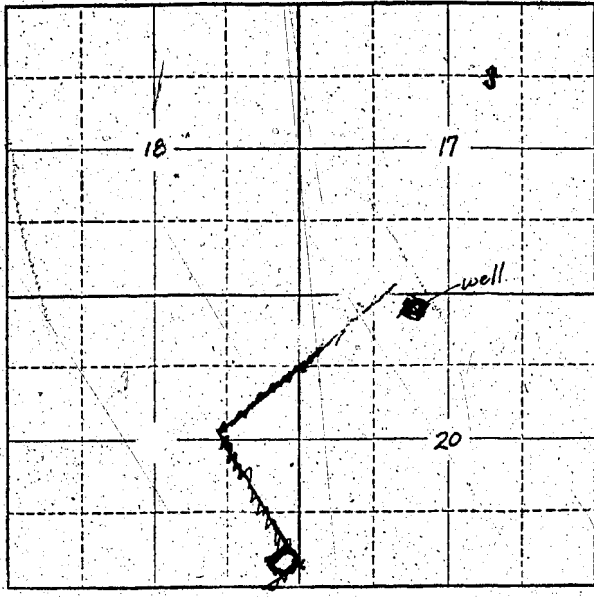

Locate well and acreage of irrigated land on plat.
Scale: 2" = 1 Mile

STATE OF OREGON

County of Yamhill } ss.

I, Milton A. Palmer, being first duly sworn, do hereby certify that I have read the foregoing Registration Statement and that all of the items therein contained are true to the best of my knowledge and belief.

Milton A. Palmer
(Signature of Registrant)

Subscribed and sworn to before me this 17 day of July, 1958.

My commission expires December 1, 1961.

[Signature]
(Notary Public)

(SEAL)

CERTIFICATE OF REGISTRATION

STATE OF OREGON

County of Marion } ss.

This is to certify that the foregoing Registration Statement was received in the office of the State Engineer on the 25th day of June, 1958, at 8:00 o'clock A. M. and has been duly recorded in said office in Book No. 17 of Registration Statements on page GR-4007.

Witness my hand this 14th day of July, 1960.

Lewis A. Stanley
(State Engineer)

By _____ (Deputy)

GR 4007

\$15.00