

# Registration Statement

RECEIVED  
FEB 29 1950

## OF CLAIMANT OF RIGHT TO APPROPRIATE GROUND WATER

STATE ENGINEER

TO THE STATE ENGINEER OREGON:

1. Vern Piskell

of 1739 River Road Junction City, County of Lane

State of Oregon, do hereby make application for a certificate of registration as evidence of a right to appropriate ground water.

1. Source from which water is withdrawn is hand pump well

2. Location is: 2 1/2 miles South east of Junction City

and is more particularly described as follows: 300 feet south & 5 feet east from NW corner Sect. 3

(a) Tax lot 6 of sec. 3 in sec. 7 Twp. 16 S. Rge. 4 W. 4th

being within 1/4 of Sec. 3, Twp. 16 S., Rge. 4 W., 4th

or (b) within limits of recorded platted property, town or city:

in Lot \_\_\_\_\_, Block \_\_\_\_\_ of \_\_\_\_\_

County of \_\_\_\_\_

3. Construction Work was begun on Feb. 10 1949; was completed on same

and the ground water claimed was first used for the purposes set out below on \_\_\_\_\_

since which time the water has been used intermittently

from Feb. 10 1949 to April 1 1958

4. Quantity of water claimed and used is 140 gallons per minute; \_\_\_\_\_ acre feet per year.

5. Purpose or Purposes for which water is used irrigation

6. Description of Well: Depth 19 feet. Type driven pipe

diameter 4 inches. Elevation of ground at well site 310 feet, mean sea level.

Depth to water table 10 feet.

7. Capacity of Well: 750 g.p.m. with 2 feet drawdown.

\_\_\_\_\_ g.p.m. with \_\_\_\_\_ feet drawdown.

Date of test X

If Flowing Well: Measured discharge \_\_\_\_\_ g.p.m. on \_\_\_\_\_

Shut-in pressure at ground surface \_\_\_\_\_ lbs: per sq. in. on \_\_\_\_\_

Water is controlled by \_\_\_\_\_





Township 16S Range 4W, W.M.  
North

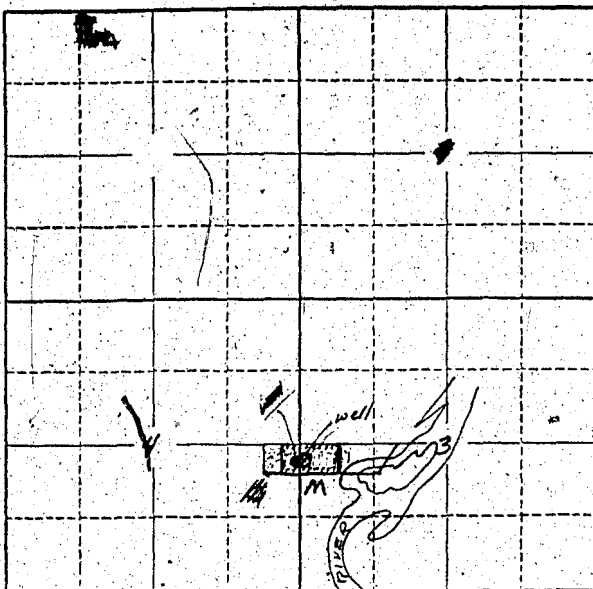

Locate well and acreage of irrigated land on plat.

Scale: 2" = 1 Mile

*2000 ft. 15 a.*

STATE OF OREGON

County of Linn

} ss.

I, Vern Rishell, being first duly sworn, do hereby certify that I have read the foregoing Registration Statement and that all of the items therein contained are true to the best of my knowledge and belief.

*Vern Rishell*  
(Signature of Registrant)

Subscribed and sworn to before me this 27<sup>th</sup> day of June, 1956

My commission expires March 14, 1962

*Walter Boyd*  
(Notary Public)

(SEAL)

**CERTIFICATE OF REGISTRATION**

STATE OF OREGON

County of Marion

} ss.

This is to certify that the foregoing Registration Statement was received in the office of the State Engineer on the 25<sup>th</sup> day of June, 1956, at 8:00 o'clock A.M. and has been duly recorded in said office in Book No. 16 of Registration Statements on page GR-3995

Witness my hand this 15<sup>th</sup> day of March, 1960

*Laura A. Stanley*  
(State Engineer)

By \_\_\_\_\_ (Deputy)

\$ 15.00

GR 3995