

Registration Statement

OF CLAIMANT OF RIGHT TO APPROPRIATE GROUND WATER

TO THE STATE ENGINEER OF OREGON:

I, Jacob John Hauck
of 2836 S E 15 Ave ^{Portland 2, Ore} County of Mult
State of Oregon, do hereby make application for a certificate of registration as evidence of a right to appropriate ground water.

- 1. Source from which water is withdrawn is Bump Well
(flowing well, pump well, infiltration trench, or tunnel)
- 2. Location is: Festy Rd 1 1/4 mile North Gladby, Ore.
(Approximate distance and direction from nearest city or town)

and is more particularly described as follows:

(a) 100' S & 55' W from NE corner SW 1/4 NW 1/4 Section 28
(Give distance and bearing to corner of section or other legal subdivision)
being within SW 1/4 NW 1/4 of Sec. 28, Twp. 35, Rge. 1 E
(Smallest legal subdivision) (N. or S.) (E. or W.)

or within limits of recorded platted property, town or city:

in Lot _____, Block _____ of _____
(Name of plat or addition)
County of Clackamas
(If within city or town, give name)

3. Construction Work was begun on May, 1954; was completed on June 2, 1954
(Date) (Date)
and the ground water claimed was first used for the purposes set out below on June 2, 1954
(Date)

since which time the water has been used Intermittently
(Continuously or intermittently)
from May to October
(Date) (Date)

4. Quantity of water claimed and used is 45 g.p.m. gallons per minute; 9.2 acre feet per year.

5. Purpose or Purposes for which water is used Irrigation
(Domestic, irrigation, municipal, manufacturing, industrial, etc.)

6. Description of Well: Depth 180 feet. Type Drilled
(Dug or drilled)
diameter 7 inches. Elevation of ground at well site _____ feet, mean sea level.
(As near as known)
Depth to water table 47 feet.

7. Capacity of Well: 125 g.p.m. with 106 feet drawdown.
_____ g.p.m. with _____ feet drawdown.

Date of test May 30, 1954

If Flowing Well: Measured discharge _____ g.p.m. on _____
(Date)

Shut-in pressure at ground surface _____ lbs. per sq. in. on _____
(Date)

Water is controlled by _____
(Cap, valve, etc.)

Township 35 Range 1 E W.M.
North

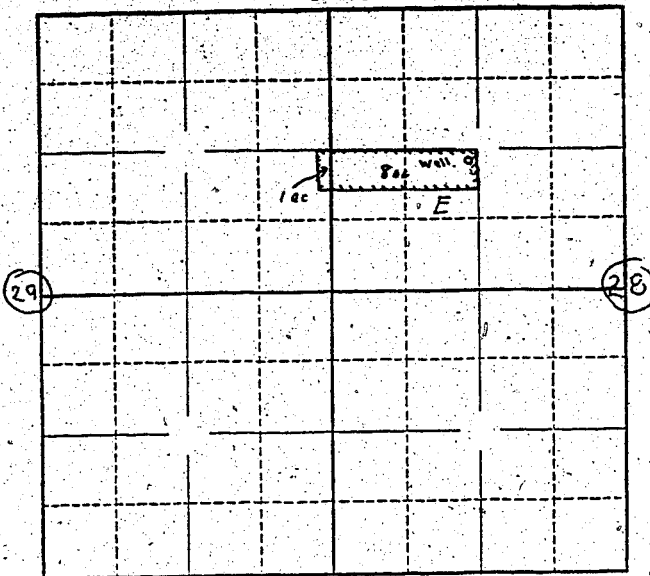

Locate well and acreage of irrigated land on plat.

Scale: $\frac{1}{4}$ - 1 Mile

STATE OF OREGON

County of Marion } ss.

Jacob John Hauch, being first duly sworn, do hereby certify that I have read the foregoing Registration Statement and that all of the items therein contained are true to the best of my knowledge and belief.

Jacob John Hauch
(Signature of Registrant)

Subscribed and sworn to before me this 26th day of June, 19 58

My commission expires 12th June 1961

Wm. S. Bartholomew
(Notary Public)

(SEAL)

CERTIFICATE OF REGISTRATION

STATE OF OREGON

County of Marion } ss.

This is to certify that the foregoing Registration Statement was received in the office of the State Engineer on the 26th day of June, 19 58, at 11:00 o'clock A. M. and has been duly recorded in said office in Book No. 8 of Registration Statements on page GR 1757

Witness my hand this 7th day of January, 19 59

Lewia A. Stanley
(State Engineer)

#1500

By _____ (Deputy)

GR - 1757