

Registration Statement

OF CLAIMANT OF RIGHT TO APPROPRIATE GROUND WATER

TO THE STATE ENGINEER OF OREGON:

I, Refus W Baker & Keith W Baker
of Craig City, Oregon, P.O. Box 709 County of Clatsop
(Mailing address)

State of Oregon do hereby make application for a certificate of registration as evidence of a right to appropriate ground water.

1. Source from which water is withdrawn is Pump Well
(Flowing well, pump well, infiltration trench, or tunnel)

2. Location is: 4 miles south of Astoria
(Approximate distance and direction from nearest city or town)

and is more particularly described as follows:

(a) 351 ft south, 49 ft east of NE corner of Section 22
(Give distance and bearing to corner of section or other legal subdivision)
being within Section 22 of Sec. 22, Twp. 2 S Rge. 2 West
(Smallest legal subdivision) (N. or S.) (E. or W.)

or (b) within limits of recorded platted property, town or city:

in Lot _____, Block _____ of _____
(Name of plat or addition)

County of Clatsop
(If within city or town, give name)

3. Construction Work was begun on May 1955; was completed on June 1955
(Date) (Date)

and the ground water claimed was first used for the purposes set out below on May 1956
(Date)

since which time the water has been used _____
(Continuously or intermittently)

from May 56 to Present date Jan 1958
(Date) (Date)

4. Quantity of water claimed and used is 10 gallons per minute; _____ acre feet per year.

5. Purpose or Purposes for which water is used charging plant & Sanitation
also domestic use
(Domestic, irrigation, municipal, manufacturing, industrial, etc.)

6. Description of Well: Depth 198 feet. Type drilled
(Dug or drilled)

diameter 8 in inches. Elevation of ground at well site 5 feet, mean sea level.
(As near as known)

Depth to water table 160 ft feet.

7. Capacity of Well: 12 g.p.m. with 10 feet drawdown.

_____ g.p.m. with _____ feet drawdown.

Date of test June 1956

If Flowing Well: Measured discharge _____ g.p.m. on _____
(Date)

Shut-in pressure at ground surface _____ lbs. per sq. in. on _____
(Date)

Water is controlled by _____
(Cap, valve, etc.)

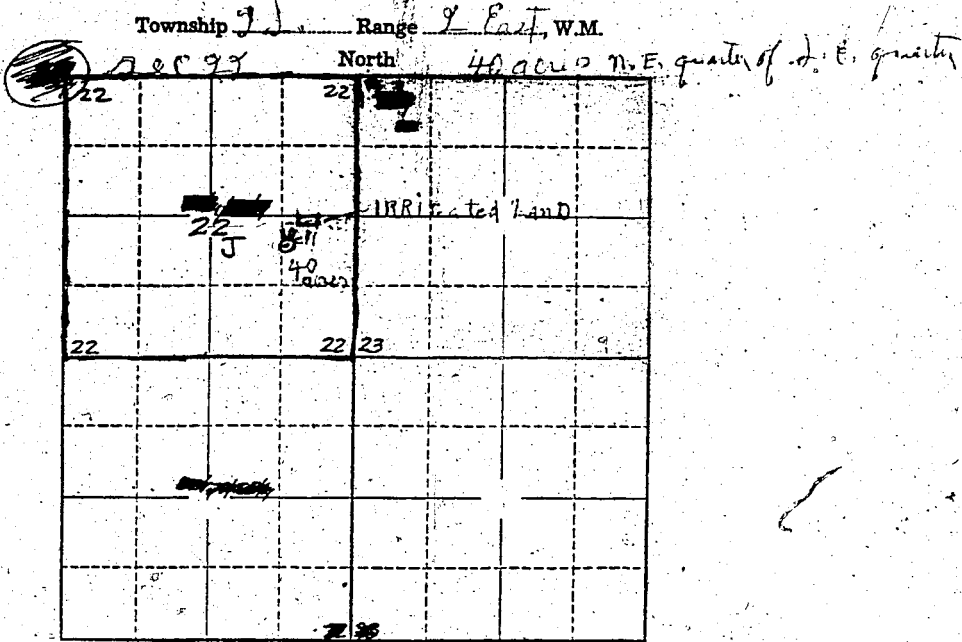

Locate well and acreage of irrigated land on plat.

Scale: $\frac{1}{8}$ - 1 Mile
 $\frac{1}{8}$ 2" = 1 mile OK

STATE OF OREGON

County of Clackamas } ss.

I, R. V. B., being first duly sworn, do hereby certify that I have read the foregoing Registration Statement and that all of the items therein contained are true to the best of my knowledge and belief.

R. V. B.
 (Signature of Registrant)

Subscribed and sworn to before me this 27 day of January, 1959.

My commission expires 1/31/60
 (Notary Public)

(SEAL)

CERTIFICATE OF REGISTRATION

STATE OF OREGON

County of Marion } ss.

This is to certify that the foregoing Registration Statement was received in the office of the State Engineer on the 27th day of January, 1959, at 8:00 o'clock A. M. and has been duly recorded in said office in Book No. 8 of Registration Statements on page GR-1779

Witness my hand this 7th day of January, 1959

Lewis A. Stanley
 (State Engineer)

\$15.00

By _____
 (Deputy)

GR-1779