

Registration Statement

OF CLAIMANT OF RIGHT TO APPROPRIATE GROUND WATER

TO THE STATE ENGINEER OF OREGON:

I, Lud Cook

of Turner P.O. Box 131A

County of Maine

State of _____, do hereby make application for a certificate of registration as evidence of a right to appropriate ground water.

1. Source from which water is withdrawn is Sump
(Flowing well, pump well, infiltration trench, or tunnel)

2. Location is: 6 miles west of Turner
(Approximate distance and direction from nearest city or town)

and is more particularly described as follows:

(a) 750 feet east & 450 feet north from SW corner Section 23
(Give distance and bearing to corner of section or other legal subdivision)

being within SW 1/4 of SW 1/4 of Sec. 23, Twp. 9S, Rge. 2W
(Smallest legal subdivision) (E. or W.)

or (b) within limits of recorded platted property, town or city: _____

in Lot _____, Block _____ of _____
(Name of plat or addition)

County of _____
(If within city or town, give name)

3. Construction Work was begun on 1945; was completed on 1945
(Date) (Date)

and the ground water claimed was first used for the purposes set out below on 1945
(Date)

since which time the water has been used intermittently during season
(Continuously or intermittently)

from 1945 to Oct. 1957
(Date) (Date)

4. Quantity of water claimed and used is 140 gallons per minute; _____ acre feet per year.

5. Purpose or Purposes for which water is used Irrigation

6. Description of Well: Sump Depth _____ feet. Type Dug
(Domestic, irrigation, municipal, manufacturing, industrial, etc.) (Dug or drilled)

diameter _____ inches. Elevation of ground at well site _____ feet, mean sea level.
(As near as known)

Depth to water table 5 feet.

7. Capacity of Well: _____ g.p.m. with _____ feet drawdown.

_____ g.p.m. with _____ feet drawdown.

Date of test _____

If Flowing Well: Measured discharge _____ g.p.m. on _____
(Date)

Shut-in pressure at ground surface _____ lbs. per sq. in. on _____
(Date)

Water is controlled by _____
(Cap, valve, etc.)

Township 9S Range 2W, W.M.
North

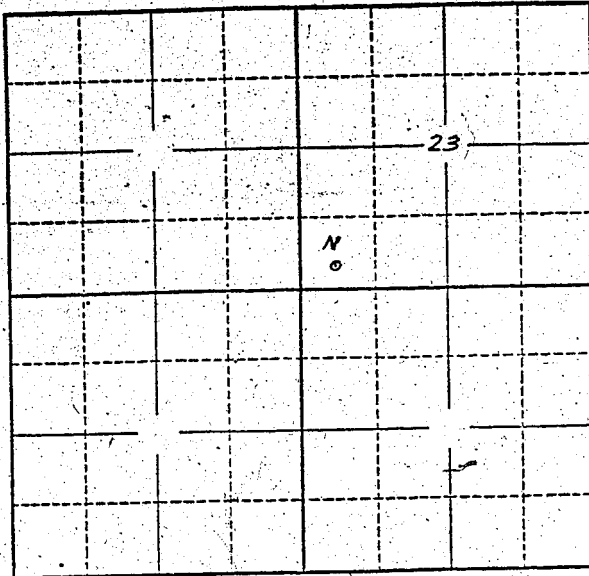

Locate well and acreage of irrigated land on plat.
Scale: 2" = 1 Mile

STATE OF OREGON

County of Marion } ss.

I, Alma Cook, being first duly sworn, do hereby certify that I have read the foregoing Registration Statement and that all of the items therein contained are true to the best of my knowledge and belief.

Alma Cook
(Signature of Registrant)

Subscribed and sworn to before me this 2nd day of July, 1958

My commission expires 12th June 1961 Wm. S. Bartholomew
(Notary Public)

(SEAL)

CERTIFICATE OF REGISTRATION

STATE OF OREGON } ss.
County of Marion

This is to certify that the foregoing Registration Statement was received in the office of the State Engineer on the 2nd day of July, 1958, at 10:30 o'clock A. M. and has been duly recorded in said office in Book No. 8 of Registration Statements on page GR-1825

Witness my hand this 26th day of January, 1959

Lewis A. Starnes
(State Engineer)

\$1,500

By _____ (Deputy)

GR - 1825