

Registration Statement CERTIFICATE NO. GR-172

OF CLAIMANT OF RIGHT TO APPROPRIATE GROUND WATER

(Under Chapter 703, Oregon Laws 1955.)

TO THE STATE ENGINEER OF OREGON:

I, Glen Vaughanof Route 2 Box 378 Springfield County of LaneState of Oregon, do hereby make application for a certificate of registration as evidence of a right to appropriate ground water.1. Source from which water is withdrawn is pump well
(Flowing well, pump well, infiltration trench, or tunnel)2. Location is: 1.4 miles west of WALTERVILLE
(Approximate distance and direction from nearest city or town)

and is more particularly described as follows:

(a) N 13° 39' E 1618 ft. from S.W. Corner N.E. 1/4 Sec. 29
(Give distance and bearing to corner of section or other legal subdivision)being within N.W. 1/4 N.E. 1/4 of Sec. 29, Twp. 17, Rge. 1 W
(Smallest legal subdivision) (N. or S.) (E. or W.)

or (b) within limits of recorded platted property, town or city:

in Lot _____, Block _____ of _____
(Name of plat or addition)(If within city or town, give name) County of Lane3. Construction Work was begun on 6-1-47; was completed on 6-1-47
(Date) (Date)and the ground water claimed was first used for the purposes set out below on 6-15-47
(Date)since which time the water has been used intermittently
(Continuously or Intermittently)from 6-15-47 to 5-9-56
(Date) (Date)4. Quantity of water claimed and used is 150 gallons per minute; _____ acre feet per year.5. Purpose or Purposes for which water is used washing vegetables and irrigationfire protection water for spraying

(Domestic, irrigation, municipal, manufacturing, industrial, etc.)

6. Description of Well: Depth 19 feet. Type 2 points driven

(Dug or drilled)

diameter 2 1/2 inches. Elevation of ground at well site 450 feet, mean sea level.
(As near as known)Depth to water table 18 feet.7. Capacity of Well: 150 g.p.m. with _____ feet drawdown.

_____ g.p.m. with _____ feet drawdown.

Date of test 6-15-47If Flowing Well: Measured discharge _____ g.p.m. on _____
(Date)Shut-in pressure at ground surface _____ lbs. per sq. in. on _____
(Date)Water is controlled by _____
(Cap, valve, etc.)

Township 17 S Range 1 W W.M. North

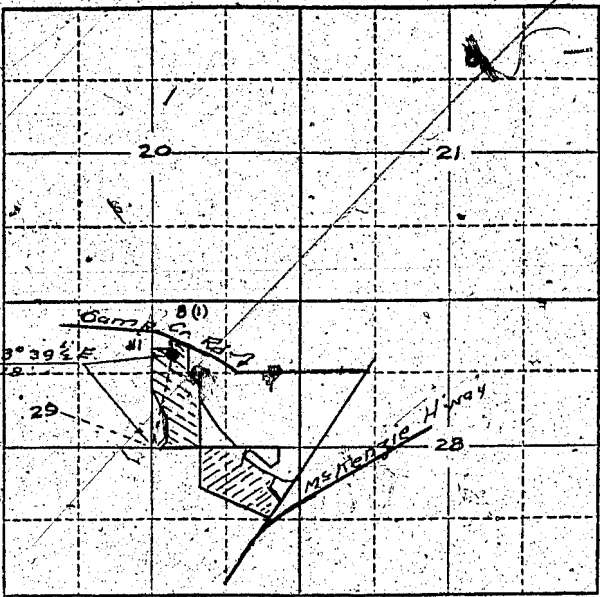

Locate well and acreage of irrigated land on plat. Scale 2" = 1 Mile

STATE OF OREGON

County of Clatsop ss.

I, Glen Vaughan, being first duly sworn, do hereby certify that I have read the foregoing Registration Statement and that all of the items therein contained are true to the best of my knowledge and belief.

Glen Vaughan
(Signature of Registrant)

Subscribed and sworn to before me this 31 day of May, 1950

NOTARY PUBLIC FOR OREGON

My commission expires Feb. 7, 1950 (Notary Public)

(SEAL)

For Certificate See Page GR-178 G
CERTIFICATE OF REGISTRATION

STATE OF OREGON

County of Marion ss.

~~This is a certification of the foregoing Registration Statement as received at the office of the State Engineer on the 19th day of _____, 19____, and the same is hereby certified to be correct and true to the best of my knowledge and belief.~~

Witness my hand this _____ day of _____, 19____

(State Engineer)

By _____ (Deputy)

Registration Statement CERTIFICATE NO. GR-178

OF CLAIMANT OF RIGHT TO APPROPRIATE GROUND WATER

(Under Chapter 708, Oregon Laws 1955.)

TO THE STATE ENGINEER OF OREGON:

Glen Vaughan

I, _____

of Route 2 Box 578 Springfield County of Lane

State of Oregon, do hereby make application for a certificate of registration as evidence of a right to appropriate ground water.

1. Source from which water is withdrawn is pump well #2
(Flowing well, pump well, infiltration trench, or tunnel)

2. Location 1.4 miles west of WALTERVILLE
(Approximate distance and direction from nearest city or town)

and is more particularly described as follows:

(a) N 72° 54' E. 408 ft. from S.W. corner N.E. 1/4 Sec. 29
(Give distance and bearing to corner of section or other legal subdivision)

being within S.W. 1/4 N.E. 1/4 of Sec. 29, Twp. 17-S, Rge. 1-W
(Smallest legal subdivision) (N. or S.) (E. or W.)

or (b) within limits of recorded platted property, town or city: _____

in Lot _____, Block _____ of _____
(Name of plat or addition)

County of Lane
(If within city or town, give name)

3. Construction Work was begun on 5-1-48; was completed on 5-5-48
(Date) (Date)

and the ground water claimed was first used for the purposes set out below on 6-1-48
(Date)

since which time the water has been used intermittently
(Continuously or intermittently)

from 6-1-48 to 5-9-56
(Date) (Date)

4. Quantity of water claimed and used is 120 gallons per minute; _____ acre feet per year.

5. Purpose or Purposes for which water is used irrigation

(Domestic, irrigation, municipal, manufacturing, industrial, etc.)

6. Description of Well: Depth 43 feet. Type drilled
(Dug or drilled)

diameter 8 inches. Elevation of ground at well site 450 feet, mean sea level.
(As near as known)

Depth to water table 25 feet.

7. Capacity of Well: 120 g.p.m. with 5 feet drawdown.

_____ g.p.m. with _____ feet drawdown.

Date of test 5-5-48

If Flowing Well: Measured discharge _____ g.p.m. on _____
(Date)

Shut-in pressure at ground surface _____ lbs. per sq. in. on _____
(Date)

Water is controlled by _____
(Cap, valve, etc.)

Township 17 S. Range 1 W., W.M.

North

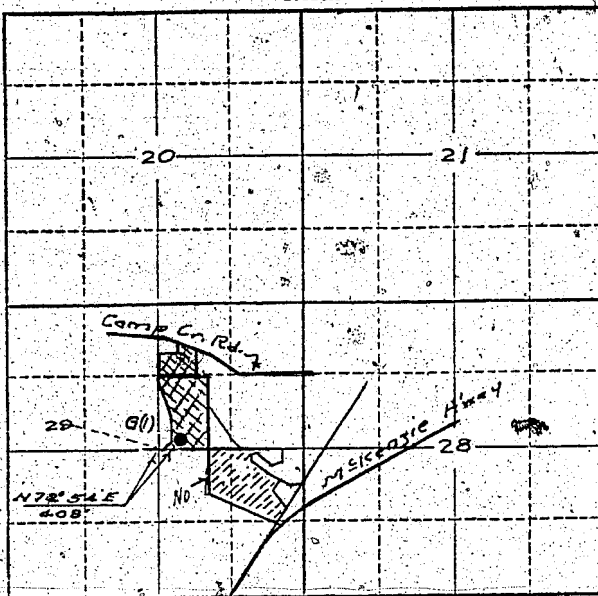

Locate well and acreage of irrigated land on plat:

Scale: 2" = 1 Mile

STATE OF OREGON

County of None

} ss.

I, Allen Vaughn, being first duly sworn, do hereby certify that I have read the foregoing Registration Statement and that all of the items therein contained are true to the best of my knowledge and belief.

Allen Vaughn
(Signature of Registrant)

Subscribed and sworn to before me this 31 day of May, 1956

NOTARY PUBLIC FOR OREGON

My commission expires Feb. 7, 1960

[Signature]
(Notary Public)

(SEAL)

CERTIFICATE OF REGISTRATION

STATE OF OREGON

County of Marion

} ss.

This is to certify that the foregoing Registration Statement was received in the office of the State Engineer on the 31st day of May, 1956, at 9 o'clock A.M. and has been duly recorded in said office in Book No. 1 of Registration Statements on page GR-178 G

Witness my hand this 8th day of October, 1956

[Signature]
(State Engineer)

By _____ (Deputy)

GR-178 G