

Registration Statement

OF CLAIMANT OF RIGHT TO APPROPRIATE GROUND WATER

TO THE STATE ENGINEER OF OREGON:

I, ELTON J. SYBRANT

of Box 411 Drain, Oregon County of Douglas
(Mailing address)

State of Oregon, do hereby make application for a certificate of registration as evidence of a right to appropriate ground water.

1. Source from which water is withdrawn is DUMP well
(Flowing well, pump well, infiltration trench, or tunnel)

2. Location is: 1 1/2 miles S. W. of Drain, Douglas County, Oregon
(Approximate distance and direction from nearest city or town)

and is more particularly described as follows:

(a) 490 feet north & 1000 feet east from W 1/4 corner Section 18
(Give distance and bearing to corner of section or other legal subdivision)

being within SW 1/4 of NW 1/4 of Sec. 18, Twp. 22 S, Rge. 5 W
(Smallest legal subdivision) (N. or S.) (E. or W.)

or (b) within limits of recorded platted property, town or city:

in Lot five + Part of Lot 4, Block none of Meadowview Acres
(Name of plat or addition)

(If within city or town, give name) County of Douglas

3. Construction Work was begun on July 28, 1953; was completed on Aug. 1, 1953
(Date) (Date)

and the ground water claimed was first used for the purposes set out below on Aug. 8, 1953
(Date)

since which time the water has been used continuously during periods needing irrigation
(Continuously or intermittently)

from Aug. 8, 1953 to presently using.
(Date) (Date)

4. Quantity of water claimed and used is 12 gallons per minute; _____ acre feet per year.

5. Purpose or Purposes for which water is used irrigation of family garden plot and lawn. Irrigation of all of Lot 5 + Part of Lot 4, Meadowview Acres.
(Domestic, irrigation, municipal, manufacturing, industrial, etc.)

6. Description of Well: Depth 75 feet. Type drilled
(Dug or drilled)

diameter 5 inches. Elevation of ground at well site about 300 feet, mean sea level.
(As near as known)

Depth to water table 40 ? feet.

7. Capacity of Well: 25 g.p.m. with ? feet drawdown.

_____ g.p.m. with _____ feet drawdown.

Date of test Aug. 1, 1953

If Flowing Well: Measured discharge _____ g.p.m. on _____
(Date)

Shut-in pressure at ground surface _____ lbs. per sq. in. on _____
(Date)

Water is controlled by _____
(Cap. valve, etc.)

8. Casing: (Give diameter, commercial specifications and depth below ground surface of each casing size.)

5 inch diameter from TOP GROUND to 22 feet

inch diameter from to feet

inch diameter from to feet

inch diameter from to feet

Describe and show depth of shoe, plug, adapter, liner or other details: _____

FOOT VALVE AT 75 FT.

9. Perforated Casings or Screens:

NONE

(Number per foot and size of perforations, or describe screen)

from to

from to

from to

from to

10. Log of Well: (Describe each stratum or formation clearly, indicate if water bearing, and give thickness and depth as indicated.)

MATERIAL	Thickness (Feet)	Depth to Bottom (Feet)

If log of well is not available, give name and address of driller. Preston Russel

Lorans Rd., Cottage Grove, Oregon

11. Infiltration Trench: Covered or open _____

Dimensions: Length _____ ft. Minimum depth _____ ft. Maximum depth _____ ft.

Bottom width _____ ft. Discharge _____ g.p.m. Date of test _____

12. Tunnel: Type of lining _____

Dimensions: _____
(Length, course, and cross sectional size)

Position of water-bearing stratum with reference to portal of tunnel _____

Log of tunnel: (Preceding table for log of well may be used, if desired. Give footage from portal and character of materials, as pertinent.)

13. Pumping Equipment:

(a) Pump Pacific Electric Capacity 12 g.p.m.
(Make, type and size)

(b) Motor 3/4 horse electric
(Type and horsepower)

14. Location of area irrigated or to be irrigated, or place of use if for purposes other than irrigation.

Township North or South	Range E. or W. of Willamette Meridian	Section	Forty-acre Tract	Number Acres To Be Irrigated	Date of Reclamation
<u>22 South</u>	<u>5 W.</u>	<u>18</u>	<u>SW4 NW4</u>	<u>2.75</u>	<u>1953</u>

15. If the ground water supply is supplemental to an existing water supply, identification of any application for a permit, permit, certificate or adjudicated right to appropriate water made or held by the registrant.

None

Township 22 South Range 5 W. WM, W.M.
North

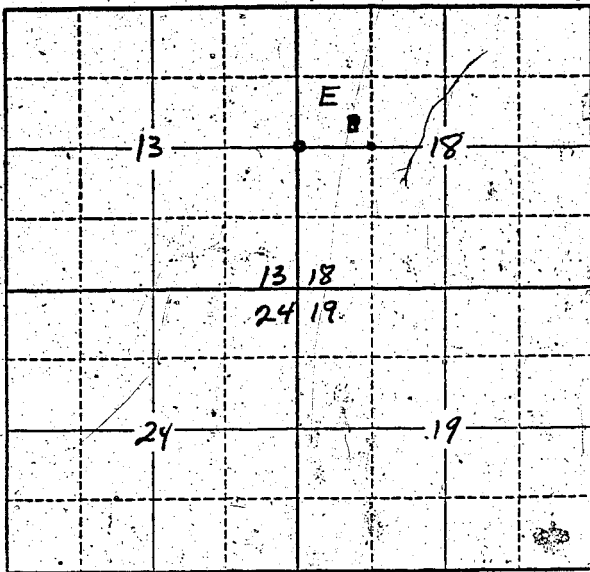

See attached
Plat

Locate well and acreage of irrigated land on plat.
Scale: 2" = 1 Mile

STATE OF OREGON

County of Douglas

} ss.

I, Elton J. Sybrant, being first duly sworn, do hereby certify that I have read the foregoing Registration Statement and that all of the items therein contained are true to the best of my knowledge and belief.

Elton J. Sybrant
(Signature of Registrant)

Subscribed and sworn to before me this June day of 1958

My commission expires March 24, 1960

Ernest A. Seaton
(Notary Public)

(SEAL)

CERTIFICATE OF REGISTRATION

STATE OF OREGON

County of Marion

} ss.

This is to certify that the foregoing Registration Statement was received in the office of the State Engineer on the 7th day of July, 1958, at 8:00 o'clock A.M. and has been duly recorded in said office in Book No. 8 of Registration Statements on page GR-1858

Witness my hand this 26th day of January, 1959

Lewis A. Stanley
(State Engineer)

By _____
(Deputy)

GR-1858

\$1500