

State Engineer
251 State Finance Bldg.
Salem, Or.

Registration No. GR 1947
Certificate No. GR 1874

Registration Statement

OF CLAIMANT OF RIGHT TO APPROPRIATE GROUND WATER

TO THE STATE ENGINEER OF OREGON:

I, Jeffrey S. Clagston
of 28300 N.W. Sunrise Lane County of Washington
(Mailing address)

State of Oregon, do hereby make application for a certificate of registration as evidence of a right to appropriate ground water.

1. Source from which water is withdrawn is Pump Well
(Flowing well, pump well, infiltration trench, or tunnel)

2. Location is: 1 1/4 miles N.E. City Center of Heilbron Oreg.
(Approximate distance and direction from nearest city or town)

and is more particularly described as follows:

(a) 620' E & 720' N of SW cor of Section 29
(Give distance and bearing to corner of section or other legal subdivision)

being within SW 1/4 of SW 1/4 of Sec. 29, Twp. 1N, Rge. 2 W. W.M.
(Smallest legal subdivision) (N. or S.) (E. or W.)

or (b) within limits of recorded platted property, town or city:

in Lot _____, Block _____ of _____
(Name of plat or addition)

County of _____
(If within city or town, give name)

3. Construction Work was begun on Oct 1948; was completed on Oct 1948
(Date) (Date)

and the ground water claimed was first used for the purposes set out below on 1949
(Date)

since which time the water has been used _____
(Continuously or intermittently)

from 1949 to 1958
(Date) (Date)

4. Quantity of water claimed and used is 20 gallons per minute; 12.5 acre feet per year.

5. Purpose or Purposes for which water is used Domestic and irrigation

(Domestic, irrigation, municipal, manufacturing, industrial, etc.)

6. Description of Well: Depth 31 feet. Type drilled
(Dug or drilled)

diameter 16 inches. Elevation of ground at well site 245 feet, mean sea level.
(As near as known)

Depth to water table 14 feet.

7. Capacity of Well: 20 g.p.m. with 5 feet drawdown.

_____ g.p.m. with _____ feet drawdown.

Date of test July 3-58

If Flowing Well: Measured discharge _____ g.p.m. on _____
(Date)

Shut-in pressure at ground surface _____ lbs. per sq. in. on _____
(Date)

Water is controlled by _____
(Cap, valve, etc.)

8. Casing: (Give diameter, commercial specifications and depth below ground surface of each casing size.)

12 inch diameter *concrete pipe* from *8.2* to *31* feet
 inch diameter from to feet
 inch diameter from to feet
 inch diameter from to feet

Describe and show depth of shoe, plug, adapter, liner or other details:

.....

.....

9. Perforated Casings or Screens:

NO from to
(Number per foot and size of perforations, or describe screen)
 from to
 from to
 from to

10. Log of Well: (Describe each stratum or formation clearly, indicate if water bearing, and give thickness and depth as indicated.)

MATERIAL	Thickness (Feet)	Depth to Bottom (Feet)
<i>unk. - sands</i>		

If log of well is not available, give name and address of driller. Claude P. Perkins

Rt 1 Box 262 Banks Oreg

11. Infiltration Trench: Covered or open _____

Dimensions: Length _____ ft. Minimum depth _____ ft. Maximum depth _____ ft.

Bottom width _____ ft. Discharge _____ g.p.m. Date of test _____

12. Tunnel: Type of lining _____

Dimensions: _____
(Length, course, and cross sectional size)

Position of water bearing stratum with reference to portal of tunnel _____

Log of tunnel: (Preceding table for log of well may be used, if desired. Give footage from portal and character of materials, as pertinent.)

13. Pumping Equipment:

(a) Pump Sta-Rite Jet 1 1/2 inch - Discharge Capacity 20 g.p.m.
(Make, type and size)

(b) Motor 3/4 Elect.
(Type and horsepower)

14. Location of area irrigated or to be irrigated, or place of use if for purposes other than irrigation.

Township North or South	Range E. or W. of Willamette Meridian	Section	Forty-acre Tract	Number Acres To Be Irrigated	Date of Reclamation
T1N	R2W	29	sw 1/4 sw 1/4	4.5	1948

15. If the ground water supply is supplemental to an existing water supply, identification of any application for a permit, permit, certificate or adjudicated right to appropriate water made or held by the registrant.

Township 1N Range 2W, W.M.
North

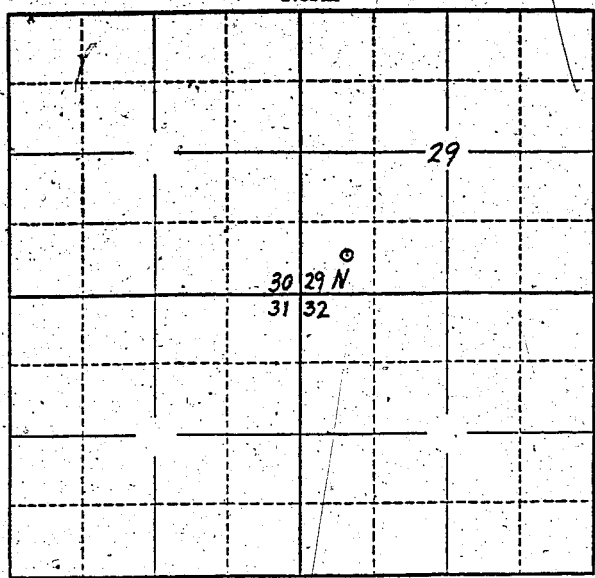

Locate well and acreage of irrigated land on plat.
Scale: 2" = 1 Mile

STATE OF OREGON }
County of Marion } ss.

I, Jeffrey B. Clouston, being first duly sworn, do hereby certify that I have read the foregoing Registration Statement and that all of the items therein contained are true to the best of my knowledge and belief.

Jeffrey B. Clouston
(Signature of Registrant)

Subscribed and sworn to before me this 7th day of July, 1958

My commission expires 12th June 1961 Wm. S. Bartholomew
(Notary Public)

(SEAL)

CERTIFICATE OF REGISTRATION

STATE OF OREGON }
County of Marion } ss.

This is to certify that the foregoing Registration Statement was received in the office of the State Engineer on the 8th day of July, 1958, at 8:00 o'clock A. M. and has been duly recorded in said office in Book No. 8 of Registration Statements on page GR-1874

Witness my hand this 26th day of January, 1959
Lewis A. Stanley
(State Engineer)

\$15.00

By _____
(Deputy)

GR-1874