

Registration No. GR - 1958

Certificate No. GR - 1881

Registration Statement

OF CLAIMANT OF RIGHT TO APPROPRIATE GROUND WATER

TO THE STATE ENGINEER OF OREGON:

I, Walter P. Mang, 3123 Linden Lane

of Central Point County of Jackson
(Mailing address)

State of Oregon, do hereby make application for a certificate of registration as evidence of a right to appropriate ground water.

1. Source from which water is withdrawn is Infiltration Trench
(Flowing well, pump well, infiltration trench, or tunnel)

2. Location is: 1 1/2 miles South West of Central Point
(Approximate distance and direction from nearest city or town)

and is more particularly described as follows:

(a) 515 Feet N. and 385 Feet West of Sec. Corner 9 10 15 16
(Give distance and bearing to corner of section or other legal subdivision)

being within SE 1/4 SE 1/4 of Sec. 9, Twp. 37 S, Rge. 2W
(Smallest legal subdivision) (T. or S.) (E. or W.)

or (b) within limits of recorded platted property, town or city:

in Lot _____, Block _____ of _____
(Name of plat or addition)

County of _____
(If within city or town, give name)

3. Construction Work was begun on Oct. 8, 1953; was completed on Oct. 17, 1953
(Date) (Date)

and the ground water claimed was first used for the purposes set out below on May 1, 1954
(Date)

since which time the water has been used Intermittently
(Continuously or Intermittently)

from May 1, 1954 to October
(Date) (Date)

4. Quantity of water claimed and used is 112 gallons per minute; 47 acre feet per year.

5. Purpose or Purposes for which water is used Irrigation

(Domestic, irrigation, municipal, manufacturing, industrial, etc.)

6. Description of Well: Depth _____ feet. Type Dug
(Dug or drilled)

diameter _____ inches. Elevation of ground at well site _____ feet, mean sea level.
(As near as known)

Depth to water table _____ feet.

7. Capacity of Well: _____ g.p.m. with _____ feet drawdown.

_____ g.p.m. with _____ feet drawdown.

Date of test _____

If Flowing Well: Measured discharge _____ g.p.m. on _____
(Date)

Shut-in pressure at ground surface _____ lbs. per sq. in. on _____
(Date)

Water is controlled by _____
(Cap, valve, etc.)

8. Casing: (Give diameter, commercial specifications and depth below ground surface of each casing size.)

..... inch diameter *2 1/2* from to feet
 inch diameter from to feet
 inch diameter from to feet
 inch diameter from to feet

Describe and show depth of shoe, plug, adapter, liner or other details:

9. Perforated Casings or Screens:

..... *Sump* from to
 (Number per foot and size of perforations, or describe screen)
 from to
 from to
 from to

10. Log of Well: (Describe each stratum or formation clearly, indicate if water bearing, and give thickness and depth as indicated.)

MATERIAL	Thickness (Feet)	Depth to Bottom (Feet)
<i>Sump</i>		

If log of well is not available, give name and address of driller. True, Mix Concrete Company
Madford, Oregon

11. Infiltration Trench: Covered or open OPEN

Dimensions: Length 50 ft. Minimum depth 14 ft. Maximum depth 16 ft.

Bottom width 20 ft. Discharge _____ g.p.m. Date of test _____

12. Tunnel: Type of lining _____

Dimensions: _____
(Length, course, and cross sectional size)

Position of water bearing stratum with reference to portal of tunnel _____

Log of tunnel: (Preceding table for log of well may be used, if desired. Give footage from portal and character of materials, as pertinent.)

13. Pumping Equipment:

(a) Pump 1.5 inch Centrifugal pump (Berkeley) Capacity 112 g.p.m.
(Make, type and size)

(b) Motor 5 H. P. electric motor
(Type and horsepower)

14. Location of area irrigated or to be irrigated, or place of use if for purposes other than irrigation.

Township - North or South	Range E. or W. of Willamette Meridian	Section	Forty-acre Tract	Number Acres To Be Irrigated	Date of Reclamation
<u>37 S.</u>	<u>2W.</u>	<u>9</u>	<u>SE₂ SE₄</u>	<u>10.3</u>	<u>May 1, 1954</u>

15. If the ground water supply is supplemental to an existing water supply, identification of any application for a permit, permit, certificate or adjudicated right to appropriate water made or held by the registrant.
none

Township 37 S. Range 2W. W.M.
North

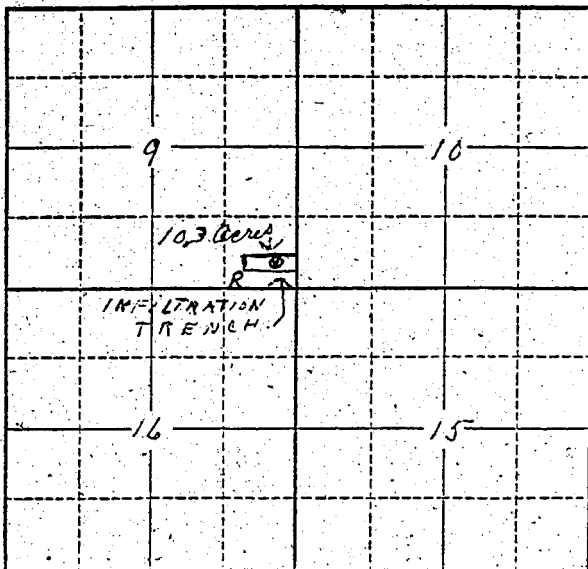

Locate well and acreage of irrigated land on plat.
Scale: 2" = 1 Mile

STATE OF OREGON

County of Jackson } ss.

I, Walter P. Moss, being first duly sworn, do hereby certify that I have read the foregoing Registration Statement and that all of the items therein contained are true to the best of my knowledge and belief.

Walter P. Moss
(Signature of Registrant)

Subscribed and sworn to before me this 7th day of July, 1958.

My commission expires Nov 23 - 1960

L. A. Struble
(Notary Public)

(SEAL)

CERTIFICATE OF REGISTRATION

STATE OF OREGON

County of Marion } ss.

This is to certify that the foregoing Registration Statement was received in the office of the State Engineer on the 8th day of July, 1958, at 8.00 o'clock A.M. and has been duly recorded in said office in Book No. 9 of Registration Statements on page GR-1884

Witness my hand this 26th day of January, 1959.

Lewis A. Struble
(State Engineer)

By _____ (Deputy)

GR-1884