

RECEIVED
JUL 9 1958

STATE ENGINEER
SALEM, OREGON

Registration No. GR - 1977

Certificate No. GR - 1908

Registration Statement

OF CLAIMANT OF RIGHT TO APPROPRIATE GROUND WATER

TO THE STATE ENGINEER OF OREGON:

I, I. P. and Lillian Crist

of Rt 3 Corvallis County of Benton
(Mailing address)

State of Oregon, do hereby make application for a certificate of registration as evidence of a right to appropriate ground water.

1. Source from which water is withdrawn is Pump
(Flowing well, pump well, infiltration trench, or tunnel)

2. Location is: 8 miles South of Corvallis
(Approximate distance and direction from nearest city or town)

and is more particularly described as follows:

(a) N 34° W 764.0 ft from NE corner of Sec 1 & 2 T 14 S, R 5 W W. M.
(Give distance and bearing to corner of section or other legal subdivision)

being within SE 1/4 of NE 1/4 of Sec. 2, Twp. 14 S, Rge. 5 W
(Smallest legal subdivision) (N. or S.) (E. or W.)

or (b) within limits of recorded platted property, town or city:

in Lot _____, Block _____ of _____
(Name of plat or addition)

_____ County of _____
(If within city or town, give name)

3. Construction Work was begun on 1953; was completed on 1953
(Date) (Date)

and the ground water claimed was first used for the purposes set out below on 1953
(Date)

since which time the water has been used Continuously
(Continuously or intermittently)

from 1953 to date _____
(Date) (Date)

4. Quantity of water claimed and used is 400 gpm gallons per minute; 163 acre feet per year.

5. Purpose or Purposes for which water is used _____

Irrigation
(Domestic, irrigation, municipal, manufacturing, industrial, etc.)

6. Description of Well: Depth 32 feet. Type drilled
(Dug or drilled)

diameter 10" inches. Elevation of ground at well site 256 feet, mean sea level.
(As near as known)

Depth to water table 10 feet.

7. Capacity of Well: 400 g.p.m. with 10 feet drawdown.

_____ g.p.m. with _____ feet drawdown.

Date of test 1953

If Flowing Well: Measured discharge _____ g.p.m. on _____
(Date)

Shut-in pressure at ground surface _____ lbs. per sq. in. on _____
(Date)

Water is controlled by _____
(Cap. valve, etc.)

Township 14S Range 5W, W.M.
North

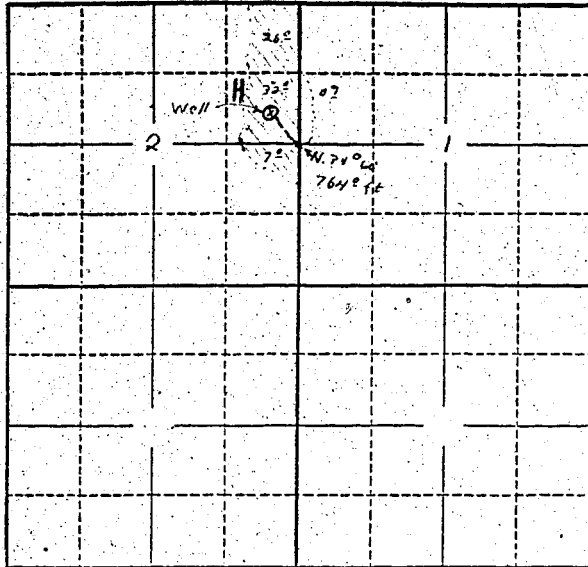

Locate well and acreage of irrigated land on plat.
Scale: 2" = 1 Mile

STATE OF OREGON

County of Benton } ss.

I, J. P. Crist, being first duly sworn, do hereby certify that I have read the foregoing Registration Statement and that all of the items therein contained are true to the best of my knowledge and belief.

J. P. Crist
(Signature of Registrant)

Subscribed and sworn to before me this 5th day of September, 1957.

My commission expires Oct 8, 1960 Sharon C. Fisher
(Notary Public)

(SEAL)

CERTIFICATE OF REGISTRATION

STATE OF OREGON } ss.
County of Marion

This is to certify that the foregoing Registration Statement was received in the office of the State Engineer on the 9th day of July, 1958, at 2:00 o'clock A. M. and has been duly recorded in said office in Book No. 9 of Registration Statements on page GR 1908.

Witness my hand this 9th day of February, 1959.

Laura A. Stanley
(State Engineer)

By _____
(Deputy)

\$ 20.00