

RECEIVED
JUN 10 1958

STATE ENGINEER
SALEM, OREGON

Registration No. GR 1981

Certificate No. GR 1912

Registration Statement

OF CLAIMANT OF RIGHT TO APPROPRIATE GROUND WATER

TO THE STATE ENGINEER OF OREGON:

I, R. C. AND IVA LEONARD
of 123 GARIBALDI HILLSBORO County of WASHINGTON
State of OREGON, do hereby make application for a certificate of registration as evidence
of a right to appropriate ground water.

1. Source from which water is withdrawn is pump well
(Flowing well, pump well, infiltration trench, or tunnel)
2. Location is: Near 1st + Garibaldi St in Hillsboro
(Approximate distance and direction from nearest city or town)

and is more particularly described as follows:

(a) 2350' S & 230' E FROM N.W. COR. SEC. 31
(Give distance and bearing to corner of section or other legal subdivision)
being within SW 1/4 of NW 1/4 of Sec. 31, Twp. 1 N, Rge. 2 W
(Smallest legal subdivision) (N. or S.) (E. or W.)

or (b) within limits of recorded platted property, town or city:
in Lot _____ Block _____ of _____
(Name of plat or addition)

County of _____
(If within city or town, give name)

3. Construction Work was begun on MAY 19 1945; was completed on MAY 22 1945
(Date) (Date)
and the ground water claimed was first used for the purposes set out below on MAY 23 1945
(Date)
since which time the water has been used Intermittently
(Continuously or Intermittently)
from 1945 to 1958
(Date) (Date)

4. Quantity of water claimed and used is 25 gallons per minute; 6 1/4 acre feet per year.

5. Purpose or Purposes for which water is used IRRIGATION

(Domestic, irrigation, municipal, manufacturing, industrial, etc.)

6. Description of Well: Depth 40 feet. Type DRILLED
(Dug or drilled)
diameter 5 inches. Elevation of ground at well site 187 feet, mean sea level.
(As near as known)
Depth to water table 20 feet.

7. Capacity of Well: 25 g.p.m. with 22 feet drawdown.
_____ g.p.m. with _____ feet drawdown.

Date of test NO TEST. OBSERVATION MADE WHILE USING

If Flowing Well: Measured discharge _____ g.p.m. on _____
(Date)

Shut-in pressure at ground surface _____ lbs. per sq. in. on _____
(Date)

Water is controlled by _____
(Cap, valve, etc.)

Township 1N Range 2W W.M.
North

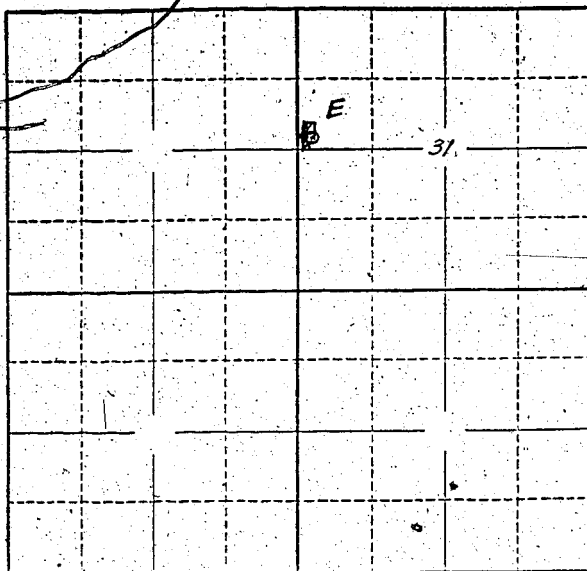

Locate well and acreage of irrigated land on plat.
Scale: 2" = 1 Mile

STATE OF OREGON

County of Marion } ss.

I, _____, being first duly sworn, do hereby certify that I have read the foregoing Registration Statement and that all of the items therein contained are true to the best of my knowledge and belief.

R C Leonard & Iva Leonard
(Signature of Registrant)

Subscribed and sworn to before me this 7th day of July, 1958

My commission expires 12th June 1961 Wm S Bartholomew
(Notary Public)

(SEAL)

CERTIFICATE OF REGISTRATION

STATE OF OREGON

County of Marion } ss.

This is to certify that the foregoing Registration Statement was received in the office of the State Engineer on the 9th day of July, 1958, at _____ o'clock _____ M. and has been duly recorded in said office in Book No. 9 of Registration Statements on page GR-1912

Witness my hand this 9th day of February, 1959

\$15.00

[Signature]
(State Engineer)

By _____
(Deputy)

GR - 1912