

Registration Statement

OF CLAIMANT OF RIGHT TO APPROPRIATE GROUND WATER

TO THE STATE ENGINEER OF OREGON:

I, Charlie W. Reed
of Rt #1 Box 202 McMinville, Ore County of Yamhill
(Mailing address)

State of Oregon, do hereby make application for a certificate of registration as evidence of a right to appropriate ground water.

1. Source from which water is withdrawn is Pump Well
(Flowing well, pump well, infiltration trench, or tunnel)

2. Location is: 1 Mile West of Whiteson, Ore
(Approximate distance and direction from nearest city or town)

and is more particularly described as follows:

(a) S 57° W = 1400' from NE Corner Section 7
(Give distance and bearing to corner of section or other legal subdivision)

being within NE 1/4 NE 1/4 of Sec. 7 Twp. 5 S, Rge. 4 W
(Smallest legal subdivision) (N. or S.) (E. or W.)

or (b) within limits of recorded platted property, town or city:

in Lot _____, Block _____ of _____
(Name of plat or addition)

County of _____
(If within city or town, give name)

3. Construction Work was begun on July 1954, was completed on August 1954
(Date) (Date)

and the ground water claimed was first used for the purposes set out below on August 1954,
(Date)

since which time the water has been used Intermittently
(Continuously or intermittently)

from August 1954 to Oct. 1957
(Date) (Date)

4. Quantity of water claimed and used is 180 gallons per minute; _____ acre feet per year.

5. Purpose or Purposes for which water is used Irrigation

(Domestic, irrigation, municipal, manufacturing, industrial, etc.)

6. Description of Well: Depth 29 feet. Type Drilled Auger
(Dug or drilled)

diameter 16 inches. Elevation of ground at well site _____ feet, mean sea level,
(As near as known)

Depth to water table 27 3 feet.

7. Capacity of Well: No Test g.p.m. with _____ feet drawdown.

_____ g.p.m. with _____ feet drawdown.

Date of test August 1954

If Flowing Well: Measured discharge _____ g.p.m. on _____
(Date)

Shut-in pressure at ground surface _____ lbs. per sq. in. on _____
(Date)

Water is controlled by _____
(Cap, valve, etc.)

8. Casing: (Give diameter, commercial specifications and depth below ground surface of each casing size.)

16 inch diameter Concrete Tile from 0 to 29 feet
inch diameter from to feet
inch diameter from to feet
inch diameter from to feet

Describe and show depth of shoe, plug, adapter, liner or other details:

9. Perforated Casings or Screens:

Tile Joints from to
(Number per foot and size of perforations, or describe screen)
from to
from to
from to

10. Log of Well: (Describe each stratum or formation clearly, indicate if water bearing, and give thickness and depth as indicated.)

MATERIAL	Thickness (Feet)	Depth to Bottom (Feet)
Top Soil	5	
Blue Clay	16	21
Sand & Gravel	8	29

If log of well is not available, give name and address of driller.....

11. Infiltration Trench: Covered or open.....

Dimensions: Length..... ft. Minimum depth..... ft. Maximum depth..... ft.

Bottom width..... ft. Discharge..... g.p.m. Date of test.....

12. Tunnel: Type of lining.....

Dimensions:.....
(Length, course, and cross sectional size)

Position of water bearing stratum with reference to portal of tunnel.....

Log of tunnel: (Preceding table for log of well may be used, if desired. Give footage from portal and character of materials, as pertinent.)

13. Pumping Equipment:

(a) Pump *Starline - Centrifugal - 2 1/2* Capacity *180* g.p.m.
(Make, type and size)

(b) Motor *Electric - 15 HP*
(Type and horsepower)

14. Location of area irrigated or to be irrigated, or place of use if for purposes other than irrigation.

Township North or South	Range E. or W. of Willamette Meridian	Section	Forty-acre Tract	Number Acres To Be Irrigated	Date of Reclamation
5S	4W	7	NE 1/4 NE 1/4	6	1954
"	"	7	SE 1/4 NE 1/4	35	"
"	"	7	SW 1/4 NE 1/4	2	"
"	"	7	NE 1/4 SE 1/4	14	"
"	"	7	NW 1/4 SE 1/4	2	"
				Total 59.00	

15. If the ground water supply is supplemental to an existing water supply, identification of any application for a permit, permit, certificate or adjudicated right to appropriate water made or held by the registrant.

None

Township 5 S Range 4 W W.M.
North

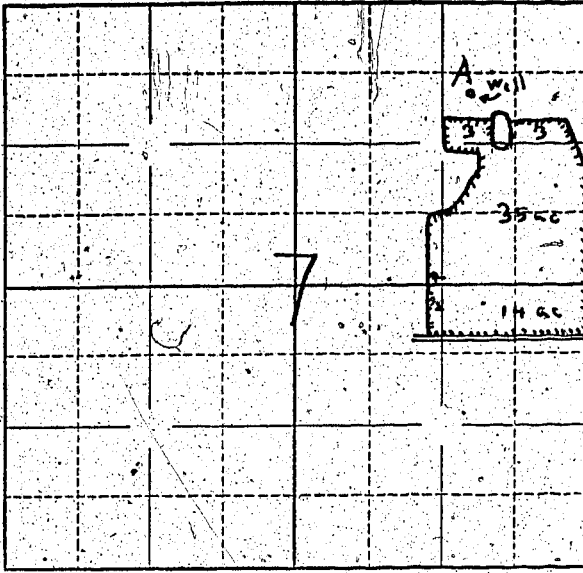

Locate well and acreage of irrigated land on plat.

Scale: $\frac{1}{2}$ - 1 Mile

STATE OF OREGON

County of Marion } ss.

I, Charlie W. Reed being first duly sworn, do hereby certify that I have read the foregoing Registration Statement and that all of the items therein contained are true to the best of my knowledge and belief.

Charlie W. Reed
(Signature of Registrant)

Subscribed and sworn to before me this 10th day of July 1958

My commission expires 12th June 1961 Wm. S. Bartholomew
(Notary Public)

(SEAL)

CERTIFICATE OF REGISTRATION

STATE OF OREGON

County of Marion } ss.

This is to certify that the foregoing Registration Statement was received in the office of the State Engineer on the 10th day of July, 1958, at 11:00 o'clock A. M. and has been duly recorded in said office in Book No. 9 of Registration Statements on page GR-1930

Witness my hand this 9th day of February, 1959

Lewis A. Stanley
(State Engineer)

\$19.55

By _____
(Deputy)