

Registration Statement

OF CLAIMANT OF RIGHT TO APPROPRIATE GROUND WATER

TO THE STATE ENGINEER OF OREGON:

I, The Pacific Telephone & Telegraph Company
of 509 S. W. Oak Street, Portland 4 County of Multnomah
(Mailing address)

State of Oregon do hereby make application for a certificate of registration as evidence of a right to appropriate ground water.

1. Source from which water is withdrawn is Pump Well #1
(Flowing well, pump well, infiltration trench, or tunnel)

2. Location is: 819 S. W. Oak Street, Portland, Oregon
(Approximate distance and direction from nearest city or town)

and is more particularly described as follows:

(a) Approx. 1000 feet North & 600 feet east from S.W. corner Section 34
(Give distance and bearing to corner of section or other legal subdivision)
being within SW 1/4 of SW 1/4 of Sec. 34, Twp. 1N, Rge. 1E
(Smallest legal subdivision) (N. or S.) (E. or W.)

or (b) within limits of recorded platted property, town or city: Portland, Oregon
in Lot 1, Block 86 of See Attachment
(Name of plat or addition)

County of Clatsop
(If within city or town, give name)

3. Construction Work was begun on June 2, 1950; was completed on 12-29-1950
(Date) (Date)
and the ground water claimed was first used for the purposes set out below on 3-1-1951
(Date)

since which time the water has been used Intermittently
(Continuously or intermittently)
from 3-1-1951 to Present
(Date) (Date)

4. Quantity of water claimed and used is 350 gallons per minute; - acre feet per year.

5. Purpose or Purposes for which water is used Air Conditioning

6. Description of Well: Depth 690 feet. Type Drilled
(Domestic, irrigation, municipal, manufacturing, industrial, etc.) (Dug or drilled)
diameter 14 inches. Elevation of ground at well site 39.54 feet, mean sea level.
(As near as known)
Depth to water table 31 feet.

7. Capacity of Well: 250 g.p.m. with 78 feet drawdown.
375 g.p.m. with 134 feet drawdown.

Date of test 12-29-1950

If Flowing Well: Measured discharge - g.p.m. on - (Date)

Shut-in pressure at ground surface - lbs. per sq. in. on - (Date)

Water is controlled by -
(Cap, valve, etc.)

Township 1N Range 1E W.M.
North

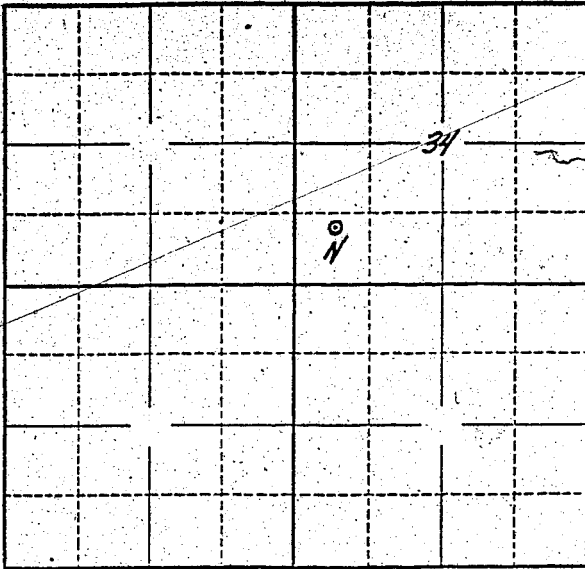

Locate well and acreage of irrigated land on plat.
Scale: 2" = 1 Mile

STATE OF OREGON }
County of Multnomah } ss.

I, L. F. Booth - Supt. of Bldgs., being first duly sworn, do hereby certify that I have read the foregoing Registration Statement and that all of the items therein contained are true to the best of my knowledge and belief.

L. F. Booth
(Signature of Registrant)

Subscribed and sworn to before me this 7th day of July, 19 58

My commission expires July 31, 1961

Thomas R. Fyock
(Notary Public)

(SEAL)

CERTIFICATE OF REGISTRATION

STATE OF OREGON }
County of Marion } ss.

This is to certify that the foregoing Registration Statement was received in the office of the State Engineer on the 10th day of July, 19 58, at 1:00 o'clock P. M. and has been duly recorded in said office in Book No. 9 of Registration Statements on page GR-1881

Witness my hand this 26th day of January, 19 59

Lewis A. Stanley
(State Engineer)

\$20.00

By _____ (Deputy)

GR-1881